

Annual report and list of subscribers : 1928 / Jenny Lind Hospital for Children.

Contributors

Jenny Lind Hospital for Children. no2006008734

Publication/Creation

[Norwich?] : [publisher not identified], 1928

Persistent URL

<https://wellcomecollection.org/works/qtkmj4sz>

License and attribution

This work has been identified as being free of known restrictions under copyright law, including all related and neighbouring rights and is being made available under the Creative Commons, Public Domain Mark.

You can copy, modify, distribute and perform the work, even for commercial purposes, without asking permission.



Wellcome Collection
183 Euston Road
London NW1 2BE UK
T +44 (0)20 7611 8722
E library@wellcomecollection.org
<https://wellcomecollection.org>

Norfolk



JENNY LIND
HOSPITAL
for
CHILDREN



ANNUAL REPORT
AND LIST OF SUBSCRIBERS
1928

WELLCOME
LIBRARY
Am. P.
WS28
.BC5
J51
1928



Digitized by the Internet Archive
in 2019 with funding from
Wellcome Library

<https://archive.org/details/b31704906>

JENNY LIND HOSPITAL FOR CHILDREN

ESTABLISHED 1853

Erected 1900.

Opened by H.M. King Edward VII. when Prince of Wales.



Photograph by Coe & Son, London St., Norwich, shewing Verandahs and Stuart Ward added since 1914 to cope with large increase in number of patients

The Hospital was originally built for 40 beds — there are now available 80 beds

JENNY LIND HOSPITAL *for* CHILDREN

UNTHANK ROAD, NORWICH

Out-Patient Department—POTTERGATE STREET

ESTABLISHED MAY 30TH, 1853.

Patronesses.

HER MAJESTY QUEEN MARY.
THE DOWAGER COUNTESS OF LEICESTER.
THE COUNTESS OF LEICESTER.

Patron.

THE RT. HON. THE EARL OF LEICESTER, G.C.V.O., C.M.G.
(LORD LIEUTENANT.)

President.

THE LORD MAYOR OF NORWICH.

Vice-President.

THE DOWAGER LADY SUFFIELD.

Trustees.

RUSSELL J. COLMAN, ESQ. F. W. COOKE, ESQ.

Hon. Treasurer.

EDWARD G. BUXTON, ESQ.

Matron.

MISS FLORENCE K. PRATT.

Sister in Charge of Out-Patient Department & Assistant Matron.

MISS D. BURSON.

Hon. Secretary.

H. HARPER SMITH, ESQ., F.S.A.A., F.C.I.S.

JENNY LIND HOSPITAL

COMMITTEE OF MANAGEMENT, 1929.

Chairman.

G. E. W. WOOLSEY, ESQ.

Vice-Chairman.

F. C. HINDE, ESQ.

Members Retiring 1930.

DR. E. E. BLYTH
MISS ANNIE FOX

MISS HELEN COLMAN
W. P. FURBANK, ESQ.

MISS ENID COOKE.
A. W. PRESTON, ESQ.

Members Retiring 1931.

C. R. BIGNOLD, ESQ.
LADY MORSE

C. R. A. HAMMOND, ESQ.
MRS. WEBSTER

HENRY N. HOLMES, ESQ.
MISS WISE

Members Retiring 1932.

MRS. COLLINSON
F. C. HINDE, ESQ.

COL. S. GARERD HILL
MRS. W. H. SCOTT

J. HOWLINGS, ESQ.
G. E. W. WOOLSEY, ESQ.

The County Director of the British Red Cross Society and the Order of
St. John of Jerusalem in England.

MRS. HARKER.

Representatives of the Norwich Hospitals and Medical Institutions
Sunday and Saturday Fund.

MESSRS. A. PAYNE, and E. J. HAYWARD.

Representative of the Elementary Teachers of Norwich
Schools.

P. LOOKER, ESQ.

HONORARY MEDICAL OFFICERS.

Consulting Surgeons.

H. S. ROBINSON, Esq., M.R.C.S.

C. J. MURIEL, Esq., M.R.C.S.

HERBERT CROSSE, Esq., M.D.

Physicians.

SYDNEY H. LONG, Esq., M.D.

BASIL K. NUTMAN, Esq., M.D., M.A.

Surgeons.

MICHAEL BULMAN, Esq., M.D., M.S., F.R.C.S.

N. STUART CARRUTHERS, Esq., F.R.C.S., Edin., M.R.C.S., Edin., L.R.C.P.

Assistant Physician.

BRANFORD MORGAN, Esq., M.D. Edin., M.R.C.P., Lon.

Assistant Surgeon.

GEORGE DAY, Esq., M.B., B.S., M.R.C.S., L.R.C.P.

Anæsthetist.

BRANFORD MORGAN, Esq., M.D., Edin., M.R.C.P. Lon.

Ophthalmic Surgeon.

GEORGE MAXTED, Esq., M.D., F.R.C.S.

Pathologist.

G. P. C. CLARIDGE, Esq., M.B., B.S.

Radiologist.

J. S. LEVACK, Esq., M.B., Ch.B., D.M.R.E.

Surgeon Dentist.

C. BRADLEY-WATSON, Esq., L.D.S.

Resident Medical Officer.

E. GORDON LAURENCE, Esq., M.R.C.S., L.R.C.P.

JENNY LIND HOSPITAL

Bankers.

MESSRS. BARCLAYS BANK LTD., Bank Plain, Norwich.

Architects.

MESSRS. E. T. BOARDMAN & SON, Queen Street, Norwich.

Dispenser.

MR. C. W. HIPPERSON.

Almoner.

MISS KATHLEEN BLANDEN.

HOUSE COMMITTEE

G. E. W. WOOLSEY, Esq. (Chairman).

F. C. HINDE, Esq.	MISS A. FOX	MRS. COLLINSON
MISS E. COOKE	MRS. SCOTT	MISS WISE
MRS. WEBSTER	J. HOWLINGS, Esq.	1 MEMBER OF THE HON. MEDICAL STAFF

FINANCE COMMITTEE.

G. E. W. WOOLSEY, Esq. (Chairman).

H. N. HOLMES, Esq. COL. S. GARERD HILL F. C. HINDE, Esq.
C. R. A. HAMMOND, Esq. H. HARPER SMITH, Esq.

ELECTION COMMITTEE.

Elected by Governors

COMMITTEE OF MANAGEMENT. TRUSTEES. CONSULTING STAFF.
TWO PHYSICIANS. TWO SURGEONS. TREASURER. HON. SECRETARY.

AND 8 ELECTED BY GOVERNORS, VIZ. :—

THE DOWAGER LADY SUFFIELD.	THE REV. CANON J. ALLEN BELL.
LIEUT.-COL. GRANVILLE DUFF.	MRS. F. R. EATON.
J. A. CHRISTIE, Esq., M.P.	G. F. BUXTON, Esq.
EDMUND REEVE, Esq.	MRS. CYRIL WAITER.

ANNUAL REPORT 1928

All communications should be addressed as follows:—

Relating to Finance—

MR. H. HARPER SMITH,

30, London Street.

Norwich.

Telephone No. 603.

Relating to Domestic and Nursing Arrangements—

THE LADY SUPERINTENDENT,

JENNY LIND HOSPITAL,

Unthank Road, Norwich.

Telephone No. 209.

Relating to In-Patients—

THE RESIDENT MEDICAL OFFICER,

JENNY LIND HOSPITAL,

Unthank Road, Norwich.

Telephone No. 209.

Relating to Out-Patients—

SISTER IN CHARGE,

Jenny Lind Out-Patient Department,

Pottergate Street, Norwich.

Telephone No. 418.

ALMONING OFFICE.

Telephone No. 2287.

Information as to the Admission of Patients.

THE JENNY LIND HOSPITAL FOR CHILDREN.

Parents are asked to contribute a small amount towards the cost of treatment, unless they have provided for this through one of the contributory funds.

IN-PATIENTS.

No child can be admitted without the recommendation of a Subscriber, **except in cases of accident or great urgency, when the patient is admitted without delay.**

Children eligible for admission as in-patients are boys from two to ten years, and girls from two to twelve years of age, **not suffering from an infectious or contagious disease.** A limited number of children under the age of two years are admitted at the discretion of the Committee of Management.

All patients are discharged at the expiration of two months, unless the Medical Officer is of opinion that further treatment is requisite, in which case a fresh recommendation must be obtained at the expiration of the first two months and every two succeeding months.

TIME OF ADMISSION :—Daily, before 11 a.m., except Sunday.

VISITING HOURS :—Saturdays, from Two-thirty to Three o'clock in the Afternoon, but owing to risk of infection, Visitors are not to be allowed inside the Wards except under special circumstances.

OUT-PATIENTS.

Children of both sexes, up to the age of twelve years, are treated as out-patients, without recommendation.

TIME OF ADMISSION :—At 9.30 a.m., every Tuesday, Wednesday, Thursday, and Saturday.

PRIVILEGES OF GOVERNORS AND SUBSCRIBERS

— — —

Governors (i.e., Subscribers of £1 1s. at least annually) and Subscribers are each year entitled to In-door Recommendations for patients according to the following scale :—

1. Annual Subscribers for each £1 1s. may recommend One In-patient.
2. The representatives of organised Collections and Friendly Societies for each £1 1s. may recommend One In-patient.
3. For each Church or Chapel Collection the Clergyman, Minister or representative for each £1 1s. may recommend (within a year after payment) One In-patient.
4. The Norwich Hospitals and Medical Institutions Sunday and Saturday Fund Committee for each £1 1s. may recommend One In-patient.
5. Benefactors of not less than 20 Guineas may recommend One In-patient annually.

No individual Governor is entitled to have more than two patients in the Hospital at one time.

All Subscriptions are due on the 1st of January in each year, and no Governor or Subscriber whose subscription is six months in arrear is entitled to exercise any privilege in connection with the Hospital. No new Subscriber has the right to vote at a Board meeting unless his or her subscription shall have been paid three months previously, but Life Governors are at once entitled to every privilege of the Hospital.

76th ANNUAL REPORT

OF THE

COMMITTEE OF MANAGEMENT.

THE Committee of Management have pleasure in presenting the (76th) Annual Report for the year 1928.

The following table shows the number of admissions and averages as compared with the two previous years :—

IN-PATIENT DEPARTMENT.	1928	1927	1926
In-Patients admitted during the year..	1659	1283	1324
Daily average number of beds occupied ..	60	53.5	49
Number of Operations in Hospital ..	1272	823	775
Accidents, Casualties, and Dressings ..	1308	1094	1562

(Note : Colman Ward closed for 1 week. Gannon Ward closed for 1 week.)

OUT-PATIENT DEPARTMENT.

Number of Patients applying for treatment in Out-Patient Department ..	2797	2949	2829
Number of attendances during year ..	11728	12257	11998
Average Attendance per working day	38	40	39
Small Operations at Out-Patient Department	24	30	26

EAR, NOSE, AND THROAT CLINIC.

1072 attendances as compared with 787 in 1927.

X-RAY & ELECTRO-THERAPEUTIC DEPARTMENT.

266 cases requiring X-Ray examination as compared with 260 last year.

4248 Ultra-Violet Light treatments against 1230 in 1927.

PATHOLOGICAL INVESTIGATIONS.

145 cases as compared with 117 in 1927.

TONSILS AND ADENOID CASES.

The number of cases admitted, by arrangement with the Education Committees of the Norwich City Council and the Norfolk County Council during the year for operations for the removal of Tonsils and Adenoids were :—

City Cases	162	County Cases	85
------------	-----	--------------	----

ORTHOPAEDICS.

The arrangement with the Norfolk County Council for the treatment of Orthopaedic conditions of infancy and childhood continues and numerous cases of this type have been dealt with both as In-Patients and Out-Patients during the year.

ALMONING DEPARTMENT.

IN-PATIENTS.	1928	1927
Total number of patients admitted during the year ..	1659	1283
Number admitted under Contributory Scheme	1029 or 62%	781 or 62.9%
Number paid for by Outside Authorities	276 or 16.6%	156 or 12.5%
Number whose parents contribute towards cost of treatment	194 or 11.6%	170 or 13.7%
Number given free treatment..	160 or 9.6%	133 or 10.6%

OUT-PATIENTS (X-Ray, Sunlight and Massage).

Total Number of new cases ..	133	166
Number treated under Contributory Scheme	92 or 69.1%	104 or 62.2%
Number paid for by Outside Authorities	1 or .7%	3 or 1.8%
Number whose parents contributed towards cost of treatment	35 or 26.3%	27 or 16.2%
Number given free treatment..	5 or 3.7%	32 or 19.2%
Number of interviews given = 2075.		

FINANCE.

The Income for the year amounted to £7,865 4s. 4d., as compared with £7,902 16s. 8d. in 1927, whereas the expenditure for 1928 was £7,590 3s. 0d., compared with £8,185 0s. 3d. for 1927, showing a balance of income over expenditure of £275 1s. 4d.

It is gratifying to know that the Annual Subscriptions have increased by £93 5s. 1d., although a large number of Subscribers have died during the year.

£228 was received for the support of Cots.

The average daily cost per patient was 6/9, and the average stay of each child in Hospital was nine days and excluding cases of Tonsils and Adenoids was 18½ days.

JENNY LIND HOSPITAL

The Norwich Hospitals and Medical Institutions Sunday and Saturday Fund, by their excellent Contributory Scheme, has again exceeded all records in providing £3,480 or £84 more than last year.

A Legacy was received during the year under the Will of the late Mr. J. B. Forrester, amounting to £100.

A list of friends who have remembered the Hospital in their distribution of Clothing, Linen, Toys, Fruit, etc., is given on page 53. Gifts of this kind are welcomed by the Matron, who can always find use for the smallest contribution.

A list of special donations received during the year in connection with the Building Fund appears on page 33.

The Committee of Management is very grateful for the interest and financial support received. Special efforts to help the Hospital Funds have again been numerous and are specifically mentioned on page 34.

THE LATE MR. J. B. FORRESTER.

Your Committee have been unfortunate in losing one of its oldest members, Mr. J. B. Forrester, who died on 7th July.

Mr. Forrester had been connected with the Committee of Management for a long period of years, lately as Trustee, and was Chairman from 1909 to 1911. He had recently subscribed £500 for a Cot in his Sister's name—"The Ann Forrester" Cot.

DEATH OF OLD FRIENDS AND SUBSCRIBERS.

Your Committee very much regrets to record the death of the following friends and subscribers :—

Mrs. C. R. Ayton, Sir George Chamberlin, Mr. W. Warner Cook, Mrs. Cracknell, Miss Dowson, Mr. J. B. Forrester, Miss E. R. Gray, Mr. George Green, Miss R. Gurney, Miss Lucy Hansell, Miss M. A. Martin, Mrs. C. E. Noverre, Mrs. C. H. Pitt, Miss M. F. Patteson, Mr. E. P. Simpson, Mr. Charles Thurston.

HONORARY LIFE GOVERNORSHIPS.

In consideration of the special services rendered to the Hospital during their year of office, the Lord Mayor and Lady Mayoress (Mr. and Mrs. H. E. Witard) were appointed Honorary Life Governors under Law 7.

Mrs. Calver and Mrs. Hennessey were elected Honorary Life Governors on the nomination of the L. & N.E.R. (Norwich District) Hospital Fund.

Mrs. F. G. L. Moore, Miss Southall, and Mrs. White were also elected Honorary Life Governors on the nomination of the Alexandra Rose Day Committee.

Mr. Arthur Blanden was appointed as Honorary Life Governor in recognition of his services as Honorary Secretary of the Alexandra Rose Day Committee for the past six years.

RESIGNATION OF DR. BURTON MARSHALL.

The resignation of Dr. Burton Marshall, Honorary Physician was accepted with great regret and Dr. B. K. Nutman, the Senior Assistant Physician, was appointed to take his place.

NORWICH EGG WEEK.

Norwich Egg Week, organised by Mr. F. B. Seago, has again resulted in this Hospital receiving 20,000 eggs. Your Committee desire to express their great appreciation to Mr. Seago for his untiring efforts in this connection.

COTS.

No new Cots have been founded this year, but Cots still provided for are enumerated in the Income Account on page 20.

VISIT OF H.R.H. THE PRINCE OF WALES.

The Hospital was honoured by a visit of His Royal Highness The Prince of Wales on May 30th, who made a tour of inspection of all Wards, expressed his appreciation and signed the Visitors' Book.

STONE-LAYING CEREMONY, NEW OUT-PATIENT AND SPECIAL DEPARTMENTS BLOCK.

On July 2nd, the Foundation Stone of the new Out-Patient Department was laid by Mrs. Raymond Maude, O.B.E., daughter of "Jenny Lind," who was accompanied by her son, Mr. Charles R. Maude. The ceremony of dedication was performed by the Lord Bishop of Norwich.

PYM HOUSE (NURSES' HOSTEL).

This Hostel was declared open by Mrs. Raymond Maude on July 2nd. The comfort and quiet is much appreciated by the Nurses.

GIFTS.

Two dining room chairs, forming formerly part of a suite belonging to Jenny Lind, have been presented to the Hospital by Mr. H. E. Stringer, of Sheringham.

A letter, a very interesting Memento of Jenny Lind, was received from Mrs. Raymond Maude, as a gift to the Jenny Lind Hospital. The letter is from Bishop Stanley, of Norwich, to Jenny Lind, and is dated 10th July, 1847, and it was asking her to stay at the Palace when she came to sing at Norwich that year.

LADIES' WORK ASSOCIATION.

The Annual Presentation of Linen was made on October 10th by Miss Southall, sister of the Sheriff, in the Eaton Parish Hall. This Association has again made a splendid contribution of linen and garments and very grateful thanks are due to Mrs. Harker (President), Miss Muriel (Treasurer), Mrs. R. W. Collinson (Honorary Secretary) and the Vice-Presidents and Members who devote so much time and thought all the year to provide the work.

The total number of garments presented was 1274, made up as follows :—Ladies' Work Association, 897 ; Norfolk and South Walsham District Division of Red Cross, 236 ; Red Cross (County), 40 ; Drayton Working Party, 101.

In addition to this, Mrs. Bullard's Working Party at Wroxham presented 706 articles of clothing. Materials have

been made up by Working Parties at Cley, Aldborough, Kirby Bedon and the Reepham Red Cross Society, the Whissonsett Mothers' Union and the Women's Institutes at Brundall, Barningham, Holkham, and Krapton.

TINFOIL.

This Hospital is now in a position to appeal for Tinfoil and it is hoped that in due time sufficient money will be obtained from this source to endow a Cot. By this means a very great deal of money has been received by various Hospitals and it is hoped that all friends will encourage children to save and collect so that the proceeds of the sale may be put towards the endowment of a Cot. The class of material which is suitable is :—Tobacco wrappings (free from paper), Foil from cigarettes and chocolates, metal capsules, lead soldiers, or any piece of broken lead.

This should be sent to the Almoning Office at the Hospital, or, on receipt of a post card, arrangements will be made for collection.

SUBSCRIPTIONS.

The Honorary Secretary has this year made a personal appeal for new Subscribers, which has resulted in obtaining 52 new Subscribers and a total additional income of £87 15s. 0d. In this he was helped by a gentleman in the County offering an annual subscription of Twenty Guineas if twenty new annual subscribers of £1 1s. 0d. each could be obtained before the end of the year.

Your Committee feel that they owe a further debt of gratitude to Mr. Harper Smith for this additional service he has rendered to the Hospital.

ACKNOWLEDGMENT.

Your Committee cannot conclude this report without mention of the services rendered by the Hospital Staff. The Honorary Medical Staff, the Lady Superintendent, the Sisters, Nurses, and Domestic Staff, have all through the year given devoted service and the Committee on behalf of the public generally tenders them grateful thanks for work un-

JENNY LIND HOSPITAL

grudgingly done. The Committee also desires to acknowledge the services rendered by the Honorary Secretary for his devoted work, and to Messrs. Bullimore & Co., the Honorary Auditors.

The Committee of Management desires, in its concluding paragraph, to express its deep and sincere gratitude to all contributors to its funds, for the generous help which it has received in the past year. The support received has been a great encouragement and it is hereby most warmly acknowledged.

Signed on behalf of the Committee of Management,

G. E. W. WOOLSEY,
Chairman.

Medical Officers' Report

In nearly every Department of the Hospital the work done in 1928 shows a considerable increase over that of the previous year, as the figures accompanying this report testify. The total number of beds, including 12 set aside for tonsils and adenoid cases and 6 in the two Observation wards, is 80, and the average daily occupation throughout the year was 60. On several occasions every bed and cot was occupied. It was only possible to maintain this high average by the exclusion of infectious diseases, which are filtered by the Observation Wards, but in spite of these precautions infection will occasionally gain entry into the general wards, each of which had to be closed for one week on this account during last year.

The drop from sixteen-and-a-half days to nine days as the average duration of stay of each In-Patient is explained by the large increase in the number of children admitted for throat operations, an increase of 379 over that of the previous year. These children stay for one or two nights only.

The number of treatments given in the Artificial Sunlight and Massage and Electrical Departments shews an increase of over 4,000, and at the Ear, Nose, and Throat Clinic there was an increase of nearly 300 attendances.

With the increase in the population in the vicinity of the Hospital the number of cases treated in the Casualty Department is increasing yearly, which all points to the need for the increased accommodation which will be provided in the nearly completed new Out-Patient and Special Departments Block. Provision has been made in this Block for these various special departments.

	1928.		1927.
Number of In-Patients	1659	as compared with	1283
Average Number of Beds occupied	60	" " "	53.5
Number of Operations	1272	" " "	823
Average duration of Stay	18½	" " "	16½
(excluding Tonsil and Adenoid cases)			

OUT-PATIENTS DEPARTMENT :—

New Patients treated	2797	as compared with	2949
Total number of Attendances ..	11728	" " "	12257

JENNY LIND HOSPITAL

SPECIAL DEPARTMENTS.

	1928.		1927.
Ultra-Violet Light treatments ..	4248 (182 patients) as compared with 1230 treatments		
Massage and/or Electrical Treatments ..	3977 (159)	,,)	,, 2629
X-Ray Cases ..	266	,,	,, 260
Pathological Investigations	145	,,	,, 117
Orthopaedic Clinic	445	,,	,, 791
Ear, Nose, and Throat Clinic	1072	,,	,, 787
Medical after Treatment Clinic	88	,,	,, 48
Dressings, Casualties attended in Casualty Room	1308	,,	,, 1094

SUMMARY OF PATIENTS ADMITTED TO HOSPITAL.

Cured ..	1418
Improved ..	103
In statu quo ..	25
Died ..	30
Discharged for special reasons ..	29
Remaining in Hospital 31st December, 1928 ..	54
	1659

SYDNEY H. LONG	}	Physicians.
B. K. NUTMAN		
MICHAEL BULMAN	}	Surgeons.
N. STUART CARRUTHERS		
BRANFORD MORGAN, Assistant Physician.		
GEORGE DAY, Assistant Surgeon.		

ANNUAL REPORT 1928

Analysis of Surgical Cases in 1928

Disease.	Total	Cured	Improved	In statu quo	Discharged for special reasons	Died	In Hospital 1st Jan., 1929
Abscesses	45	40	2	—	—	—	3
Adenitis	12	11	—	—	—	—	1
Appendicitis	3	2	—	—	1	—	—
Burns and Scalds	17	13	1	—	3	—	—
Congenital Hypertrophy of Pylorus	6	5	—	—	—	1	—
Diseases of Bones and Joints	2	2	—	—	—	—	—
Fractures and Dislocations	29	21	3	—	—	1	4
Genu Valgum and Varum	8	4	2	—	—	—	2
Harelip and Cleft Palate	3	2	—	—	—	1	—
Hernia	45	41	—	—	—	1	3
Hydrocele	3	3	—	—	—	—	—
Injuries	40	37	—	—	—	—	3
Intussusception	3	2	—	—	—	1	—
Mastoiditis	24	17	—	—	3	—	4
Naevus	9	6	3	—	—	—	—
Otitis Media	8	5	3	—	—	—	—
Pes Cavus	2	2	—	—	—	—	—
Phimosis	99	99	—	—	—	—	—
Talipes	15	6	8	—	—	—	1
Tonsils and Adenoids	848	845	—	—	—	—	1
Tuberculosis of :— ..					2		
(a) Bone	16	—	10	1	—	—	5
(b) Glands	8	5	2	—	—	—	1
Miscellaneous	43	29	7	7	—	—	—
TOTAL	1288	1197	41	8	9	5	28

JENNY LIND HOSPITAL

Analysis of Medical Cases in 1928

Disease.	Total	Cured	Improved	In statu quo	Discharged for special reasons	Died	In Hospital, 1st Jan., 1929
Acidosis	3	3	—	—	—	—	—
Acute Infections	16	—	—	—	15	—	1
Asthma	4	1	2	1	—	—	—
Acute Rheumatism	9	7	1	—	—	1	—
Bronciectasis	4	—	3	—	—	1	—
Bronchitis	36	32	—	—	—	2	2
Catarrhal Jaundice	8	8	—	—	—	—	—
Chorea	14	8	—	5	—	—	1
Constipation	12	12	—	—	—	—	—
Debility	16	10	3	—	1	—	2
Dermatitis & Eczema	19	15	—	—	1	—	3
Eneuresis	2	—	2	—	—	—	—
Enteric and Paratyphoid Fever	1	1	—	—	—	—	—
Epilepsy	3	—	2	1	—	—	—
Gastro-Enteritis	34	29	2	—	3	—	—
Lymphatic Leukaemia	1	—	—	—	—	1	—
Marasmus	17	13	—	—	—	1	3
Meningitis Post. Basic	6	—	2	—	—	4	—
Nephritis	13	10	2	—	—	—	1
Pneumonia Broncho and Lobar	42	28	—	—	—	8	6
Purpura	3	3	—	—	—	—	—
Rickets	19	8	8	—	—	1	2
Tonsillitis	5	5	—	—	—	—	—
Tuberculosis of							
(a) Peritoneum	5	—	2	1	—	—	2
(b) Meninges	6	—	—	—	—	6	—
Worms	5	3	1	1	—	—	—
Miscellaneous	68	25	32	8	—	—	3
 Total	 371	 221	 62	 17	 20	 25	 26

ANNUAL REPORT 1928

THEATRE OPERATIONS FOR 1928.

Abscesses Opened	67
Appendicectomy	10
Amputation	4
Circumcisions	92
Dental Extractions	10
Electrolysis of Naevus	32
Empyema	2
Glands of Neck	6
Herniotomy	38
Laparotomy	2
Lengthening of Tendons	5
Mastoidectomy	27
Osteotomy	14
Plasters	34
Ramstedt	2
Tenotomy	20
Tonsils and Adenoids	839
Miscellaneous	68
	<hr/>
	1272
	<hr/>

JENNY LIND HOSPITAL

Income & Expenditure Account for

INCOME.

ORDINARY—

ANNUAL SUBSCRIPTIONS	£	s.	d.	£	s.	d.
(see page 38)	1294	2	0			
Ditto in support of High School Cot	60	0	0			
Sunday School Union Cot ..	30	0	0			
Municipal Secondary School Thanks- giving Memorial Cot	50	0	0			
Norwich Church Sunday Schools Association Cot	38	0	0			
In memory of "Wm. Oldfield Snelling, J.P." Cot	30	0	0			
Prudential Assurance Co. towards Upkeep of Cot	20	0	0			
				1522	2	0
DONATIONS	548	14	2			
Boxes (including Hospital and Out- Patient Boxes)	65	0	10			
				613	15	0
NORWICH EDUCATION COMMITTEE	353	18	6			
Less due to Hon. Medical Staff ..	276	18	9			
				76	19	9
NORFOLK EDUCATION COMMITTEE, Tonsil and Adenoid Cases	117	2	6			
Less due to Hon. Medical Staff ..	76	13	0			
				40	9	6
DITTO, Orthopaedic Cases	547	6	3			
Less due to Hon. Medical Staff ..	85	8	7			
				461	17	8
NORFOLK COUNTY COUNCIL						
Maintenance Cases				257	10	6
CONGREGATIONAL COLLEC- TIONS, &c., apart from Hospital Sunday Fund				75	3	9
NORWICH HOSPITALS AND MEDICAL INSTITUTIONS SUNDAY AND SATURDAY FUND				3480	0	0
ALEXANDRA ROSE DAY— Share of Proceeds				81	11	2
ORDINARY INCOME carried forward				£6609	9	4

the Year ending December 31st, 1928

EXPENDITURE

MAINTENANCE—	£	s.	d.	£	s.	d.
PROVISIONS :				1314	3	7
SURGERY AND DISPENSARY :						
Drugs, Chemicals, Disinfectants, &c.	371	5	9			
Dressings, Bandages, &c.	129	13	8			
Instruments and Appliances	368	16	8			
X-Ray Plates, &c.	42	7	6			
Sundries	6	8	7			
				918	12	2
DOMESTIC :						
Renewals and Repairs	235	1	0			
Washing done off Hospital Premises	456	11	9			
Cleaning and Chandlery	113	2	2			
Water	76	12	6			
Fuel and Lighting—						
(a) Coal	464	14	9			
(b) Gas	266	7	1			
(c) Electric Current	163	18	0			
(d) Oil, Wood, &c.	0	16	0			
Uniforms, Nurses	34	6	5			
Sundries						
				1811	9	8
ESTABLISHMENT :						
Insurance	38	14	5			
Renewals and Repairs	203	14	4			
Garden	333	14	11			
				576	3	8
SALARIES, WAGES, &c. :						
Medical	205	2	2			
Radiography and Electrical Massage	6	6	0			
Nursing	1105	10	9			
Out-patient Department	185	16	4			
Domestic Servants	643	3	4			
Probationers' Fees Returned	25	0	0			
Almoning Office	103	8	9			
				2274	7	4

Carried forward .. 6894 16 5

JENNY LIND HOSPITAL

Income and Expenditure Account for

INCOME.

	£	s.	d.	£	s.	d.
Ordinary Income brought forward				6609	9	4
INVESTED PROPERTY:						
Dividends	726	9	11			
Rents	5	13	0			
Income Tax Returned	97	5	2			
Deposit Interest	22	18	7			
				852	6	8
NURSES AND PROBATIONERS' FEES						
				35	0	0
PATIENTS' PAYMENTS:						
Almoning Department	255	11	6			
In-Patients' Payments for washing	112	16	10			
				368	8	4

£7865 4 4

ANNUAL REPORT 1928

the year ending December, 1928.

EXPENDITURE.

			£	s.	d.	£	s.	d.
Brought forward				6894	16	5
MISCELLANEOUS :								
Printing and Stationery	60	13	3			
Postage	21	12	0			
Telephone	41	9	7			
Advertisements	8	1	9			
Carriage and Travelling	21	15	10			
Sundries	34	15	9			
						188	18	2
TOTAL COST OF MAINTENANCE						7083	14	7
ADMINISTRATION—								
MANAGEMENT :								
Clerical assistance	130	0	0			
Official Printing, &c.	67	13	8			
„ Postages and Telegrams	20	14	1			
Sundries, Bank Charges	140	19	11			
			358	17	8			
FINANCE :								
Appeals	—					
Commission	—					
Festivals, Bazaars, &c.	—					
TOTAL COST OF ADMINISTRATION						358	17	8
TOTAL COST OF MAINTENANCE AND ADMINIS-								
TRATION						7442	12	3
RATES AND TAXES						147	10	9
TOTAL EXPENDITURE						7590	3	0
BALANCE, being Excess of Income over Expendi-								
ture for year						275	1	4

£7865 4 4

JENNY LIND HOSPITAL

Balance Sheet

	£	s.	d.	£	s.	d.	£	s.	d.
BARCLAYS BANK LTD. ..							2528	15	7
SUNDRY CREDITORS							412	16	8
CAPITAL ACCOUNT :									

(A) Special purposes —

(a) Hospital Endowments 6946 1 1

(b) Endowed Cots—

Ernest England Cot 1000 0 0

Caroline Colman Cot 1000 0 0

Alan Cozens-Hardy

Colman Cot .. 1000 0 0

Florence Louise Cot 1000 0 0

E. T. B. Wightman

Cot.. .. 515 0 0

Roll of Honour Cot

(1915) .. 1000 0 0

Hugh Whitwell Cot

(1923) .. 1023 0 0

Ann Forrester Cot

(1926) .. 500 0 0

“Gugnunc” Cot

(1927) .. 500 0 0

14484 1 1

(B) General Purposes .. 9612 6 11

24096 8 0

(C) Land, Buildings, and Equipment—

Hospital and Out-Patient

Department 20669 10 11

(D) Land adjoining Hospital 1000 0 0

(E) War Memorial Buildings and Laura

Stuart Ward 2949 8 0

(F) Nurses' Hostel and Equipment .. 3991 18 7

(G) New Out-Patient Department .. 2200 0 0

30810 17 6

UNEXPENDED INCOME BALANCES OF SPECIAL FUNDS :

£ s. d.

Samaritan Fund .. 50 18 11

Toys, &c., Fund .. 32 14 10

Tinfoil Fund .. 21 4 10

104 18 7

Legacies for Capital

Purposes 893 19 0

SPECIAL APPEAL FUND 5497 5 5

£64345 0 9

H. HARPER SMITH, F.S.A.A.,
HON. SECRETARY.

ANNUAL REPORT 1928

December 31st, 1928.

	£	s.	d.	£	s.	d.
CASH IN HAND				75	9	3
SUNDRY DEBTORS				222	10	5
INVESTMENTS ON CAPITAL ACCOUNTS, AT COST :						
(as detailed on page 27)						
Special Purposes—						
(a) Hospital Endowments ..	14484	1	1			
(b) General Purposes	9612	6	11			
				24096	8	0
LAND, BUILDINGS, & EQUIPMENT OF THE HOSPITAL :						
Freehold Land, with Hospital Buildings, Unthank Road, Norwich (at cost)	17040	5	5			
Furniture (at cost)	1057	15	3			
Observation Block	1826	16	6			
Out-Patients' Department Build- ing	531	12	7			
Verandahs	589	16	9			
Land	1000	0	0			
War Memorial Buildings and Laura Stuart Ward	3750	19	5			
Nurses' Hostel (at cost) ..	3991	18	7			
New Out-Patient Department ..	2200	0	0			
				31989	4	6
CASH IN BANK :						
Samaritan Fund	50	18	11			
Toys, &c., Fund	32	14	10			
Tinfoil Fund	21	4	10			
				104	18	7
Special Appeal Fund				2644	15	9
Ditto Deposit Account..				2500	0	0
INCOME ACCOUNT :						
Balance from last Account ..	2986	15	7			
Less Balance (Income and Ex- penditure Account)	275	1	4			
				2711	14	3
				£64345	0	9

We have examined the Balance Sheet of the Jenny Lind Hospital dated December 31st, 1928, above set forth, with the books, and vouchers and certify the same to be correct, and in accordance therewith.

We have verified the investments and inspected the deeds of the properties

BULLIMORE & CO.

Chartered Accountants.

} HON. AUDITORS.

15, Upper King Street, Norwich,
26th March, 1929.

Sundry Accounts—Year ended 31st December, 1928.

RECEIPTS.		BUILDING FUND.		PAYMENTS.	
£	s. d.	£	s. d.	£	s. d.
Balance from last account	5828 19 9	Repayment of Loan to Mr. H. N. Holmes	2000 0 0	Payments on account of New Block ..	2200 0 0
Proceeds of Sale—No. 272, Unthank Road	1647 10 5	Alterations to and Equipment of "Pym House"	1246 18 7		
Lord Mayor's War Memorial Fund (further on account)	200 0 0	Expenses <i>re</i> laying of Foundation Stone—Out-Patient Department	65 3 5		
Legacy—Mrs. Pym—One Moiety of Residuary Estate	2758 17 8	Conveyance Stamps, etc.	60 7 4		
Sundry Donations (see page 33) ..	281 17 4	Balance at Bank—Current Account	2644 15 9	Deposit Account	2500 0 0
	<u>£10717 5 1</u>				<u>£10717 5 1</u>

RECEIPTS.		SAMARITAN FUND ACCOUNT.		PAYMENTS.	
£	s. d.	£	s. d.	£	s. d.
Balance at Bank	5 18 0	Surgical Appliance	6 0 0	
Interest (one year)	1 9 1	Milk supplied to Patient	0 8 2	
		Balance at Bank, Deposit A/c.	50 18 11	
	<u>£57 7 1</u>			<u>£57 7 1</u>	

RECEIPTS.		TOYS, &c., FUND.		PAYMENTS.	
£	s. d.	£	s. d.	£	s. d.
Balance	32 14 10	Balance at Bank	32 14 10	
	<u>£32 14 10</u>			<u>£32 14 10</u>	

RECEIPTS.		TINFOIL FUND.		PAYMENTS.	
£	s. d.	£	s. d.	£	s. d.
Amount realised on Sale	21 4 10	Balance at Bank	21 4 10	
	<u>£21 4 10</u>			<u>£21 4 10</u>	

15, Upper King Street, Norwich.
26th March, 1929.

Examined and found correct,
(Signed) BULLIMORE & CO., } HON. AUDITORS.
Chartered Accountants.

Schedule of Investments, 1928

ENDOWMENT FUNDS.

<i>Amt. Purchased.</i>				<i>Cost.</i>		
£	s.	d.		£	s.	d.
903	18	2	India Government 3% Stock ..	1000	0	0
5207	0	0	London and North Eastern Railway 4% 2nd Guaranteed Stock ..	6875	1	6
1925	0	0	Norwich Corporation Mortgage 3½% Bonds	1925	0	0
75	0	0	Ditto 4¾% ditto	75	0	0
124	17	9	2½% Consolidated Stock	120	19	7
750	7	10	2½% Consolidated Stock Roll of	500	0	0
526	5	7	4% Canada Registered Stock Honour Cot	500	0	0
136	12	11	5% War Stock (converted)	125	0	0
815	0	0	3½% Conversion Stock, representing gift by Mrs. Joseph Pilling, in memory of her late father, Jeremiah Woodrow	500	0	0
617	3	6	4% Consolidated Stock	500	0	0
108	14	3	5% War Stock, 1929-47	100	0	0
140	0	0	Bullard & Sons 4½% 2nd Prefs. ..	140	0	0
1301	19	2	3½% Conversion Stock (representing Hugh Whitwell Cot)	1023	0	0
100	0	0	Norwich Corporation 5½% Housing Bonds	100	0	0
490	15	0	5% War Stock, B Account	500	0	0
490	15	0	5% Ditto, C Account	500	0	0
£13713	9	2		£14484	1	1

GENERAL FUNDS.

£	s.	d.		£	s.	d.
200	0	0	2½% Consolidated Stock	194	0	0
700	0	0	3½% Metropolitan Consolidated Stock	787	10	0
375	8	10	3½% Conversion Stock	300	0	0
420	0	0	Norwich Corporation 5% Stock ..	696	0	0
700	0	0	Lowestoft Water & Gas Co., Ltd. 4% Debenture Stock	794	10	0
1400	0	0	London and North Eastern Railway 4% Guaranteed Stock	1925	13	6
1400	0	0	London Midland and Scottish Railway 4% Preference Stock	1925	13	6
395	0	0	London and North Eastern Railway 4% 2nd Guaranteed Stock	500	17	6
844	5	6	3% India Government Stock	800	0	0
1118	16	6	3% New Zealand Government In- scribed Stock	1000	0	0
608	15	1	5% War Stock, 1929-1947 (Dr. Blyth's Appeal, Feb., 1917)	578	2	5
10	0	0	Norwich City Football Club Share ..	10	0	0
113	0	10	4% Consolidated Stock	100	0	0
£8285	6	9		£9612	6	11

JENNY LIND HOSPITAL

LIFE GOVERNORS

HER MAJESTY THE QUEEN.

ADAMS MR. HENRY SIMMS-NORMAN	Stratton House, Cirencester.
ADAMS MISS ESTELLE NORMAN ...	Stratton House, Cirencester.
ANDERSON W. E. G., Esq. ...	120, Queens Road, Norwich.
ANDERSON MRS.	120, Queens Road, Norwich.
ASHFIELD MISS	Didlington Hall, Brandon.
BATES LADY	Hindreton Hall, Neston, Cheshire.
BIGNOLD MRS. C. R.	Loddon, Norfolk.
BLANDEN A., Esq.	70, Mill Hill Road, Norwich.
BOARDMAN E. T., Esq.	How Hill, Ludham.
BOARDMAN MISS JOAN C.	How Hill, Ludham.
BOARDMAN CHRISTOPHER A., Esq.	How Hill, Ludham.
BOARDMAN HUMPHREY COLMAN, Esq.	How Hill, Ludham.
BOARDMAN STUART COZENS-HARDY, Esq.	How Hill, Ludham.
BOARDMAN MICHAEL RUSSELL ...	How Hill, Ludham.
BOULTON & PAUL, LTD. EMPLOYEES	Mr. G. E. ffiske, Brundall.
HOSPITAL FUND	Mr. A. E. Jackson, 8 Lollard's Road, Norwich.
BULLARD MRS. E.	Wroxham.
BURLINGHAM MISS JOAN	Chedgrave Cottage, Loddon.
BURTON S. H., Esq. (deceased) ...	St. Giles', Norwich.
CARTER OSCAR, Esq.	211, Newmarket Road, Norwich.
CHAMBERLIN MISS M.	Christ Church Road, Norwich.
COLMAN MISS	Carrow Abbey, Norwich.
COLMAN MISS HELEN C.	Carrow Abbey, Norwich.
COLMAN GEOFFREY RUSSELL REES, Esq.	Bixley.
COLMAN MISS BERYL CAROLINE REES	Crown Point, Norwich.
COZENS-HARDY MRS. SIDNEY ...	Bracondale, Norwich.
DAKIN MRS. W. H.	Chester Place, Norwich.
DAYNES A. W., Esq.	28, College Road, Norwich.
DASHWOOD C. HORACE, Esq. ...	
DUFF MISS BASILIA... ..	Trimingham House, Mundesley.
EATON F. R., Esq.	Eaton Hall.
EATON MRS. F. R.	Eaton Hall.
EATON BARBARA	(In memoriam)
FIELDEN MRS. FRANCIS	Beechamwell Hall, Swaffham.

LIFE GOVERNORS (continued)

GANNON LETITIA (Trustees of)	...	Leiston, Suffolk.
GLOVER T. BERNARD, Esq.	...	Cliff House, St. Leonard's Road, Norwich.
H.R.H. THE PRINCESS MARY, VISCOUNTESS LASCELLES	...	Goldsborough Hall, Yorks.
HALL MRS. WILLIAM	...	Kirby House, Kirby Bedon.
HARMER MISS	...	194 Rue de Grenelle, Paris VII.
HARPER SMITH MRS. L.	...	435, Unthank Road, Norwich.
HICKS MRS. VYVYAN	...	Broomfield Avenue, Palmers Green London, N.13.
HILL COLONEL S. GARERD	...	Town Close, Norwich.
HIRST MRS. M. JOY	...	Durker Roods, Meltham, Yorks.
HOLMES HENRY N., Esq.	...	Upton Road, Norwich.
HOLMES MRS. H. N.	...	Upton Road, Norwich.
HOTBLACK MRS. G. S.	...	Brundall, Norwich.
HUTCHINSON MRS.	...	"Sheepstor," Yelverton, South Devon.
JACOBS ELLIS, Esq.	...	10, Albemarle Road, Norwich.
JEWSON MISS ELLEN	...	Albemarle Road, Norwich.
JEWSON MISS EDITH	...	Lower Hellesdon, Norwich.
JEWSON MISS CONSTANCE	...	Albemarle Road, Norwich.
JEWSON RICHARD, Esq.	...	Old Catton, Norwich.
LANCHESTER H. C., Esq.	...	Salle Rectory, Reepham.
LAWS MRS. M. HACKFORTH	...	Putney.
LEFROY MRS.	...	Abenhall, Mitcheldean, Gloucester.
LEFROY MISS	...	Abenhall, Mitcheldean, Gloucester.
LEONARD J. A., Esq.	...	72, Upper Close, Norwich.
LLOYD WALTER, Esq.	...	East Carleton.
LLOYD HAROLD, Esq.	...	East Carleton.
LLOYD MISS AUDREY	...	East Carleton.
LOCKETT MRS. VIVIAN	...	Crown Point, Norwich.
L.N.E.R. (Norwich District) HOSPITAL FUND :—		
HOWLINGS MR. J.	...	27, Magdalen Road, Norwich.
DRURY MRS. H. W. C.	...	Tudor House, Lower Clarence Road, Norwich.
SNELLING MRS. H.	...	56, Patteson Road, Norwich.
WILLIS MRS. J. B.	...	The Spinney, Ranson Road, Norwich.
PAYNE MR. A.	...	10, Florence Road, Norwich.
BLANDEN MR. E. G.	...	31a, Thorpe Road, Norwich.
KIRK MRS. C. B.	...	5, Thorpe Road, Norwich.
WILSON MRS. F. C.	...	23, Nightingale Road, Clapton, London, E.5.
BARNES MR. C. C.	...	11, Vincent Road, Norwich.
TRIP MR. J. H.	...	73, Primrose Road, Norwich.
CALVER MRS.	...	8, Riverside Road, Norwich.
HENNESSEY MRS.	...	5, Thorpe Road, Norwich.

JENNY LIND HOSPITAL

LIFE GOVERNORS—(continued)

MARTINEAU MISS L. E.	Foxholes, Weybridge.
MEADE-WALDO MRS.	Keswick Hall, Norwich.
MOORE MRS. F. G. L.	8, Branksome Road, Norwich.
NASH WILLIAM, ESQ.	86, Newmarket Road, Norwich.
NORWICH UNION FIRE OFFICE			
BAZAAR COMMITTEE	Miss Lilian Dell.
NORFOLK AND NORWICH SAVINGS			
BANK	LIEUT.-COL. E. R. A. Kerrison, C.M.G., O.B.E. (Chairman).
OLIVERSON CECIL H., ESQ.	...		
PALMER MRS. ROBERT WALPOLE	...		1, Claremont Road, Norwich.
PALMER MRS. HOTSON	3, Claremont Road, Norwich.
PAUL J. J. DAWSON, ESQ.	Eaton Grove, Norwich.
PILLING MRS. JOSEPH	Withington, Manchester.
PITT THE REV. R. W.	Scarning.
PLUMSTEAD A. E., ESQ.	St. Bartholomews Close, Norwich.
POWN-JONES MRS.	8, North Hill Court, Headinglea, Leeds.
POPE MRS. LOUISE	Heigham Hall, Norwich.
PRIESTMAN MRS. HEDLEY	...		
PRIESTMAN MASTER JOHN REEVE			} c/o Barclays Bank, Whitby, Yorks.
PRIESTMAN MISS ANNIE LOUISE	...		
RANSOME MRS.	Hethersett Old Hall, Norwich.
REEVE EDMUND, ESQ.	Catton Grange, Norwich.
REEVE ADOLF, ESQ.	Catton Grange, Norwich.
ROCHE DR. E. B.	Sheringham.
ROSEBERY THE RIGHT HON. THE			
EARL OF, K.T.	Lansdowne House, 54, Berkeley Square, W.
SMITH HAROLD E., ESQ.	13, Constitution Hill, Ipswich.
SOUTHALL MISS	40, Grove Avenue, Norwich.
SPAIN IVAN, ESQ.	Hillside Road, Thorpe St. Andrew, Norwich.
TOOTH MRS. MABEL A.	Wortham Grove, Diss.
TURNER MRS. HORACE	
WALTER MISS M. T.	Drayton Old House.
WALTER MISS E. D.	Drayton Old House.
WALTER MISS M. A.	Eldveton Lodge, Thorpe Market.
WALTER MASTER J. O.	Eldveton Lodge, Thorpe Market.
WALTER MR. AND MRS. CYRIL	Drayton Old House.
WHITE MRS. G. E.	Eaton House, Norwich.
WILLIS MISS EDITH L.	Southwell Lodge, Norwich.
WINDLE E. G., ESQ.	38, Mincing Lane, London E.C.

M O R N I N G T O N R O A D

JENNY LIND HOSPITAL

Scale 0 10 20 30 40 50 60 70 80 90 100 feet

TENNIS

F

(L)



U N T H A N

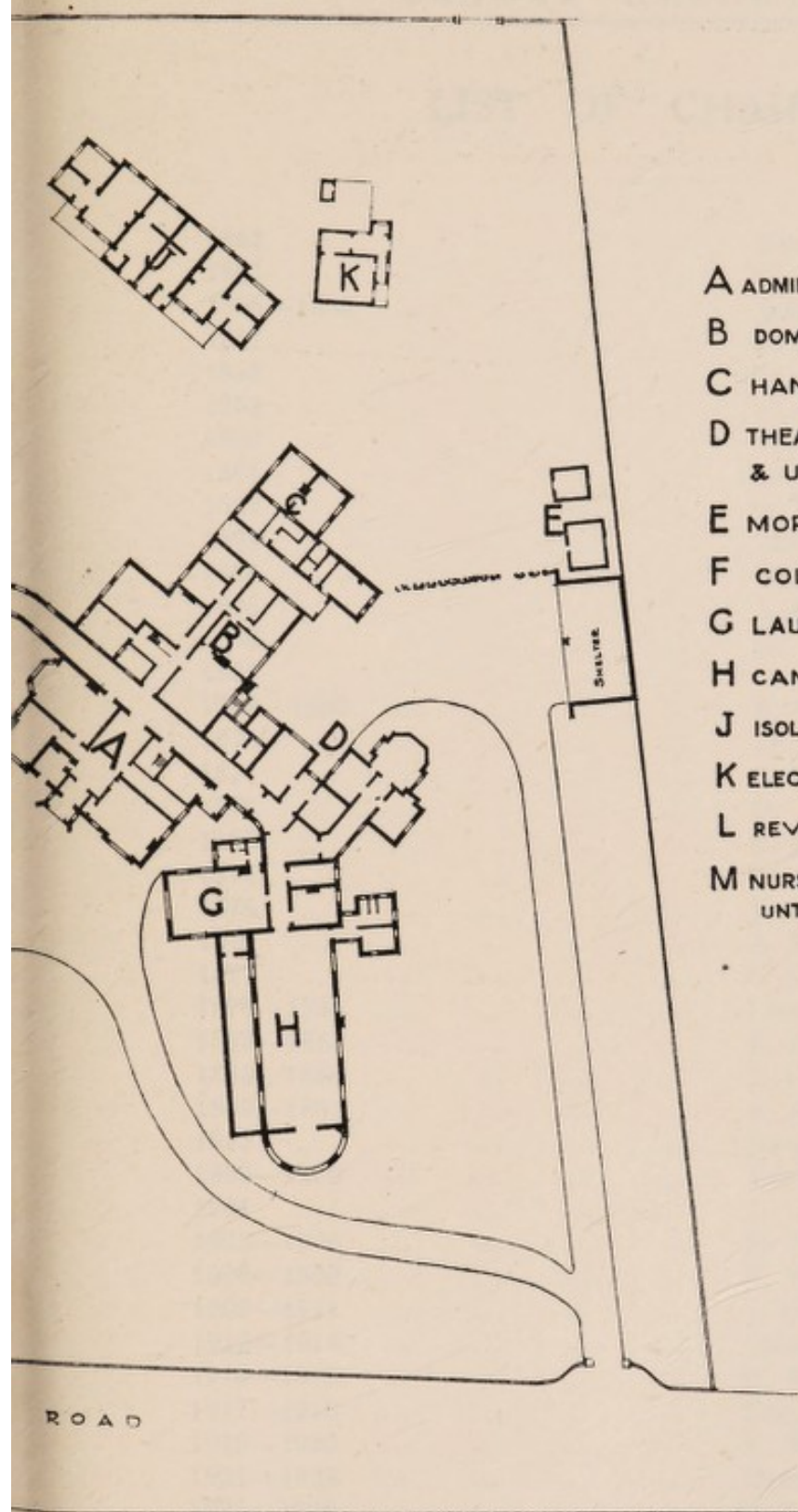

- A ADMINISTRATIVE BLOCK
- B DOMESTIC
- C HAND LAUNDRY
- D THEATRES, MASSAGE RM
& ULTRA VIOLET RAYS
- E MORTUARIES
- F COLMAN WARD
- G LAURA STUART WARD
- H CANNON WARD
- J ISOLATION BLOCK
- K ELECTRICAL MASSAGE DEPT
- L REVOLVING SHELTER
- M NURSES' HOSTEL PYM HOUSE
UNTHANK ROAD

M

A. ...
 B. ...
 C. ...
 D. ...
 E. ...
 F. ...
 G. ...
 H. ...
 I. ...
 J. ...
 K. ...
 L. ...
 M. ...
 N. ...
 O. ...
 P. ...
 Q. ...
 R. ...
 S. ...
 T. ...
 U. ...
 V. ...
 W. ...
 X. ...
 Y. ...
 Z. ...



M

...

LIST OF CHAIRMEN

1853	Samuel Bignold, Esq.
1854	G. E. Simpson, Esq.
1855—1856	John Barwell, Esq.
1857	G. E. Simpson, Esq.
1858	W. J. Cubitt, Esq.
1859	The Rev. J. Crompton
1860	W. J. Cubitt, Esq.
1861	Dr. Dalrymple
1862	G. E. Simpson, Esq.
1863	The Rev. H. Symonds.
1864	W. H. Clabburn, Esq.
1865	J. A. Back, Esq.
1866	Dr. Z. Buck
1867	Dr. Bateman
1868—1869	E. K. Harvey, Esq.
1870	The Rev. W. N. Ripley
1871	C. S. Gilman, Esq.
1872	Dr. Z. Buck
1873	E. K. Harvey, Esq.
1874	W. J. Cubitt, Esq.
1875	Joshua Swann, Esq.
1876	A. R. Chamberlin, Esq.
1877	C. S. Gilman, Esq.
1878—1881	Lieut-Col. G. W. Boileau
1882—1883	E. K. Harvey, Esq.
1884—1888	J. J. Winter, Esq.
1889—1891	A. R. Chamberlin, Esq.
1892	Edward P. Simpson, Esq.
1893—1900	Russell J. Colman, Esq.
1901	J. J. Winter, Esq.
1902—1905	Sir Charles Gilman
1906—1908	F. W. Cooke, Esq.
1909—1911	J. B. Forrester, Esq.
1912—1914	Colonel S. Garerd Hill
1915—1916	E. E. Blyth, Esq., LL.D.
1917—1918	Edgar R. Waters, Esq.
1919—1920	F. W. Cooke, Esq.
1921—1923	Henry N. Holmes, Esq.
1924—1925	G. E. W. Woolsey, Esq.
1926—1927	Miss Helen Colman
1928	G. E. W. Woolsey, Esq.

J E N N Y L I N D H O S P I T A L

DONATIONS, 1928

Legacy under the Will of—

						£	s.	d.
J. B. Forrester, Esq.	100	0	0

Norwich Hospitals and Medical Institutions Sunday and Saturday Fund

3480 0 0

Alexandra Rose Day 81 11 2

Harvest Festival Collections.

Attleborough Church	1	9	3
Carrow Road Sunday School	1	10	0
Christ Church, Eaton	7	19	9
Clippesby Church (part Collection)	0	7	6
Colney Church	2	2	0
Eaton Parish Church	6	1	2
Fundenhall Church	0	10	0
Garboldisham Parish Church (part Collection)	3	1	3
Horsford Church	2	2	8
Kenninghall Church, Children's Service	0	8	9
Ranworth Church (part Collection)	1	0	0
St. Mark's, Lakenham, Children's Service	0	8	0
St. Catherine's Church, Children's Service	0	10	0
Scole Church	5	1	7
Stokesby Church (part Collection)	1	0	0
Swannington Church	1	0	0
Unthank Road Baptist Sunday School	1	1	0
Yelverton Church (part Collection)	1	7	0

Offertories—

Children's Anniversary Services, Primitive Methodist			
Chapel, Reedham	3	1	6
Eccles Road Church, "Pound Sunday"	1	5	0
Hardingham Memorial Hall Service	1	7	3
Horsford Church	0	3	2
Mothers' Union, Cathedral Service	11	16	2
Old Catton Church, Christmas Day Offertory	11	2	9
Saxlingham Nethergate Church	1	0	0
Shotesham Church, Christmas Day Offertory	4	8	6
Skeyton Church, Christmas, 1927, Collection	1	14	6
Sproston Sunday School	0	5	2

ANNUAL REPORT 1928

	£	s.	d.
Swaffham Parish Church Sunday Schools and Catechism..	1	14	10
Delf Memorial Congregational Church Sunday School ..	0	5	0

Special Donations to the Building Fund—

In addition to the sums mentioned in last year's report, the following further amounts have been received :—

Joint Hospitals and War Memorial Appeal, on account of balance due to this Hospital	200	0	0
Mr. Henry Abigall	1	1	0
Anonymous	5	0	0
Anonymous, per M. E. P.	0	5	0
Anonymous	0	7	6
Mrs. Back	5	0	0
Miss Dora Berney	2	0	0
Mr. Herbert Bullard	1	0	0
Staff of Carrow Works, per Mr. J. C. Gibling, gift in memory of the late Mr. R. H. Olley	2	5	0
Mrs. Collinson, Sale of Cookery Book, "Come Inside" ..	50	0	0
Miss Ethel Colman and Miss Helen Colman, takings at Lecture on "A Cruise to the Northern Capitals" ..	15	1	0
Miss Helen Colman, Sale of Book of Children's Sayings ..	25	9	2
Mr. and Mrs. Cooper	10	0	0
Mrs. and Miss Cubitt, result of Entertainment	7	10	0
Mrs. Hugh Davies, Miss Margery E. Palmer, and Mrs. Mrs. Upcher, Jumble Sale in Ber Street	28	0	0
Garboldisham Church, offertory taken at 8 o'clock Service, per Mr. A. W. Starling	1	1	2
Mr. and Mrs. George Dennis	2	2	0
Works Hospital Committee of Howlett & White, Limited, per Mr. Oscar Trollope	5	5	0
Miss Littlewood	20	0	0
Norwich High School for Girls, per Miss Wise	10	0	0
Lady Mary Barrett-Lennard	1	1	0
Mrs. Pillow,	5	0	0
Miss Gwen Stevenson, net proceeds of Charity Matinee given at Theatre Royal	45	5	3
Mr. A. D. Sutton	1	11	6
Walpole Masonic Lodge, collection at Table at Installation	4	0	0

DONATIONS TO GENERAL FUND.

Union Lodge of Freemasons, per Mr. Ernest Oetzmann ..	4	11	3
Grand Nelson Friendly Society, per Mr. A. Grand ..	1	1	0
Mrs. Willis, Ranson Road, proceeds of Dance	5	7	0
Mr. Henry Thouless, 87th Birthday thanksgiving	4	7	0
L. & N.E.R. Staff (Northern Division) Hospital Fund ..	45	0	0
Mrs. Watson-Kennedy, Wiveton Hall, Cley, proceeds of Whist Drive and Dance	2	0	0
Staff of Carrow Works <i>re</i> "W. H. M."	0	16	0
Anonymous	10	0	0
Anonymous	5	0	0
Mrs. Pitt, Scarning	50	0	0

JENNY LIND HOSPITAL

	£	s.	d.
Mr. Crane, Collection made at Dance held in St. Andrew's Hall	3	0	0
The Children of Ketteringham School, per Mrs. Limmer ..	0	11	0
The Rev. and Mrs. W. Ackroyd, Gorleston	0	10	0
Mr. A. Croger, The Grange, Bury St. Edmunds	2	2	0
Mrs. and Nurse Everett, Moiety of Takings at an Entertainment	2	10	0
Orchard Tavern Dart Club, Heigham Street, per Mr. H. Paveley	0	10	0
Norfolk and Norwich Triennial Musical Festival, 1927, per Mr. F. W. W. Morgan, part proceeds of collections made at performances	10	10	0
The Corner Tea House, Norwich	1	4	6
Mr. J. S. Sedgwick, Surrey Street	2	2	9
Miss Edna Frazer, Berners Street, proceeds of Concert given by four little girls	0	2	6
Norfolk and Norwich Amateur Operatic Society, per Mr. Oscar Carter, part proceeds of performances of "The Gondoliers"	63	0	0
Mr. and Mrs. Towler, Swardston, proceeds of a Whist Drive	6	4	0
Mr. Frederick Southall, Cotman Road	5	0	0
Proceeds of Bury Charity Cup and Quay Side Charity Shield, per Messrs. Peters and Carey	11	1	6
Mr. and Mrs. P. Whittington, in appreciation of treatment to daughter	1	0	0
Norwich Boy Scouts Association, per Mr. Claude Stratford, collection at St. George's Day Parade	3	10	0
Anonymous, contents of money box of child who died in Hospital	0	4	9
Mrs. M. R. Brasnett, Trimley St. Mary, in memory of son Alan	5	0	0
"Beryl"	20	0	0
The Norfolk Motor Club, part proceeds of Gymkhana held on Easter Monday	31	10	0
Norfolk County Football Association, per Mr. S. R. B. Cowles, from Charity Competition	5	0	0
Anonymous, 81st Birthday gift	5	0	0
Anonymous	1	16	0
Norwich Co-operative Society, Limited, part proceeds of Collections made at Agricultural Hall Exhibition	11	5	0
Mr. A. Harley	0	2	6
The G.F.S. Candidates of Shotesham, per Mrs. E. Best, proceeds of Sale of Work held on Empire Day	1	0	0
The Empire Whist Club, per Mr. Heaver	3	15	0
The School children of Drayton, per Mrs. Cyril Walter, proceeds of Concert	11	5	0
Mrs. Calver, Riverside Road, proceeds of Concert by the Railway Military Band	9	13	6
The Committee and Members of the Norwich Gladstone Club, per Mr. R. Tomlinson	3	15	0
Norwich Imperial Brass Band, per Mr. L. Kelly, 50% of takings at Concert in Chapel Field Gardens	3	4	3

ANNUAL REPORT 1928

	£	s.	d.
Students of Norwich Training College, per Miss E. M. Winnington-Ingram	0	10	0
Messrs. Bullen, Son & Kemp, proceeds of Collection made at Outing	0	12	0
Mr. J. Howlings, Magdalen Road	1	0	0
Mrs. Bardwell, St. Monica's School, Norwich, proceeds of collection made at Prize Giving	4	10	0
Earlham Ward Liberal Association, proceeds of Collection at Fete	1	15	0
Anonymous	0	2	6
Mrs. Rackham, Stanfield Hall, Wymondham, proceeds of Tennis Tournament	10	18	0
The British Red Cross Society (Norwich Division) per Mr. C. W. Steel, half proceeds of collection made at Band performance in Chapel Field Gardens	2	7	9
Mr. A. D. C. Sawford, Trory Street	0	10	6
Part Proceeds of Norwich Charity Sports, held on Whit Tuesday, per Mr. H. O. Bennett	5	0	0
Norwich Co-operative Society, Limited, amount collected at Flower Show and Fete held in Carrow Abbey Grounds	10	0	0
Part proceeds of Railwaymen's Charity Fête held in Carrow Abbey Grounds, per Mr. F. W. Rivett	23	0	0
Norwich Imperial Brass Band, per Mr. L. Kelly, 50% of Collection made in Chapel Field Gardens.. .. .	2	11	2
The Avenue Bowling Club, per Mr. G. Hawkins, amount collected on Green	0	13	4
Half proceeds of Railway Band Concert held in Chapel Field Gardens, per Mrs. Calver	4	2	0
Mr. F. Thurston, 113, Thorpe Road	1	0	0
Perseverance Royal Arch Chapter No. 213, per W. Bro. G. W. Durndell	2	2	0
"E"	1	0	0
The Committee of the Wroxham Water Carnival, per Mr. C. R. Chamberlin	2	0	0
The Gothic Minstrel Troupe, per Mr. H. O. Clark, result of Entertainments held last Season	25	0	0
Kennilworth Tennis Club, per Miss M. Carver, proceeds of Dance	1	13	4
Orford Hill Sunday School, per Miss M. Purling	0	13	6
Mr. C. W. Neve, proceeds of Whist Drive held at Drayton Lion Club Room	1	15	0
Mr. George Gough, Old Catton	0	5	0
The Directors of the Norwich City Football Club, from proceeds of takings at two Practice Matches held at commencement of Season	26	5	0
Mr. E. L. Merrell Brown, Topcroft, half proceeds of Dance held in Village	1	4	0
Mr. G. Cozens-Wiley, White House, Little Plumstead	1	0	0
Mrs. J. A. Upton, 127, Newmarket Road	1	1	0
Strumpshaw Tennis Club, proceeds of Whist Drive, per Mr. C. A. Rope	3	14	0
Mr. J. Howlings, Token of Appreciation	1	0	0

JENNY LIND HOSPITAL

DONATIONS—continued.

	£	s.	d.
Anonymous	0	9	8
The What-Nuts Concert Party, per Mr. S. T. Ringwood, proceeds of Concert held at Thorpe Gardens Pavilion ..	1	0	0
Swan Swimming Club (Women's Section) Balance from Gala held in Summer	7	1	3
Mrs. Harmer, 13, St. Michael's Square, Thorn Lane, in Memory of son, Ralph	0	6	0
Church of England Incorporated Society for Providing Homes for Waifs and Strays—an acknowledgement ..	2	2	0
Mr. and Mrs. J. S. Davis, Unthank Road	1	1	0
Mrs. Molyneux-Montgomerie, Garboldisham Old Hall ..	2	2	0
St. Cross and St. Margaret's Contributory Fund, per Mr. Robert Hardingham, proceeds of Whist Drive	5	1	8
Mrs. A. W. Sellex, Unthank Road	2	2	0
St. Withburga's Mission Church Girls' Choir, per Miss Helen Harrison, amount collected by Carol Singers..	1	0	0
Attleborough Infants' School, per Miss B. Fox	0	5	0
Miss E. High, amount collected by Carol Singers	2	1	9
Class I, Avenue Road Boys' School, per Master George Clarke, Entrance Fees for Draughts Tournament ..	0	5	0
The Rev. Anthony Fenn, proceeds of Entertainment given to Church Day School Children of Bintree ..	0	8	6
Mr. John Field, Bintree	5	5	0
Thuxton-with-Garveston Missionary Work Association, per the Rev. A. J. Alpe	0	10	6
The Loyal Past and Present Officers, M.U.I.O.O.F., per Mr. J. Howlings	2	2	0
Messrs. Fuller & Co., Share of proceeds of Weighing Machines	0	7	6
Anonymous	0	6	3
Esdelle Works, Holiday Fund, per Mr. H. N. Holmes	25	0	0

Collecting Boxes—

Messrs. Buntings, Ltd.	1	4	1
Messrs. Bullard & Sons, Ltd.	2	8	9
Mrs. Chittock	1	2	0
Miss Corsbie	0	7	6
Messrs. Daniels Bros.	0	9	2
"Eastern Daily Press" Office	0	2	7
The Electric Theatre	0	13	0
Mrs. G. J. F. Gillard	0	10	8
Mrs. Gooch	1	8	8
Messrs. Grimwades	0	2	0
Messrs. Gunton, Sons & Dyball	0	12	6
Messrs. Harper Smiths.	0	5	10
The Haymarket Picture House	0	6	8
Messrs. Howletts	0	0	5
Mr. Ernest Hudson	0	5	8
Messrs. Jarrolds	0	6	1
Mr. Kettle	0	10	0
Messrs. Lamberts	0	12	10

ANNUAL REPORT 1928

						£	s.	d.
Messrs. Lamberts (Goat Lane)	0	2	10
Mrs. J. H. Limmer	1	1	9
The Maypole Dairy Co., Ltd.	0	3	8
Mr. Newson	0	16	5
The Misses Plane and MacPherson	0	7	11
Princes Tea Rooms	0	0	6
The Regent Theatre	0	1	8
Scotch Tea Rooms	1	3	5
Mrs. W. H. Scott	0	3	7
Messrs. E. C. Sennitts	0	1	1
Mr. G. W. Shead	0	2	1
Mr. J. Sneath	0	3	8
Mr. Gerald Spalding	0	1	8
Miss Grace Stevenson	0	18	7
Messrs. Stockings	0	8	2
Mr. Sullivan	0	10	6
Theatre de Luxe Picture House	0	17	4
Thorpe Station Refreshment Room	0	7	6
Mr. H. J. Vince	0	4	9
Mr. A. W. Ward	0	0	7
Mr. Gundry White	0	8	2
Mrs. Willis	1	8	9
Mrs. Willis' Hymn Children	1	11	5
Miss Wise, Norwich High School for Girls	0	16	3
Miss P. Woolsey	0	10	0

JENNY LIND HOSPITAL

The Honorary Secretary will be greatly obliged by his attention being drawn to any errors in, or omissions from, the following list

ANNUAL SUBSCRIPTIONS, 1928.

				£	s.	d.
Abel Mr. W. P.	Norwich	..	10	6
Acock Mr. R. J.	Norwich	..	2	2 0
Adcock Mr. and Mrs. R. J.	Norwich	..	1	1 0
Adcock & Son	Norwich	..	5	5 0
Albemarle Countess of	Quidenham	..	4	4 0
Algar Mr. W. J.	Swainsthorpe	..	1	1 0
Algar Mrs. W. J.	Swainsthorpe	..	1	1 0
Allen Major S. G.	Norwich	..	10	6
Allen & Daws	Norwich	..	1	1 0
Allen Mr. Edward	Deopham	..	5	0
Allen Miss J.	Deopham	..	5	0
"Amicable" Lodge, per Mr. F. J.						
Foulger	Norwich	..	4	4 0
Andrews Mrs. W. H. M.	Hethersett	..	1	1 0
Ash Mr. Henry	Norwich	..	3	3 0
Arnold Mr. Harry H.	Norwich	..	2	2 0
Arnold Mrs. C.	Norwich	..	10	6
Atkinson Miss	Norwich	..	10	6
Austen Miss Mollie	Norwich	..	2	6
Avenue Bowling Club, per Mr. G.						
Hawkins	1	1 0
Ayton Mrs. C. R. (deceased)	Wymondham	..	1	1 0
Back Mrs. H. W.	Hethersett	..	2	2 0
Back Mr. C. W.	Norwich	..	2	2 0
Bacon Mr. Nicholas H.	Raveningham Hall	..	1	1 0
Bacon Thos. & Co.	Norwich	..	2	2 0
Bagshaw Messrs. G. & R. G.	Norwich	..	1	1 0
Bailey Mrs. A. W.	Wramplingham Hall	..	1	1 0
Bainbridge Mr. F. A.	Coltishall	..	1	1 0
Baird J. & Sons, Ltd.	Norwich	..	2	2 0
Balls Mr. T. W.	Norwich	..	1	1 0
Baly Mrs. Julia	Norwich	..	10	6
Baly & Owles, The Misses	Norwich	..	1	1 0
Barber Mr. Hudson	Catfield, Gt. Yarmouth	..	1	1 0
Barber Mr. and Mrs. B. H.	Norwich	..	1	1 0
Barclay Mr. H. G.	Colney Hall	..	5	5 0
Barclay Mr. James M.	Norwich	..	1	1 0
Barnard Mr. G. W. G.	Norwich	..	1	1 0
Barnards, Limited	Norwich	..	5	5 0
Barnes Miss Annie	Strumpshaw	..	1	1 0
Barnes Col. and Mrs. A. C.	Birmingham	..	2	2 0
Barnes & Pye Messrs.	Norwich	..	2	2 0
Carried forward..				..	66	5 0

FOUNDED 1853

3

The Governors and Friends of this Childrens' Hospital

ARE ASKED TO HELP

By sending the attached yellow form
to a friend

By increasing the amount of their
own contributions

By sending a special donation

3

N.B.—Life Governor's Donation - £21

It greatly facilitates the Collection of Subscriptions by kindly filling in this Order to your Bankers, and sending it to the
Hon. Secretary, 30, LONDON STREET, NORWICH

JENNY LIND HOSPITAL

BANKERS' ORDER

1929

To Messrs.

Branch

Please pay now, and on 1st January annually, without
application, until further notice, to Messrs. BARCLAYS BANK Ltd., Norwich
£ " " " " for the credit of the Jenny Lind Hospital

PLEASE
AFFIX A
TWO-PENNY
STAMP

Signature of
Subscriber

Address

£ :

TO THE HON. SECRETARY,

THE JENNY LIND HOSPITAL

1. Please send Bankers' Order

to.....

(Address)

.....

whom I have persuaded to become an Annual Subscriber of

£ : :

2. I am willing to increase my present Annual Subscription to

£ : : payable when it next becomes due.

3. I enclose a Donation of £

Name.....

Address.....

.....

ENDOWED COTS

In Memoriam

{ THE ERNEST ENGLAND
THE FLORENCE LOUISE
THE CAROLINE COLMAN
THE ALAN COZENS-HARDY COLMAN
THE E. T. B. WIGHTMAN
THE ROLL OF HONOUR COT (Captain
Charles Simms Reeve, who was killed in action)
HUGH WHITWELL COT
THE ANN FORRESTER COT

THE "GUGNUNC" COT

SUPPORTED COTS

NORWICH HIGH SCHOOL FOR GIRLS
NORWICH SUNDAY SCHOOL UNION
MUNICIPAL SECONDARY SCHOOL THANKSGIVING
MEMORIAL COT
NORWICH CHURCH SUNDAY SCHOOLS
ASSOCIATION COT
IN MEMORY OF
"WILLIAM OLDFIELD SNELLING, J.P.," COT
THE PRUDENTIAL ASSURANCE CO., LTD.

A Legacy or Donation of £500 will Endow a Cot

*A Yearly Subscription of £30 or upwards will
Support a Cot*

ANNUAL REPORT 1928

			£	s.	d.
	Brought forward	..	66	5	0
Barratt & Cooke Messrs.	..	Norwich ..	1	1	0
Barrow Miss E. J.	..	Drayton ..	1	1	0
Barry Lady Grace	..	Witchingham Hall	1	1	0
Barton Rev. Bernard	..	Pulham St. Mary	1	1	0
Barton Dr. Samuel J.	..	Norwich ..	1	1	0
Barwell & Sons, Messrs.	..	Norwich ..	1	1	0
Bassham Mr. E. E.	..	Norwich ..	2	2	0
Bassingthwaighte Mr. F. H.	..	Norwich ..	1	1	0
Bassingthwaighte Mrs. F. H.	..	Norwich ..		10	6
Batchelor Mrs.	..	Norwich ..		10	0
Batson & Webster, Ltd.	..	Norwich ..	6	6	0
Batt Col. R. C.	..	Gresham Hall	1	1	0
Beales Mr. F. B.	..	Norwich ..	1	1	0
Bedwell Mrs.		10	6
Bell Mr. A. B.	..	Norwich ..	1	1	0
Bell Canon J. Allen	..	Norwich ..	1	1	0
Bennett Mr. H. O.	..	Norwich ..	1	1	0
Berney Miss D. L.	..	Bracon Hall	1	0	0
Berney Mr. G. A.	..	Morton Hall	1	1	0
Betts Mr. J. F.	..	Norwich ..		10	0
Birkbeck Mr. E.	..	Stoke Holy Cross		10	0
Birkbeck Mr. W.	..	Stoke Holy Cross	1	0	0
Birkbeck Mr. Martin	..	Poringland	1	1	0
Birkbeck Mr. Henry	..	Westacre ..	1	1	0
Birkbeck Mr. Oliver	..	Little Massingham	2	2	0
Bird Mr. S. G.	..	St. Edmunds, Scole	1	1	0
Bishop Mr. John H.	..	Tunbridge Wells	2	2	0
Bishop Winsor & Co.	..	Norwich ..	2	2	0
Black Horse Bowling Club	..	Norwich ..	1	1	0
Blake Mr. Aubrey..	..	Norwich ..	1	1	0
Blazeby Mr. R.	..	Norwich ..		2	6
Blofeld Mrs.	..	Hoveton House		10	6
Blofield Union, Guardians of	..	Per Mr. J. E. T. Pollard	2	2	0
Blyth Dr. E. E.	..	Norwich ..	5	5	0
„ (In Memoriam Mrs. E. E. Blyth)	..	Norwich ..	2	2	0
Blyth Mrs. M.	..	Lowestoft	1	1	0
Blyth Miss L. A.	..	Norwich ..	1	0	0
Boardman Mrs. E. T.	..	Ludham ..	2	2	0
Bobby Mrs. Arnold	..	Diss ..		5	0
Boileau Sir M. C.	..	Ketteringham Park	1	1	0
Bolingbroke Mrs. H. C.	..	Norwich ..	1	1	0
Bolton Mr. W. H.	..	Aylsham	2	2	0
Bond Master Derek	..	Norwich ..	1	1	0
Bond Master R. Owen	..	Norwich ..	1	1	0
Bond Miss Helen M.	..	Norwich ..	1	1	0
Bond Miss Margaret A.	..	Norwich ..	1	1	0
Bond Miss Marjorie	..	Norwich ..	1	1	0
Bond Master Richard	..	Norwich ..	1	1	0
Bond R. H. & Sons, Ltd.	..	Norwich ..	2	2	0
Carried forward..			131	10	0

JENNY LIND HOSPITAL

				£	s.	d.
	Brought forward	131	10	0
Bond Mr. W. R.	Norwich	2	2	0
Boobyer and Callis, The Misses	Norwich	2	2	0
Boston Mr. George A.	Norwich	1	1	0
Boston Mrs. T. F.	Norwich	2	2	0
Botting Miss E. M.	Norwich	1	1	0
Boulton & Paul, Ltd.	Norwich	10	10	0
Boulton & Paul, Ltd., Employees						
Hospital Fund	Per Mr. A. E. Jackson	50	0	0
Bower Mr. J. G.	Norwich	1	1	0
Bowhill & Elliott Messrs.	Norwich	2	2	0
Bowhill & Hubbard, Ltd.	Norwich	2	2	0
Boyle Mrs. W. L.	London	1	1	0
Bradley Watson Mrs.	Norwich	1	1	0
" " Hugh, Jim & David	Norwich	7	6	
Brett Mr. Arthur	Norwich	1	1	0
British Gas Light Company, Ltd.	Norwich	5	5	0
British United Shoe Machinery Co., Ltd.	Norwich	1	1	0
Broadbent Mrs.	Norwich	10	0	
Brockbank Mrs. J. G.	Tisbury	2	2	0
Brooks Mr. and Mrs. J. Rayner	North Walsham Wood	2	2	0
Broxholm Mrs.	Norwich	1	1	0
Brown Mrs. Dupuis	Loddon	2	0	0
Bryan The Misses Alison, Sheila and Ursula and Master Derek	Norwich	10	0	
Buckingham Mr. Clifford	Norwich	10	6	
Buckingham Mrs. E. A.	Norwich	10	0	
Buckingham Mrs.	Norwich	5	0	
Buckingham Mr. Dick	Norwich	2	6	
Buckingham J. (Norwich), Ltd.	Norwich	1	1	0
Buckle Col. D. W...	Hingham	1	1	0
Budgen Mrs. K.	Poringland	5	0	
Bugg F. J., Ltd.	Norwich	2	2	0
Bullard & Sons, Limited	Norwich	8	8	0
Bullard Mrs. Archie	Norwich	1	1	0
Bullard Mrs. S.	Sherbourne Hall	1	1	0
Bullard Mrs. E. J.	Norwich	2	0	0
Bullard Mrs. Ernest	Wroxham	1	1	0
Bullard Miss Kathleen	Wroxham	10	0	
Bullen Mrs. B.	Norwich	5	0	
Buntings Ltd.	Norwich	5	5	0
Bunting Masters C. F. & J. C.	Norwich	5	0	
Burrell Mr. A. J.	Norwich	1	1	0
Burrell Miss Edith and Mr. Alan and Mr. Roy	Norwich	7	6	
Bury Mr. Thos.	Norwich	1	1	0
Busby Miss	Welbourne	10	0	
Butcher Mr. G. F.	Norwich	2	2	0
Butcher Mr. R. E.	Brundall	10	6	
	Carried forward	254	19	6

ANNUAL REPORT 1928

			£	s.	d.
	Brought forward	..	254	19	6
Butler & Hacon, Messrs.	.. Norwich	2	2	0
Butolph Mrs. Norwich	2	2	0
Buxton Mrs. C. L. Aylsham	1	0	0
Buxton Mr. E. Gurney Catton Hall	2	2	0
Buxton Mr. G. Fowell Hoveton Hall	2	2	0
Buxton Mrs. G. Fowell Hoveton Hall	2	2	0
Buxton Mrs. G. J. Tockenham Manor	2	2	0
Buxton Mr. Mervyn Peterborough	2	2	0
Caley A. J. & Sons, Ltd.	.. Norwich	10	10	0
Calvert Mr. E. M. Norwich		10	6
Campling Miss Hilda M. Norwich		5	0
Canham Mr. R. J. E. Norwich	1	1	0
Cannell Mrs. Horsford	2	2	0
Capon Mrs. E. H. Norwich	1	1	0
Carr Miss M. Hedenham Hall	1	1	0
Carrow Sunday School (per Mr. Easter)	.. Norwich	2	2	0
Cartwright Miss L. A. Bury St. Edmunds	1	1	0
Cattermoul Miss Norwich		10	6
Chamberlin Sir George (deceased)	.. Norwich	5	5	0
Chamberlin Mrs. A. R. Norwich	1	1	0
Chamberlins, Limited Norwich	5	5	0
Chamberlin Lady, "In Memory of"					
(per Sir George Chamberlin)	.. Norwich	2	2	0
Chamberlin Miss M. Norwich	1	1	0
Charles Mrs. S. F. Wroxham House	1	1	0
Christie Mr. J. A., M.P. Framingham Pigot	5	5	0
Chittock Mrs. G. C. Dilham		10	6
Chittock Mr. G. C. Dilham		10	6
Chittock The Misses Christine and Diana and Master Michael	.. Dilham		7	6
Church Mr. I. J. Norwich	1	1	0
Churchyard Mr. William Norwich	1	4	0
Clabburn Miss M. Thorpe St. Andrew	1	1	0
Clarke W. H. H. & Co. Norwich	5	5	0
Clarke Mrs. Norwich	1	1	0
Clements Mrs. Norwich		3	6
Cockrill Mrs. W. J. Norwich		10	6
Coe Mrs. A. E. Norwich	2	2	0
Coe Messrs. A. E. & Son Norwich	5	5	0
Coe Mrs. Edward Norwich	1	1	0
Coldham Miss Norwich	1	1	0
Coleman & Co., Ltd., Messrs.	.. Norwich	10	10	0
Coller & Sons, Ltd., Messrs.	.. Norwich	5	5	0
Coller Miss Audrey Norwich		10	0
Coller Miss Beryl Norwich		10	0
Coller Mrs. C. T. Norwich	1	1	0
Collinson Mrs. R. W. Norwich	2	2	0
Colls Mr. P R Cringleford	1	1	0
Carried forward..	354	0	0

JENNY LIND HOSPITAL

				£	s.	d.
		Brought forward	..	354	0	0
Collyer Mr. W. R...	..	Hackford Hall	..	3	3	0
Colman Miss	..	Carrow Abbey	..	6	6	0
Colman Miss Helen	..	Carrow Abbey	..	15	15	0
Colman Mr. John H.	..	Norwich	2	2	0
Colman Messrs. J. & J. Ltd.	..	Norwich	10	10	0
Colman Mr. Russell J.	..	Crown Point	..	5	5	0
Colman Mrs. Russell J.	..	Crown Point	..	1	1	0
Cook Miss E.	..	Bowthorpe Hall..	..	1	0	0
Cook Mr. Robins	..	Bowthorpe Hall..	..	1	0	0
Cook Mr. Warner (deceased)	..	St. Faith's	..	10	6	
Cook Miss Enid	..	Swardeston	..	1	1	0
Cooke Mr. and Mrs. F. W.	..	Swardeston	..	2	2	0
Cooper Mr. W. P.	..	Norwich	1	0	0
Cooper Mrs. W. R.	..	Norwich	1	1	0
Copeman The Misses	..	Norwich	1	1	0
Copeman Mrs. H. J.	..	Norwich	2	2	0
Copeman Mr. H. J., J.P.	..	Norwich	3	3	0
Copeman Messrs. J. & Sons, Ltd.	..	Norwich	5	5	0
Copeman The Rev. A. G.	..	Thorpe	..	1	1	0
Corbould-Warren Mrs.	..	Caister	..	1	1	0
Cowan Mr. Jas. S.	..	Edinburgh	..	2	2	0
Crawshay Miss G. M. M.	..	Hingham	..	1	1	0
Crosskill Messrs. C. R. & Sons	..	Norwich	1	1	0
Crotch Mr. Percy	..	Thorpe St. Andrew	..	1	1	0
Crotch and Norwich Billposting Co., Ltd.	..	Norwich	10	6	
Cubitt Major F. A.	..	Thorpe St. Andrew	..	2	2	0
Cubitt Mrs. O. C.	..	Brundall	..	1	1	0
Cuddon Mr. Philip	..	Norwich	1	1	0
Culley Mrs. A. C.	..	Norwich	5	0	
Culyer Mr. H. A.	..	Norwich	1	1	0
Curl Bros., Ltd., Messrs.	..	Norwich	3	3	0
Curl Mr. Ernest A.	..	Thorpe St. Andrew	..	2	2	0
Curl Mr. H. L.	..	Thorpe St. Andrew	..	1	1	0
Curl Mrs. H. L.	..	Thorpe St. Andrew	..	10	6	
Curl Mr. Percy E.	..	Thorpe St. Andrew	..	2	2	0
Currie Mrs. E. M.	..	Catton Court	..	1	1	0
Dakin Mrs...	..	Norwich	1	0	0
Dashwood Mr. C. H.	2	2	0
Davies Mr. Hugh C.	..	Old Lakenham	..	1	1	0
Davis Mr. F. S.	..	Norwich	1	1	0
Davies Miss E. M.	..	Norwich	5	0	0
Dakin Mr. J. Howard	..	Norwich	2	2	0
Davy Mr. & Mrs. C. E.	..	Norwich	1	1	0
Daws Mrs. Harry	..	Norwich	10	6	
Day Miss Geraldine	..	Canvey Island	..	1	0	0
Day Mr. H. A.	..	Norwich	2	2	0
Day Mrs. H. A.	..	Norwich	1	1	0
De Caux Mrs. S. T.	..	Norwich	1	1	0
		Carried forward	..	459	16	0

ANNUAL REPORT 1928

				£	s.	d.
	Brought forward	459	16	0
De Carle Smith Mr. J.	Thorpe St. Andrew	..	2	2 0
De Carle Mr. J., Jun.	Thorpe St. Andrew	..	2	2 0
Delves Mr. S.	Norwich	..	1	1 0
Denny Mrs. L. M...	Garboldisham Manor	..	1	1 0
Digby Mrs. A.	Fakenham	..	1	1 0
Dipple Mr. G. W.	Norwich	..	10	6
Diver Miss Josephine	Norwich	..	2	2 0
Downton Mrs. Murray	Diss	..	1	1 0
Dowson Miss	Geldeston	..	1	1 0
Driver Mr. Percy E.	Norwich	..	2	2 0
Duff Mrs. Granville	Heydon Hall	..	1	1 0
Duff, Morgan & Vermont, Ltd.,						
Messrs.	Norwich	..	1	1 0
Duncan Mr. Herbert	Norwich	..	10	6
Dyball Mr. H. E.	Norwich	..	1	1 0
Dyer Mrs.	Brundall	..	2	2 0
Eagleton Mrs.	Norwich	..	1	1 0
Eagleton Mr. W. (in memory of)	Norwich	..	1	1 0
East Anglian Unity of Oddfellows	Norwich (per Mr. J. Johnson)	..	6	6 0
East Dereham United Friendly Societies Parade	per Mr. R. Larnier	..	8	8 0
Eaton Master Tom C.	Norwich	..	1	1 0
Eddington Mr. A.	Norwich	..	2	2 0
Edwards Mrs. A.	Barford	..	2	2 0
Edwards Messrs. A. & Co.	Norwich	..	1	1 0
Edwards Mr. E. J. (1927)	Norwich	..	1	1 0
Edwards Mr. E. J. (1928)	Norwich	..	1	1 0
Edwards & Holmes, Ltd.	Norwich	..	10	10 0
Edwards & Holmes, Ltd. (Work-people's Collection)	Norwich	..	10	0 0
Edwards Mr. Harold	Cringelford	..	1	1 0
Edwards Mrs. Harold	Cringelford	..	1	1 0
Edwards Mrs. R.	Cringelford	..	2	2 0
Ellison Mr. G. T. R.	Norwich	..	1	1 0
Elsey Miss E. A.	Hingham	..	10	6
Elven Mr. W. W.	Norwich	..	1	1 0
Emms Mr. W. J.	Norwich	..	1	1 0
Evans Miss C.	Norwich	..	1	1 0
Evans-Lombe Major E. H.	Marlingford Hall	..	1	0 0
Everett Mr. H.	Norwich	..	10	6
Everington Mrs. W. D.	Swaffham	..	1	0 0
Falcon Michael, Esq.	Sprowston Hall	..	1	1 0
Fanning Mr. W. J.	Norwich	..	1	1 0
Fanthorpe Mr. H. R.	Norwich	..	1	1 0
Fernie Miss E.	North Walsham	..	1	1 0
Fielden Mrs. F.	Beechamwell Hall	..	5	0 0
Carried forward		546	2	0

JENNY LIND HOSPITAL

				£	s.	d.
	Brought forward	546	2	0
Finch Miss Constance	Norwich	1	1 0
Finch Mr. Charles H.	Costessey	1	1 0
Fitzgerald Mrs. E.	Framingham	1	1 0
Fitzgerald Miss Doreen	Framingham Earl	..		2 6
Fletcher Miss Betty Rivers	Norwich	10	0
Fletcher & Son, Ltd.	Norwich	5	5 0
Forrester Miss Alice	Norwich	1	1 0
Forrester Mr. J. B. (deceased)	Norwich	2	2 0
Forrester Mrs.	Norwich	1	0 0
Fox Miss	Norwich	2	2 0
Fox Mr. Alfred	Norwich	2	2 0
Fox Mr. J. H.	Norwich	3	3 0
Gardiner & Co., Messrs.	Norwich	10	6
Gardner Mr. C. E.	Norwich	1	1 0
Garland & Sons, Messrs.	Norwich	1	1 0
Gaul Mrs. Donald	Norwich	10	6
Gawne Mrs. Murray (deceased)	Swaffham	1	1 0
Gay Miss Ellen	Thurning Hall	..	1	1 0
Gay Miss M. and Master D.	Upton		5 0
George Messrs. Wm. & Sons	Norwich	10	10 0
George Mr. Cecil	Norwich		2 6
Gifford Mrs. A. B.	Norwich	1	1 0
Gilbert Mr. G. G. T.	Paignton	2	2 0
Gill Mr. S. T.	Norwich	2	2 0
Glover Mr. G. H.	Thorpe St. Andrew	..	1	0 0
Glover Mrs. T. (deceased)	Norwich	2	2 0
Goodchild Mr. Herbert	Norwich	1	1 0
Goodwin Mr. and Mrs.	Norwich		10 6
Goose Mr. A. W.	Norwich		10 0
Gorell Miss	Coltishall	2	2 0
Gould Mr. and Mrs. R. Pearce	Costessey	1	1 0
Gowen Mr. H. P.	Norwich	1	1 0
Gowing Miss Diana and Masters						
Eric and Michael	Lower Hellesdon	..		7 6
Gowing Mrs. F.	Lower Hellesdon	..	1	1 0
Gray Miss E. R. (deceased)	South Kensington	..	1	1 0
Green Mr. George (deceased)	Norwich	3	3 0
Green & Wright, Ltd.	Norwich	5	5 0
Grix Mr. J. W.	Oxnead	1	1 0
Gunton Miss ("In memory")	Norwich	1	1 0
Gurney Miss R. (deceased)	Eaton		10 0
Gurney Mrs. Reg.	Spixworth Hall..	..	1	1 0
Gurney Mr. W. S.	Runcton	1	1 0
Gurney Mrs. J.	Keswick Hall	3	0 0
Haldinstein Messrs. P. & Sons	Norwich	1	1 0
Hall Mrs. M. Percy	Gressenhall	1	1 0
Hall Mrs. W.	Kirby Bedon	1	1 0
Hall Mr. Wm.	Kirby Bedon	1	1 0
Hammond Mr. C. R. A.	Sprowston Grange	..	2	0 0
Carried forward		622	3	0

ANNUAL REPORT 1928

				£	s.	d.
	Brought forward	622	3	0
Hamond Mrs. C. A.	Twyford Hall	..	10	0
Hamond Rev. F. E.	Horning	..	10	0
Hancock Mr. J. H.	Norwich	..	2	2 0
Hanly Mr. Bernard	Norwich	..	1	1 0
Hanly Mrs. Bernard	Norwich	..	1	1 0
Hannent Mr. H. J.	Norwich	..	10	6
Hansell Miss Lucy (deceased)	Norwich	..	1	1 0
Hansell Mr. Walter E.	Norwich	..	1	1 0
Harbord The Hon. Doris	Guntton Park	..	10	0
Harbord The Hon. Lettice	Guntton Park	..	10	0
Hardy Mr. James	Thickthorn Hall	..	2	2 0
Harker Major William	Blofield Hall	..	5	5 0
Harker Mrs. William	Blofield Hall	..	5	5 0
Harmer Messrs. F. W. & Co.	Norwich	..	2	2 0
Harper Smith Mrs.	Norwich	..	1	1 0
Harper Smiths Messrs.	Norwich	..	2	2 0
Hart Mr. Henry	Norwich	..	1	1 0
Hart Mr. C. R.	Norwich	..	1	1 0
Hartcup Mr. J. L.	Norwich	..	2	0 0
Havers Messrs. Chas. & Son, Ltd.	Norwich	..	1	1 0
Havers Mr. W. W.	Norwich	..	1	1 0
Hedges Mrs.	Thorpe St. Andrew	..	5	0
Hedges Ernest and Celia	Norwich	..	2	6
Hedges Mr. S. W.	Thorpe St. Andrew	..	1	1 0
Henstead Union, Guardians of	Swainsthorpe (per Mr. W. E. Ripley)	..	5	5 0
Herring Mrs.	Narborough	..	1	1 0
Hicks Mr. Ernest	Wroxham	..	2	2 0
Hilder Mr. Geo.	c/o Barclays Bank Ltd.	..	10	6
Hill Mr. E. R.	East Dereham	..	1	1 0
Hill Col. S. G.	Norwich	..	1	1 0
Hill Mrs. H. E. Garerd	Norwich	..	1	1 0
Hinde Mr. C. Fountaine	Norwich	..	1	1 0
Hinde & Hardy, Messrs. Frs., Ltd.	Norwich	..	1	1 0
Hinde Mr. F. C.	Cringelford	..	1	1 0
Hine Mr. W. J.	Norwich	..	1	1 0
Hines Mr. E. E.	Norwich	..	1	1 0
Hobbis Master C. I.	Norwich	..	2	6
Hobrough Mr. J. S.	Norwich	..	1	1 0
Holmes Mr. H. N.	Norwich	..	3	3 0
Holmes Mr. Geoffrey N.	Hethersett	..	2	2 0
Holmes Mrs. M. M.	Strumpshaw Hall	..	2	2 0
Holmes Bros.	Norwich	..	10	10 0
Holt Visiting Society	per Mrs. A. Field, Holt	..	1	1 0
Horner Mr. and Mrs. Bassett	Norwich	..	2	2 0
Hornor Mr. Francis	Norwich	..	1	1 0
Hornor Mr. and Mrs. R.	Norwich	..	2	2 0
Horsfield Mr. Chas.	c/o Barclays Bank Ltd.	..	10	6
Hotblack Mrs.	Norwich	..	1	1 0
Carried forward				700	13	6

J E N N Y L I N D H O S P I T A L

					£	s.	d.
	Brought forward	700	13	6
Howard Messrs. A. S.	Norwich	..	1	1	0
Howard Mrs. H. J.	Norwich	..		5	0
Howes & Son, Ltd.	Norwich	..	2	2	0
Howlett Mr. A. G.	Thorpe St. Andrew	..	1	1	0
Howlett & White, Ltd.	Norwich	..	10	10	0
Howlett Mr. Neville	Norwich	..	1	1	0
Huggins Violet and Cyril	Norwich	..		10	0
Hurrell Mr. William	Norwich	..	2	2	0
Hutchinson Miss	Norwich	..		5	0
Imrie Mr. J. R.	Norwich	..	3	3	0
International Tea Stores, Ltd.	Norwich	..	2	2	0
Ives Mr. Chas. S.	Halesworth	..	1	1	0
Ives Mr. Robert	Erpingham	..	1	1	0
Ives Mr. F. Durrant	Erpingham	..	1	1	0
Jarrold & Sons, Ltd., Messrs.	Norwich	..	3	3	0
Jarrold Mr. and Mrs. T. H. C.	Thorpe St. Andrew	..	1	1	0
Jewson & Sons, Ltd.	Norwich	..	2	2	0
Jodrell Sir Alfred, Bart.	Bayfield Hall	..	2	2	0
Johnson, Burton & Theobald	Norwich	..	3	3	0
Johnson Rev. Herbert and Mrs.	Norwich	..		10	0
Johnson Mr. W. J.	Norwich	..	1	1	0
Jones Miss A. E.	Norwich	..	1	1	0
Keefe Mrs.	Norwich	..	1	1	0
Keefe Mrs. Ronald	Norwich	..		5	0
Kennett The Misses	Norwich	..	1	1	0
Kent Mr. Ernest A.	Norwich	..		10	0
Kenny Mr. D. S.	Hethersett	..		10	6
Keppel The Hon. Mrs. B.	Weston	..	2	2	0
Keppel Mrs. W. G.	Old Buckenham	..	1	1	0
King Mrs. A.	Norwich	..	1	1	0
King Messrs. Wallace, Ltd.	Norwich	..	3	3	0
Kirby Messrs. F. J., Ltd.	Norwich	..	5	5	0
Kitton Miss Alice	Norwich	..	2	2	0
Knight Mr. E., J.P.	Keswick Old Hall	..	1	1	0
Lack Mr. H.	Norwich	..	1	1	0
Lain Mr. S. E.	Norwich	..	1	1	0
Lambert F. & Son, Ltd.	Norwich	..	5	5	0
Lanchester Rev. C. C.	Norwich	..	1	1	0
Lang Mr. and Mrs. Gordon	Great Plumstead Hall	..	21	0	0
Larking & Larking	Norwich	..	1	1	0
Lees Mr. Mackenzie M.	Norwich	..	2	2	0
Lefroy Mrs. M.	Mitcheldean, Glos.	..	1	1	0
Liggat Mr. J.	Norwich	..	1	1	0
Leicester The Rt. Hon. the Earl of	Holkham	..	2	0	0
Lincoln Mr. John	Norwich	..	1	1	0
	Carried forward	798	18	0

ANNUAL REPORT 1928

				£	s.	d.
	Brought forward	798	18	0
Little Mr. Walter	Norwich	1	1 0
Littleboy Mrs. Noel A.	Norwich	1	1 0
Littleboy The Misses M. J. and Monica	Norwich	5	0
Littlewood Miss E. M.	Erpingham	1	1 0
Livock & Sons	Norwich	1	1 0
London & Norwich Press, Ltd.	Norwich	10	6
Loyal Gurney Lodge, Hethersett	(per Mr. W. H. Buckingham)	1	1	0
Loyal Norfolk Lodge, M.U.O.F...	(per Mr. B. A. Weeds)			
			(Paid in 1927) £2 2 0			
Mace Mr. Walter	Norwich	2	2 0
Machin Mr. W.	Norwich	1	1 0
Mack Mr. H. P.	Woodbastwick	2	2 0
Mackinnon Rev. Kenneth	Norwich	1	1 0
Mackley Mrs (for children)	Norwich	2	6
Macleane Mr. Colin	East Dereham	2	2 0
Mannall Mr. J. H.	Norwich	2	2 0
Mann, Egerton & Co., Ltd.	Norwich	3	3 0
Mansfields (Norwich), Ltd.	(per Mr. H. P. Gowen) ..	5	5	0
Marchesi Mr. L.	Norwich	1	1 0
Mark Messrs. W. D. & Son	Norwich	5	0 0
Marshall Mrs. H. S.	Rippon Hall	1	1 0
Martin Miss M. L.	Norwich	1	1 0
Mase Mr. W. G.	Cringleford	5	5 0
Maude Mrs. Raymond	London	2	2 0
May & Co.	Norwich	5	0 0
Mead Mr. P. J.	Norwich	10	6
Millard Miss A. J.	Norwich	10	6
Miller Mrs.	Norwich	10	6
Miller Mrs. B. M. F.	Norwich	1	1 0
Miller Mrs. W. O.	Fakenham	10	0
Millns Mr. W. J.	Norwich	1	1 0
Mills Mrs. Mealing	Norwich	10	6
Miller & Co.	Norwich	1	1 0
Mitford and Launditch Union	E. Dereham (per Mr. W. J. Barton)	2	2 0
Montague The Hon. Mrs.	Breccles Hall	2	2 0
Montgomerie Mrs. E. T.	Garboldisham Old Hall	..	1	1 0
Montgomerie Mrs. S.	Garboldisham Old Hall	..	1	0 0
Morgan's Brewery Co., Ltd.	Norwich	6	6 0
Morgan Mr. S. Anthony	Norwich	2	2 0
Morgan Mrs. B. B.	Norwich	1	1 0
Morgan Mr. F. W. W.	Norwich	2	2 0
Morris Mr. F. W.	Norwich	1	1 0
Morse Sir George	Thorpe	2	2 0
Morse Lady (In Memoriam)	Thorpe	3	3 0
Moxey Mrs.	Framingham Earl	10	0
Moyle Mr. S. N. Leonard	Norwich	3	3 0
Muriel Mr. Cecil J.	Norwich	2	2 0
	Carried forward		880	1	0

JENNY LIND HOSPITAL

					£	s.	d.
	Brought forward	880	1	0
Murray Mrs.	Norwich	5	0
Nash Mr. William	Norwich	1	1 0
Nash Mr. W. A.	Norwich	1	1 0
Nettlefold The Rev. J. K.	Thorpe	5	0 0
Neville Sir R. J. N., M.P.	Sloley Hall	3	3 0
Newman Mr. A.	Norwich	1	1 0
"Norfolk News" Company, Ltd.	Norwich	1	1 0
Norwich District M.U.I.O.F.	(per Mr. Basil Brown)	5	5 0
Norwich and East Norfolk Dist.
A.O.F.	(per Mr. G. F. Howard)	12	12 0
Norwich Co-operative Society, Ltd.	Norwich	10	10 0
Norwich Glass Co., Ltd.	Norwich	1	1 0
Norwich Town Close Estate
Charity	(per Mr. S. Cozens-Hardy)	6	0 0
Norwich Shoe Company	Norwich	5	5 0
Norwich Union Fire Insurance
Society, Limited	Norwich	5	5 0
Norwich Union Life Insurance
Society	Norwich	3	3 0
Norwich Guardians	(per Mr. F. E. Lyon)	6	6 0
Notley Miss Doris	Norwich	10	6
Overbury Miss Helen	Sheringham	1	1 0
Oetzmann Mrs.	Horning	1	1 0
Page Bros. (Norwich) Ltd.	Norwich	3	3 0
Page Mr. E. Bailey	Norwich	1	1 0
Page Mr. Frederick	Holt	1	1 0
Page Mr. J. J. G.	Norwich	1	1 0
Page Miss Marion	Blakeney	1	1 0
Palmer Mr. D. Hotson	Norwich	10	0
Pank & Son, Ltd., Messrs.	Norwich	3	3 0
Parker Mrs. R. E.	Marlingford	2	2 0
Parr Mr. W. H.	Great Yarmouth	1	1 0
Patteson Mrs.	Great Hautbois	3	3 0
Patrick Mr. W. I.	Norwich	5	5 0
Paul Mr. and Mrs. Noel	Norwich	1	1 0
Paul Mrs. W. E.	Norwich	10	6
Pelham Mrs. Sydney	Norwich	1	1 0
Petrie Mrs. E.	Heydon Hall	2	2 0
Piper Mrs. F. E.	Belaugh	1	0 0
Platten Mrs. Mary	Norwich	1	1 0
"Poet Cowper" Juvenile Lodge
Lodge of Oddfellows	(per Mr. H. Lowe, East Dereham)	10	6
Pollard Mr. J. E. T.	Norwich	5	0
Plumstead Mr. A. E.	Norwich	1	1 0
Plumstead Mrs. A. E.	Norwich	1	1 0
Pope Mrs.	Norwich	1	1 0
Carried forward	983	17	6

ANNUAL REPORT 1928

				£	s.	d.
	Brought forward	983	17	6
Porter Mr. and Mrs. James	..	Norwich	5	5	0
Poyton Miss	Norwich	1	1	0
Preston Mr. A. W.	Norwich	1	1	0
Preston The Misses	Norwich	1	1	0
Price Mr. Frank	Norwich	1	1	0
Priest Mrs. A.	Norwich	10	6	
Prior Mrs. Leathes	Norwich	1	1	0
Prior Mrs. M.	1	1	0
Proctor Mr. P.	Norwich	2	2	0
Pullen & Mase, Messrs.	Norwich	2	2	0
Raikes Mrs.	(per Mr. F. W. W. Morgan)	1	1	0	
Raikes Mrs. E. B.	Ham Common ..	1	0	0	
Raikes Miss R. M. B.	Ham Common ..	5	0		
Ralphs A. T. (Norwich), Ltd.	..	Norwich ..	2	2	0	
Ransome Mrs.	Hethersett ..	2	2	0	
Ranson Miss Annie	Driffield ..	1	1	0	
Read Mrs. R. J.	Norwich ..	5	0		
Reeve Edmund Mr.	Old Catton ..	1	1	0	
Rice Mr. A. A.	Cringleford ..	2	2	0	
Rice Dr. David	Hellesdon Mental Hospital	1	1	0	
Riley Mr. Walter	Norwich ..	1	1	0	
Ringer Miss G.	Norwich ..	1	1	0	
Robertson & Colman, Ltd.	..	Norwich ..	1	1	0	
Robinson Mrs. L.	London ..	2	2	0	
Robinson Miss	Norwich ..	2	6		
Rossi Mr. Theodore	Norwich ..	1	1	0	
Rosson Mr. C. S.	Norwich ..	1	1	0	
Rout Mr. John	Norwich ..	1	0	0	
Rowley Mr. A. H. A.	Norwich ..	1	1	0	
Rudd Mrs. E. M.	Norwich ..	1	1	0	
Rudd Mrs. N. B.	Norwich ..	1	1	0	
Ruypm Messrs. R. R. & Son	..	Norwich ..	1	1	0	
Sadd Mrs.	Norwich ..	1	0	0	
Salmon Mr. A. H.	Norwich ..	1	1	0	
Sandford Mr. J. E. C.	Norwich ..	1	1	0	
Sayer Mrs. F.	Northwood ..	2	2	0	
Scarles Mrs.	Norwich ..	5	0		
Scott Mr. and Mrs. W. H.	..	Norwich ..	5	0	0	
Scrimshaw Mr. A. E. J.	Norwich ..	1	1	0	
Sedgwick Mr. John S.	Norwich ..	1	1	0	
Seed Mr. E. A.	Norwich ..	2	2	0	
Seed Miss Mary	Norwich ..	2	6		
Sennitt Mr. E. C.	Norwich ..	2	2	0	
Sennitt Mrs. E. C.	Norwich ..	1	1	0	
Sewell, Breton and Gowing	..	Norwich ..	1	1	0	
Sewell Mr. J. W.	Saxlingham, Thorpe	2	2	0	
Sexton Mr. J. H.	Norwich ..	6	6	0	
	Carried forward	1052	4	0

JENNY LIND HOSPITAL

				£	s.	d.
	Brought forward	1052	4	0
Sexton Fred (Norwich) Ltd.	..	Norwich	5	5 0
Sexton, Son & Everard, Ltd.	..	Norwich	10	10 0
Seymour Col. C. D.	..	Barwick	3	0 0
Shave Mr. W. P. (deceased)	..	Norwich	1	1 0
Shead Mr. G.	..	Norwich	1	1 0
Shead Mrs. G. W.	..	(per Mr. G. Shead)	1	1 0
Sheringham Co-operative Society		(per Mr. J. H. Porter, Sheringham)	1	1 0
Shildrake Mrs. A.	..	Norwich	1	1 0
Simpson Mr. E. P. (deceased)	..	London	1	1 0
Skelton Mr. Geoffrey	..	Trimingham	1	1 0
Skelton Messrs. J. & Son, Ltd.	..	Norwich	5	5 0
Skelton Mr. Russell	..	Norwich	1	1 0
Skène Miss Maisie (in memoriam)		Sutton	5	0
Skène Master Nigel	..	Sutton	2	6
Skène Miss Rosalys	..	Sutton	2	6
Skipper Mr. F.	..	Norwich	1	0 0
Smallburgh Union, per Mr. Fairfax Davies	..	North Walsham	5	5 0
Smith Mr. William	..	Norwich	1	1 0
Smith Mr. F. A.	..	Norwich	2	2 0
Smith Mr. G. Merriken	..	Norwich	1	1 0
Smith Geo. (Norwich) Ltd.	..	Norwich	3	3 0
Smith Mr. and Mrs. Harold E.	..	Ipswich	1	1 0
Smith Masters Reg. and Martin	..	Ipswich	1	1 0
Smith Colonel H. F.	..	London	2	2 0
Smith Mr. Hedley H.	..	Norwich	1	1 0
Smith Mr. Walter	..	Norwich	1	1 0
Smith-Boughen, Ltd.	..	Norwich	1	1 0
Smith Mr. Edmund	..	Norwich	1	1 0
Snelling Mrs. A. T.	1	1 0
Snelling Mr. F. W.	..	Norwich	1	1 0
Soman A. E. & Co., Ltd.	..	Norwich	1	1 0
Southall James & Co., Ltd.	..	Norwich	10	10 0
Southwell Mr. E. B.	..	Norwich	2	2 0
Spalding Mr. Gerald	..	Norwich	5	0
Spalding Mrs. J. C.	..	Norwich	10	6
Spalding Miss E.	..	Norwich	10	6
Spelman Mr. W. W. Rix	..	Norwich	2	2 0
Spurgeon Miss	..	Norwich	5	0
Sproul Miss Kate	..	Norwich	1	1 0
Spurrell Mrs. V. M.	..	St. Faith's	1	1 0
St. Faith's Union, Guardians of		(per Mr. Chas. Row)	5	5 0
Standley Mr. H. P.	..	Norwich	1	1 0
Steele Mrs. G.	..	Bath	1	1 0
Stevenson Mrs.	..	Norwich	10	6
Steward & Patteson, Ltd.	..	Norwich	5	5 0
Steward Rev. Herbert	..	Hethel Rectory	2	2 0
Stimpson Mrs. A.	..	Norwich	1	1 0
Carried forward	1144	17	6

ANNUAL REPORT 1928

			£	s.	d.
	Brought forward	1144	17	6
Stimpson Ben, Betty, and George	Salle Moor Hall	1	0	0
Stockings Miss A. A.	Norwich	10	0	
Stockings Messrs. Jack, Mark, and Miss Nisda	Norwich	1	0	0
Stratford Mr. and Mrs. Claude	Norwich	1	1	0
Stratford Master J. and Miss Una	Norwich	10	0	
Suffield The Dowager Lady	Harbord House	2	2	0
Supple Rev. W. R.	Thorpe Rectory	1	1	0
Surrey Street Chapel Sunday School	(per Mr. Sawyer)	2	10	0
Sutton Mr. S. R.	Wroxham	1	0	0
Sutton Mr. W. Lincolne	Norwich	1	1	0
Sutton Mr. A. D.	Norwich	1	1	0
Sutton Mr. B. C.	Freethorpe	1	1	0
Sutton Mr. Myrus	Halvergate	1	1	0
Tacon and Cowell	Norwich	15	0	
Tatham Mrs.	Norwich	10	6	
Taylor Mr. Alfred (deceased)	Starston	1	1	0
Taylor Mr. H. E.	Norwich	1	1	0
Taylor Messrs. G. & Son	Norwich	1	1	0
Taylor Mrs. E. Johnson	Norwich	2	2	0
Theobald Mr. and Mrs. George	Norwich	10	6	
Theobald Master J.	Norwich	5	0	
Thomas Mrs. G. de V.	Hollingborne	10	6	
Thompson & Sons, Ltd.	Norwich	1	1	0
Thorndick & Dawson, Bros.	Norwich	10	6	
Thorns R. E. & Co.	Norwich	1	1	0
Thorold Mr. W. J. C.	Norwich	1	1	0
Thouless Mr. H. J.	Norwich	10	6	
Thouless Mrs.	Norwich	1	1	0
Thouless Mrs.	Wroxham	1	1	0
Thurston Mrs. Charles	Norwich	1	1	0
Tillet Mr. Louis J.	Buxton Lamas	1	1	0
Tillett Miss Iris	Norwich	2	6	
Tillett Master Norman	Norwich	2	6	
Tingey Mr. J. R.	Longham Hall	10	6	
Todhouse, Reynard & Co., Ltd.	Norwich	2	2	0
Townshend Mr. & Mrs. S. G.	Norwich	1	1	0
Trafford Lady Betty	Wroxham Hall	5	0	0
Trotter Mrs. E. B.	Norwich	2	0	0
Turner Mr. T. W. D.	Burnham	1	1	0
Tyce Mrs. H.	Norwich	1	1	0
Tyce Mr. George	Norwich	1	1	0
Unthank Col. C. W. J.	Intwood Hall	1	1	0
Upcher The Misses	Sheringham Hall	2	0	0
Upcher Rev. A. C. W.	Sheringham	10	0	
Upcher Mrs. H. E. S.	Upper Sheringham	2	2	0
Carried forward			1195	14	6

JENNY LIND HOSPITAL

					£	s.	d.
	Brought forward	1195	14	6
Upcher Miss Cyrilla	Dunham Magna	..		2	6
Upcher Miss Mildred	Dunham Magna	..		2	6
Upcher Miss Rosamund	Dunham Magna	..		2	6
Varnon Mr. and Mrs. C. A.	Norwich	..	3	3	0
Vince Mr. H. J.	Norwich	..		10	6
Vincent Sir Francis and Lady	Ormesby	..	5	0	0
Vlasto Mr. S. A.	Saxlingham Nethergate		1	1	0
Wales Mr. H. E.	Norwich	..		10	6
Walker Miss Jean	Norwich	..	1	1	0
Waller Mrs.	Norwich	..	2	2	0
Walsingham Union of Guardians			(per Mr. R. S. Butcher)		2	0	0
Walter Major Cyril	Drayton Old House	..	4	4	0
Walter Miss Cyril	Drayton Old House	..	2	2	0
Walter Miss Mary	Drayton	..		10	0
Walter Miss Evelyn	Drayton	..		10	0
Walker Miss Agnes	Norwich	..		10	6
Walker Miss C.	Norwich	..		10	6
Ward Mr. A. W.	Norwich	..	1	1	0
Ward Mrs. E. Foote	Salhouse	..		10	6
Warren Mr. J. William	Norwich	..	1	1	0
Waters Miss	Postwick	..	1	1	0
Waters Mr. and Mrs. F.	Smallburgh	..	3	3	0
Waters Mr. H. J.	Norwich	..	2	2	0
Waters Master Harry	Norwich	..		5	0
Waters Master Jim	Norwich	..		5	0
Waters Master John	Norwich	..		5	0
Watson Dr. Ernest I.	Norwich	..		10	6
Wayland Union of Guardians	(per Mr. A. A. Gompertz)		4	4	0
Wearing Mr. S. J.	Norwich	..	1	1	0
Webster Messrs. W. C. & Sons	Norwich	..	5	5	0
Webster Mrs.	Eaton Vicarage	..	1	1	0
Wenn Mrs.	Walcot	..	2	2	0
Wharton Mr. J. R.	Wymondham	..	1	1	0
Wheeler Mrs. H.	Norwich	..		10	6
White Mr. G. E.	Norwich	..	2	2	0
White Mrs. G. E.	Norwich	..	1	1	0
Whitcar Mr.	Norwich	..	1	0	0
Wigan Lady	Horstead Hall	..	2	2	0
Wild Mr. Edward (deceased)	Norwich	..	3	3	0
Wilford Mr. G. L.	Hellesdon	..	1	1	0
Wilkinson Messrs. & Son	Norwich	..	1	1	0
Wilkinson Mrs. J.	North Walsham	..		10	6
Wiley Mr. J. N.	Little Plumstead	..	1	1	0
Williamson Mr. E. F.	Norwich	..	1	1	0
Williams Mr. Hanbury	Norwich	..	1	1	0
Willis Miss E. L.	Norwich	..		10	6
Willis Miss Mary E. C.	Norwich	..	1	1	0
Carried forward					1262	0	6

ANNUAL REPORT 1928

				£	s.	d.
	Brought forward	1262	0	6
Wilson Mr. Cecil	Thorpe St. Andrew	..	1	1 0
Wilton Mr. H. G.	Norwich	..	1	0 0
Winter Rev. C. H.	Aylsham	..	1	1 0
Winter Mr. P. S.	Norwich	..	1	1 0
Winter Miss Mary	Norwich	..		2 6
Witton Mr. Arthur E.	Norwich	..	2	2 0
Witton Mr. Edward	Garboldisham	..	1	1 0
Witton S. L., Ltd.	Norwich	..	5	5 0
Woolsey Miss	Sea Palling	..		10 0
Woolsey Miss Patience	Catton	..		5 0
Woolsey Mr. G. E. W.	Catton	..	3	3 0
Wright Dr. B. D. Z.	Hoveton St. John	..	2	2 0
Wright Mr., F.R.S.	Wighton	..	1	1 0
Youngs Mr. A. J.	Norwich	..	1	1 0
Youngs Mr. J. B.	Norwich	..	1	1 0
Youngs Mr. John (deceased)	Norwich	..	5	0 0
Youngs, Crawshay, & Youngs, Ltd.	Norwich	..	5	5 0
				1294	2	0

Gifts of Books, Clothing, Concert Tickets, Eggs, Fruit, Game, Recommendations, Toys, Etc.

A

Countess of Albemarle, Mr. Algar, Mr. W. Allott, Messrs. Allen and Hanbury, Mrs. W. H. Andrews, Miss Betty Abel, Mrs. P. H. Allerton, Mrs. Applethwaite, Anonymous, Mr. and Mrs. W. J. Algar, Mr. R. J. Adcock, The Amalgamated Press, Attleborough Church Children, Aldborough Church Children of the Catechism.

B

Mrs. Bryan, Mrs. Bidwell, Mr. T. B. Brittan, Mrs. Boardman, Miss Betty Barnham, Sir Maurice Boileau, Mr. Richard Bullen, Garth Blanchflower, Miss Betts, Mrs. Banham Mrs. and Miss Brenner, Colonel Barclay, Mr. Barclay, Mrs. Beck, Mrs. Barber, Miss Busuttil, Mrs. Buckingham, Mrs. Baldwin, Mrs. E. Bennett, Mrs. Bullard, Mrs. Burton Marshall, Mrs. Bean, Mrs. J. A. Brooke, Miss Sylvia Bloomfield, Miss Bullard, Mrs. Boswell, Peter and Pamela Bishop, Bernard Beeston, Miss Ruby Beeston, Mrs. Buckingham, Messrs. Buntings, Messrs. Boots, Dr. Blyth, Mr. J. Rayner Brooks, the Misses Baly and Owles, Mr. W. H. Bolton, Rev. Bernard Barton, Messrs. Boulton and Paul, Mr. A. J. Burrell, Mr. H. O. Bennett, Messrs. Winsor Bishop and Co., Dr. S. H. Burton, Mr. A. B. Bell, Messrs. Bowhill and Elliott, Blofield Brownies, Boys' School Wymondham, Bawburgh Church, Belvoir Street Sunday School, Burgh Junior Bible Class, Billingford Church, Brooke Church, Bixley Church, Bowers Masonic Lodge, Besthorpe Children, Barsham Women's Institute, Boys' Club Pulham Market.

C

Mr. and Mrs. Copeman, The Misses Colman, Miss Helen Colman, Messrs. A. J. Caley, Mrs. Coe, Miss Eileen Cook, Mr. and Mrs. H. J. Copeman, Geoffrey Carrick, Miss Colman, Miss M. E. Colman, Mr. J. H. Colman, Miss Enid Cook, Miss Chapman, Messrs. Colman and Company, Mrs. McColman, Mrs. Cozens-Hardy, Mrs. Chamberlin, Mrs. Cole, The Rev. E. A. B. Creed, Mrs. C. Charles, Mr. Carruthers, Mrs. Crane, Mrs. W. R. Cooper, Mr. Alan Colman, Mr. Copeman, Mrs. Cooke, Mrs. Clements, Mrs. Cooper (Bury St. Edmunds), Miss Copping, Chamberlins Limited, Mr. Percy E. Curl, Mrs. E. M. Currie, Mrs. A. M. Clarke, Mr. Wm. Churchyard, Mr. I. J. Church, Messrs. A. E. Coe and Sons, Mrs. A. R. Chamberlin, City Station Ambulance Corps, Christ Church, Children of St. Thomas Church, Children's Egg Service, Stibbard, Cedar House School, Clippesby Church, Carleton St. Peter, Old Catton Church, Carrow Sunday School, Christ Church Eaton, Claxton Church, Caister Church, Colney Church, Cringleford Church, Christ Church New Catton, Old Catton Women's Institute, Children of Miss Copeman's Class, Cringleford Women's Institute.

D

Miss Dennison, Mrs. Dyer, Mrs. Duncan, Mrs. DeCaux, Mr. Davies, The Rev. G. E. Dawson, Mrs. Denny, Miss Kathleen Davis, Miss Betty Drury, Miss J. Diver, Mr. H. C. Davies, Mrs. L. M. Denny, Mr. H. E. Dyball, Diss Brownie Pack, Diss Wesleyan Church, Deopham and Hackford Church Sunday School, Diss Wesleyan Sunday School, Dereham Road Baptist Church, Drayton Women's Institute.

E

Mrs. Evans, Miss K. Eastoe, Mrs. F. R. Eaton, Mrs. A. W. Everett, Mr. Eagleton, Messrs. Edwards and Holmes (Workpeople), Messrs. Edwards and Holmes, Miss A. E. Egmores, Eaton Grange School, Eccles Road Pound Sunday, Eaton Church, Eccles Church, Elsing Church, Great and Little Ellingham King's Messengers, Earlham Drapery Stores, "Eastern Daily Press."

F

Mrs. Fielden, Mrs. Frere, Mr. A. A. F. Fredman, Miss E. Fernie, Mr. W. J. Fanning, Mrs. Frances Fielden, Miss C. Fox, Mr. A. Fox, Mr. J. H. Fox.

G

Miss Griggs, Mrs. Goresley, Margaret Gostling, Mrs. Gedge, Mrs. Greenland, Messrs. Goose and Son, Ltd., Miss Ellen Gay, Mrs. Green, Messrs. W. Gaymer Limited, Miss Rhoda Gemmer, Girl Guides per Miss Neville, Messrs. Green and Wright, Geldeston Children, G. F. S. Pulham Market, Great Plumstead Church, Great Ryburgh Wesleyan Sunday School, Great Snoring Church, Garboldisham Church, G. F. S. Strumpshaw, G.F.S. Candidates per Miss Barnes, G.F.S. Salle.

H

Mrs. H. Hancock, Maynard Hazelrigg, Hockham Women's Institute, High School, Misses Hamond, Mr. Hingman, Mrs. Hornor, Mrs. Harker, Mrs. Haddow, Mrs. Hancock, Mr. Harker, Miss Hubbard, Mrs. Hemingway, Mrs. C. B. Hill, Misses F. M. and L. Hastings, Mrs. Basset Hornor, "H.R.," Miss Hipperson, Mrs. Hill, Miss Hopper, Miss Harper, Mrs. Holmes, Miss Mary Holmes, Mrs. Heseltine, Miss Judith Heseltine, Miss Harrison, Kathleen Howes, Peter Roy and Dick Howes, Mr. Hopper, Mrs. Heard, Mr. Stanley Howes, Mr. H. N. Holmes, Mrs. G. F. Holmes, Mr. E. E. Hines, Miss S. L. Hutchinson, Mrs. J. Hurst, Mr. C. R. Hart, Mr. W. W. Havers, Mr. and Mrs. Hanly, Mr. S. W. Hedges, Mr. Geoffrey N. Holmes, East Harling Church, Holy Trinity Church, Horsford Church, Hickling Church, Hibbard Church, Heydon Church, Hardingham Church, Heigham Church Scouts and Cubs, Hevingham Women's Institute, Hethersett Children's Service, Holy Trinity Church Children, 1st Happisburgh Pack of Cubs, Hoveton St. John's Women's Institute, East Harling Church.

J

Mrs. George Jewson, Mrs. Jefferies, Mrs. Johnson, Miss Gladys Johnson, Mr. J. H. Jewson, Miss Betty Johnson, Miss A. E. Jones, Junior Red Cross St. Miles School. "Jenny Lind House" Beech Hill Girls School, Luton.

JENNY LIND HOSPITAL

K

H.M. The King, Mrs. Watson Kennedy, Mrs. Keightley, Mr. King, Mrs. Kendall, Mrs. King, Mr. Belson King, Miss Edna Kay, Messrs. J. F. Kirby, Ltd., Messrs. Wallace King, Ltd., Messrs. T. C. R. King & Son, Mr. E. J. P. Knight, Miss E. Kirk, Kirby Bedon Church, Kenninghall Children.

L

The Lord Mayor (Mr. H. E. Witard), The Lady Mayoress, Lonsdale House School, Mrs. Love, Mrs. Lane, Miss Ursula Lee, Mr. A. E. Laurance, The Misses Lovett, Mr. Loose, Mr. Gordon Lang, A Late Well Wisher, Mrs. Lusher, Nurse Lincoln, Mr. H. Lack, Mr. Lusher, Mr. Walter Little, Mr. J. Lincoln, Mrs. F. E. Littleboy, Little Snoring Church, Little Plumstead Church, Langham Church, Lyng Church, Lyng Women's Institute, Ludham School.

M

Miss Barbara Moxey, Lady Morse, Miss Millard, The Misses Mitchell, Dr. and Mrs. Morgan, Geoffrey Morris, Nora Morris, Gerald and Vivian Moyle, Mrs. Mahon, Mrs. Moll, Mrs. Morse, Miss Jennifer Moyle, Mr. Millard, Miss E. H. Moore, Mrs. Maw, Miss Merriman, Mrs. Raymond Maude, Mrs. Montague, Mrs. Moore, Miss Mack, Mrs. More, Joan, Jane, and Barbara May, Mr. W. Machin, Mrs. M. E. Meade, Messrs. Miller and Co., Mr. H. P. Mack, Mulbarton Church, Scholars of Magdalen Road Congregational Sunday School, Little Melton School, Municipal Secondary School, Some Mothers of Honingham.

N

The Misses Margrette and Joan Newhouse, Miss M. North, Miss Nelson, Mr. Frank Neave, Mr. A. Newman, North Walsham High School, Norfolk Motor Club, Norwich 11 Young People of Salvation Army, Nelson Street Infant School, The Nave Service, Naval and Military Masonic Lodge, 19th Norwich Scouts and Cubs, 2nd Norwich Group of Wolf Cubs, Norfolk Women's Institute.

O

Mrs. Oakley, Mr. and Mrs. Ernest Oetzmman, Mrs. Oldham, Orford Hill Sunday School.

P

Evelyn and David Prichard, Mr. Pordage, Mrs. H. Peacock, Miss Pate, Mrs. E. Pordage, Mrs. Porter, The Premiere Polish Co., Mrs. Porter and her Working Party, Mrs. Plummer, Mr. Peart, Mrs. E. Pillow, Mrs. Philo, Mr. Proctor, Mrs. Frank Price, Messrs. Pordage and Co., The Misses L. A. Preston, Mrs. J. Pilling, Miss M. Poyton, Mrs. E. Petrie, Mr. and Mrs. J. R. W. Pigott, Mr. C. H. Pitt, Mr. A. W. Preston, Mrs. C. S. Pown-Jones, Perseverance Lodge of Freemasons, Park Lane Sunday School, Postwick Sunday School, Poringland Sunday School, Pottergate School, Poringland Women's Institute, Pottergate Street Sunday School, Pulham Market Church.

Q

H.M. The Queen, Quidenham Church.

R

Miss Rose, Miss K. Rothwell, Mr. A. Roe, Miss Russell, The Directors of Robertson & Colman, Ltd., Mr. Rolfe, The Religious Tract Society London, Mrs. Reeve, The Rosa Doll Society, Mr. Rose, Mrs. Rant, Mrs. Richardson, Mrs. W. B. Rutland, Messrs. Robertson & Colman, Ltd., Mrs. Rivett, Mr. C. S. Rosson, Dr. E. B. Roche, Mrs. E. M. Rudd, Miss A. Ranson, Mr. E. Reeve, Rockland All Saints Church, Reepham Road Sunday School.

S

Mr. George Smith, Miss Sexton, Mr. Seago (Norwich Egg Week), Mrs. Sharp, Betty Smith, Mrs. Smith, The Swan Laundry, Miss Southall, Miss Stimpson, Captain Sandys Winsch, Mrs. Smedley Beck, Mrs. Stimpson, Mrs. Simms Reeve, Mr. and Mrs. Harper Smith, Mr. G. Smith, Mr. H. Smith, Mr. Sennitt, Sister Emily, John and Una Stratford, Mrs. Smith, Shropham King's Messengers, The Rev. H. Steward, Mr. G. W. Shead, Mr. G. J. Smith, Mr. G. Merriken Smith, Mr. Harold E. Smith, Reginald and Martin Smith, Miss K. Sproul, Mrs. A. T. Snelling, Mrs. O. Snelling, Mrs. A. C. Sadd, Mr. G. Skelton, Mr. E. C. Sennitt, Mr. J. H. Sexton, George Storey, George Hobart and Albert Alcock, Mr. W. Lincolne Sutton, Mrs. Scott, Sincerity Lodge of Freemasons, Silver Road Sunday School, Sportmen's Angling Club, St. Matthews Church Thorpe Hamlet, Spixworth Church, St. Michael's Church, St. Margaret of Antioch Sunday School Seething, St. Saviour's Fête, St. Cuthbert's Church Sprowston, Silver Road Baptist Sunday School, St. Michael's Church Hockering, St. Mary's Baptist Sunday School, Senior Department St. Mary's Baptist Church Sunday School, St. Saviour's Girls' School, Shotesham Church, St. Catherine's Church, St. Paul's Chapel Honingham, Salvation Army Citadel, St. Andrew's Church, Themelthorpe, St. Clements and St. George's Churches, St. Peter Mancroft Church, St. Marks Church Lakenham, Scole Church, St. Peter Mountergate Church, St. Augustine's School, St. Giles Masonic Lodge, St. Monica's School, Stalham Church, Strumpshaw G.F.S., Seething School Children, Saxlingham Girl Guides, Sun Lane Sunday School, St. Alban's Church, St. Mary's Church, North Tuddenham. Sprowston Church Sunday School.

T

Mrs. Trevor, Mr. and Mrs. S. G. Townshend, Lady Betty Trafford, Paul Turner, T.N.C. and Sunshine Committee, Mr. Turner, Mr. Johnson Taylor, The Telegraph, Mrs. H. Tyce, Mr. H. E. Taylor, Messrs. Todhouse, Reynard & Co., Ltd., Mr. T. W. D. Turner, Messrs. G. Taylor and Son, Mr. E. B. Trotter, Taverham Church.

U

United Free Methodist Sunday School, Unthank Road Baptist Church Sunday School, Union Lodge of Freemasons, Miss Utting.

JENNY LIND HOSPITAL

V

Mrs. Varnon, Sir Francis Vincent.

W

Mrs. Walter, Mrs. Waller, Messrs. F. W. Woolworth, Miss Willis, The Misses Willis, Mrs. Wiley, Mrs. Webb, Mr. Windridge, Lily Wright, Mrs. Woolsey, Mrs. R. Watling, Miss Wright, Mrs. Whitaker, Mrs. White, Mrs. Ward, Lady Wigan, Eric Owen, Hugh, Kenneth and Gwen Williamson, Mrs. S. A. Walter, Mr. F. Waters, Mr. G. E. W. Woolsey, Major Cyril Walter, Mrs. M. A. Walter, Mr. H. L. Webster, Mrs. M. E. Waller, Wymondham School, Wymondham Congregational Church, Women's Institute, Weston Longville Church, Walsingham Women's Institute, Wensum Women's Hour, Children of Wells Church, Wortwell Women's Institute.

Y

Mr. John Youngs, Mr. J. B. Youngs, St. Peter's Church, Yaxham.

FORM OF LEGACY

£ £

I BEQUEATH to the TREASURER for the time being of the
JENNY LIND HOSPITAL the sum of Pounds,

free of duty, to be applied to the general purposes of the said Hospital,
AND I DECLARE that the receipt of the TREASURER for the time being
of the said Hospital shall be sufficient discharge for the same.





*A Legacy or Donation
of £500
will Endow a Cot*

3

*A Yearly Subscription
of £30
will Support a Cot*