

Annual report : 1940 / St. John's Hospital, Lewisham.

Contributors

St. John's Hospital (Lewisham, London, England)

Publication/Creation

[London] : [publisher not identified], 1940

Persistent URL

<https://wellcomecollection.org/works/bb3fx2h2>

License and attribution

This work has been identified as being free of known restrictions under copyright law, including all related and neighbouring rights and is being made available under the Creative Commons, Public Domain Mark.

You can copy, modify, distribute and perform the work, even for commercial purposes, without asking permission.



Wellcome Collection
183 Euston Road
London NW1 2BE UK
T +44 (0)20 7611 8722
E library@wellcomecollection.org
<https://wellcomecollection.org>

Library

St. John's Hospital, Lewisham

(INCORPORATED)

MORDEN HILL, S.E.13

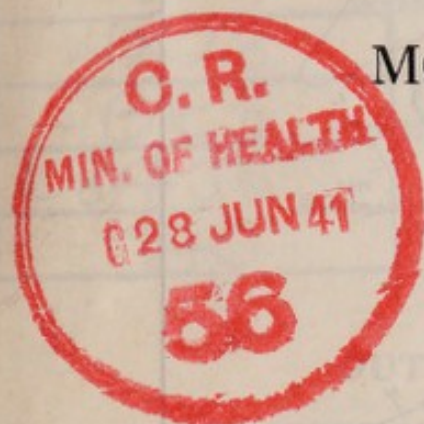

FIFTY-SEVENTH ANNUAL REPORT

*From 1st January to
31st December, 1940*

Established on Morden Hill in 1883 for the treatment
of the Sick Poor

NO LETTERS REQUIRED

ST. JOHN'S HOSPITAL.
LEWISHAM, SE
(INCORPORATED)

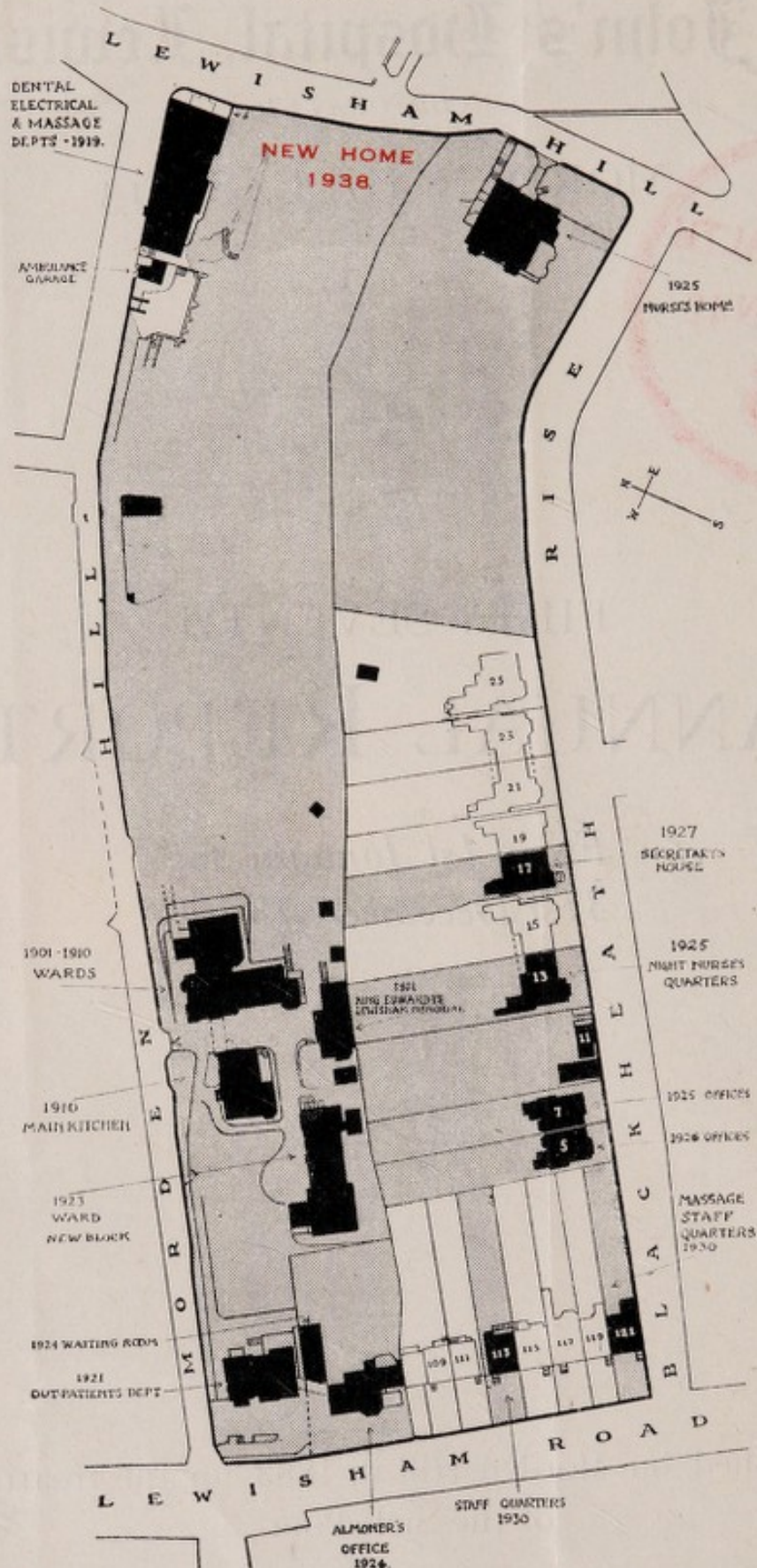

22501364234

WELLCOME	
LIBRARY	MEN
Ann Rep	WOMEN
WX28	
BE5	CHILDREN
L84J65	
1940	

WARDS.

Victoria.
Herbert Burton.
Gertrude.
Talbot.
Theresa.
Angela.

SIX PRIVATE ROOMS.**OUT-PATIENT DEPARTMENT.****SPECIAL CLINICS for :—**

Diseases of the Ear, Nose and Throat.
" " Eyes.
Urological Diseases.
Gynæcological "
Venereal "
Skin "
Children's "
Psychological "

Facilities for Electrical and Massage Treatment.

" X-Ray Treatment.
" Dental Treatment and Dentures.
" Orthopædic Treatment.
" Electro-cardiographic Examinations

In addition there are

Completely equipped Laboratories for Pathological and Bacteriological Examinations.

VISITING DAYS

SUNDAYS & THURSDAYS.. .. All Wards, 2-4 p.m.
Women's Wards — Daily, except Thursday and Sunday, 8-8.30 p.m.
Men's Wards — Daily, except Thursday and Sunday, 3.30-4 p.m.

TELEPHONES :

LEE GREEN 3411, 3412, 3413. Private Branch Exchange.

OFFICERS OF THE HOSPITAL.

Patron :

H.R.H. PRINCESS ARTHUR OF CONNAUGHT.

President :

EARL OF DARTMOUTH, G.C.V.O., T.D.

Hon. Treasurer :

Trustees :

THE OFFICIAL TRUSTEES OF CHARITABLE FUNDS.

Court of Governors :

Chairman .. Captain SIR WILLIAM BRASS, M.P.

Vice-Chairman J. TEMPLE MOORE.

C. H. ANDREWS, M.B.E.

CHARLES BENEY, M.A., M.B., B.CH. (CAMB.), M.R.C.S. (ENG.)

L. E. BERMAN, B.A.

GUY DURNFORD.

G. L. EDWARDS.

H. ETHERINGTON, A.S.A.A., A.C.I.S.

Rev. CANON F. H. GILLINGHAM, B.A.

W. J. HARRIS, M.B.E.

Alderman E. W. HAYES.

A. E. KIMPTON, O.B.E.

F. MEAD.

C. MEADOWS-RYLEY, M.B., B.CH. (CAMB.), M.R.C.S., L.R.C.P.

Rev. F. J. MILLER.

J. W. MILLER, M.B., CH.B., D.P.H., Medical Officer of Health for Lewisham.

HIS WORSHIP THE MAYOR OF LEWISHAM.

W. OFENHEIM.

Alderman A. E. WEBB.

H. M. M. WOODWARD, M.A. (OXON.), M.R.C.S., L.R.C.P.

Honorary Solicitor :

GUY DURNFORD,

Messrs. DURNFORD & SON, 9, King's Bench Walk, E.C.4.

Auditors :

J. L. HARPER LAMAISSON & Co.,

Chartered Accountants,

Sevenoaks, Kent.

Bankers : BARCLAYS BANK, LIMITED (Lewisham Branch).

Secretary Superintendent : J. C. GILBERT, A.H.O.A.

Accountant : E. A. STURT,

HONORARY MEDICAL STAFF

Consulting Physicians :

H. CORRY MANN, O.B.E., M.D. (LOND.), M.R.C.P.
A. HOPE GOSSE, M.A., M.D. (CAMB.), F.R.C.P.
J. J. CONYBEARE, M.D. (OXON.), F.R.C.P.

Consulting Surgeons :

SIR ARBUTHNOT LANE, Bart., C.B., M.S. (LOND.), F.R.C.S.
HAROLD CHAPPLE, M.A., M.B., M.CH. (CAMB.), F.R.C.S.
F. D. SANER, M.B., B.CH. (CAMB.), F.R.C.S.
FRANK COOK, B.SC., M.B., B.S. (LOND.), F.R.C.S.
A. C. MORSON, O.B.E., F.R.C.S.
G. F. GIBBERD, M.S. (LOND.), F.R.C.S.

Consulting Dermatologist :

W. N. GOLDSMITH, M.D. (LOND.), F.R.C.P.

Consulting Psychological Physician :

M. MACKENZIE, M.D. (LOND.), M.R.C.P.

Consulting Ophthalmic Surgeon :

H. LIGHTFOOT EASON, C.B., C.M.G., M.D., M.S. (LOND.), F.R.C.S.

Physicians :

P. FIGDOR ASHTON, M.B., CH.B.
J. R. B. HERN, M.A., M.D. (OXON.), M.R.C.P.

Surgeons :

N. ECKHOFF, M.S. (LOND.), F.R.C.S.
K. HERITAGE, M.S. (LOND.), F.R.C.S.

Assistant Surgeon :

D. BARLOW, M.S. (LOND.), F.R.C.S.

Dermatologist :

G. DUCKWORTH, M.R.C.P. (LOND.).

Department of Psychological Medicine :

B. CATES, M.R.C.S., L.R.C.P., D.P.M.

Electro-Therapeutic Department :

P. FIGDOR ASHTON, M.B., CH.B.

Aural and Throat Department :

J. W. HARRISON, L.M.S.S.A.
CHARLES BENEY, M.A., M.B., B.CH. (CAMB.), M.R.C.S. (ENG.).

Urological Department :

H. P. WINSBURY-WHITE, M.B., CH.B., F.R.C.S.

Ophthalmic Surgeon :

C. MEADOWS-RYLEY, M.B., B.CH. (CAMB.), M.R.C.S., L.R.C.P.

Assistant Ophthalmic Surgeon :

A. G. LUMSDEN, M.B., CH.B.

Orthopædic Department :

A. T. FRIPP, B.CH. (OXON.), F.R.C.S.

Gynæcological Department :

E. H. ROBERTS, M.B., B.S., F.R.C.S.E.

J. B. BLAICKLEY, F.R.C.S.

Diseases of Children :

R. H. DOBBS, B.A., M.B., B.CH. (CAMB.), M.R.C.P.

Venereal Diseases Department :

H. M. M. WOODWARD, M.A. (OXON.), M.R.C.S., L.R.C.P.

R. S. RALPH, M.R.C.S., L.R.C.P., D.P.H.

Pathologist :

ARTHUR DAVIES, M.D. (LOND.), M.R.C.P.

Bacteriological Department :

H. M. M. WOODWARD, M.A. (OXON.), M.R.C.S., L.R.C.P.

R. S. RALPH, M.R.C.S., L.R.C.P., D.P.H.

X-Ray Department :

K. J. YEO, M.A., M.B., B.CH., D.M.R.E. (CAMB.).

Consulting Anæsthetists :

S. ROWBOTHAM, M.D., M.R.C.S., L.R.C.P., D.A.

H. S. KNIGHT, M.B., B.S., M.R.C.S., L.R.C.P.

Anæsthetists :

F. H. PRATT, M.R.C.S., L.R.C.P., D.A.

A. DANIN, M.R.C.S., L.R.C.P.

L. H. LERMAN, M.R.C.S., L.R.C.P., D.A.

F. MALLINSON, M.R.C.S., L.R.C.P., D.A.

Miss A. OFENHEIM, M.R.C.S., L.R.C.P., D.A.

F. F. CARTWRIGHT, M.R.C.S., L.R.C.P., D.A.

Consulting Dental Surgeon :

E. W. STABB, L.D.S., R.C.S. (ENG.).

Dental Surgeons :

L. F. SEYMOUR, L.D.S., R.C.S. (ENG.).

H. N. SQUIRE, L.D.S., R.C.S. (ENG.).

H. E. TERRY, L.D.S., R.C.S. (ENG.).

H. M. BRUCE-PAYNE, L.D.S., R.C.S. (ENG.).

1 Resident Surgical Officer :**1 House Physician.****1 „ Surgeon.****1 Casualty Officer.****1 Dental House Surgeon. (Non-Resident.)****Matron :** Miss H. WINROW.**Almoner :** Miss D. COULDREY, A.I.H.A.**Hon. Chaplain :** Rev. F. H. J. NEWTON, M.A.

Obituary

Miss GERTRUDE LEES, A.R.R.C.

It is with great regret, and with a feeling of real personal loss to all who had the privilege of knowing her, that we have to record the passing of Sister Gertrude, on 3rd February, 1941.

She had devoted the whole of her nursing life to St. John's, so that it would be difficult to think of the hospital as not connected with her dignified and gracious personality.

Coming to the Hospital in 1892 she worked there with the greatest devotion, first as a lady pupil, then as one of the Nursing Sisters of St. John the Divine, and finally became Matron of the hospital in 1912.

Throughout her long service she maintained by her wonderful example and influence the high tradition of St. John's, the foundation of which had been laid by her predecessors. Greatly beloved, not only by her patients, who were so helped and comforted by her in their time of suffering, but also by her nursing staff, to whom her high sense of duty, ready sympathy in their difficulties, and deep religious convictions, were an inspiration and education and which brought out all that was best in their work and character.

She had already talked of retiring when, in 1914, the Great War started, and she decided she must carry on and "do her bit", though the additional work entailed was almost too much for her, and she never recovered in her later years from the strain of that time.

The British and Belgian soldiers who were sent to St. John's were all devoted to her, and even up to the last she had letters from many of the men who had been under her care. Few people know how much practical help she gave to many of them after the War. She was awarded by His Majesty King George V the decoration of the A.R.R.C., and received the medal of Queen Elizabeth of the Belgians.

Miss Lees retired in 1925, after a long and honourable career, taking with her the respect and affection of all who knew her, having maintained the great traditions of the hospital which, one hopes, may last as long as St. John's exists.

In the years that followed, her greatest interest and joy were centred in her old hospital, and she was never so happy as when she came down from her home in Kensington to visit St. John's and see her old friends. Who can forget her at the Annual Meetings, of the Nurses' League, surrounded by many of her old staff, whose loyalty and affection were always hers?

One cannot think of a better ending to this short tribute to her memory than by quoting the words of one of our greatest surgeons who had worked with her for many years. His words were, "She was a wonderful woman, and it was a well-spent life."

In December, 1940, was taken from us Miss PURCELL, who from the year 1900 was closely connected with the hospital in that her father then joined the Committee, becoming Chairman in 1904, which year also saw the inauguration of St. John's Hospital Guild, which from then on was to occupy so much of Miss Purcell's life. She took a very active share in beginning it and became its honorary secretary in 1911 and continued to fulfil that office until she died. I think it is true to say that she was the life of the Guild. No effort was spared by her to attract new members and to retain keenness in those already enrolled. She will long be remembered by us all.

THE 57th ANNUAL REPORT.

The Governors beg to present their Fifty-seventh Annual Report, which, by direct instruction from the Ministry of Supply, is, on account of paper shortage, of the briefest kind.

During the year 52 beds and the Out-patient Department were kept open for civilian sick and 50 beds were reserved for the Ministry of Health. On no less than nine occasions was damage done by bombs to one or other of our buildings. The most severe was in December, 1940, when Westbank, attached to the Nurses' Home was completely destroyed and Cedar Lodge, housing the Massage and Dental Departments, so badly shattered that it can no longer be used. The Out-patient building at the bottom of Morden Hill was also severely hit, but this we have been able to repair.

We should like to state that throughout all these trials the staff have behaved in a manner that we should expect and that the services to its people were never interrupted for more than a week in the wards and a fortnight in the Out-patient Department.

W. BRASS,
Chairman.

23rd May, 1941.

STATISTICAL TABLES.

Statistics for Year to 31st December, 1940, compared with those of the previous Year.

I.—IN-PATIENTS.

NUMBER OF BEDS AND IN-PATIENTS.

	Numbers in 1940.	Numbers in previous year.
1. Beds. (a) Complement at 31st December	102	102
(b) Average Daily Complement during the year ..	102	102
(c) Average Daily Number Closed during the year, owing to :—		
(1) Rebuilding or Extension Schemes	—	—
(2) Repairs, Redecoration, Cleaning or Infection	6.6	—
(3) Other causes (to be specified)	—	18
(d) Average Daily Number Open during the year ..	—	84
(1) E.H.S. Casualty Beds	50	—
(2) Other Beds	45.4	—
(e) Average Daily Number Occupied during the year	—	69.7
(1) E.H.S. Casualty Beds	1.8	—
(2) Other Beds	40.8	—
2. Number of In-Patients in the Hospital at beginning of year	35	64
3. Number of In-Patients admitted during year	1,359	1,831
4. Number of In-Patients in the Hospital at the end of the year	Nil.	35
5. Average number of days each Patient was resident.. .. .	11.2	13.7
<i>(Ascertained by dividing the yearly total of daily counts, viz. : (15,613) by the number of Patients treated to a conclusion, i.e. (2) + (3) — (4).)</i>		
6. Number of Patients admitted and discharged during the year who were resident for—		
(i) Only 1 day	263	220
(ii) 2 and 3 days	256	401

II.—OUT-PATIENTS.

NUMBERS.

	Numbers in 1940.	Numbers in previous year.
(1) Total number of new Out-Patients.. .. .	15,674	16,947
(2) Total number of Out-Patient Attendances	49,307	87,428
(A) Number of Patients on Books at the beginning of the year, if ascertainable	2,949	4,729
(B) Number of Casualty Patients included in No. 1 above	2,819	3,176
(C) Number of Maternity Patients included in No. 1 above, attended at home	—	—
(D) Number of Attendances on Maternity Patients included in No. 2 above	—	—

ST. JOHN'S HOSPITAL, LEWISHAM (*Incorporated*).

LEGACIES ACCOUNT for the Year ending 31st December, 1940.

RECEIPTS.		PAYMENTS.	
EXTRAORDINARY INCOME.	£ s. d.	Transferred to Capital Account—Buildings and Equipment to reduce debt on New Nurses Home	£ s. d.
Legacies—			
The late H. Heather, Esq.	100 0 0		
W. C. Gunn, Esq.	50 0 0		
Miss E. M. Cattley	75 0 0		
Miss Sarah Hulbert	300 0 0		
	<hr/>		
	525 0 0		525 0 0
	<hr/>		
	£525 0 0		£525 0 0

INCOME AND EXPENDITURE ACCOUNT *for the*

INCOME.

ORDINARY.	£	s.	d.	£	s.	d.	£	s.	d.
I. VOLUNTARY GIFTS.									
1. Subscriptions, Donations, etc.—									
Annual Subscriptions	857	14	6						
Donations	3,698	9	8						
Box Collections	174	9	2						
Gifts in kind	17	7	3						
							4,748	0	7
2. Central Funds—									
King Edward's Hospital Fund Grant for 1940	1,600	0	0						
King Edward's Hospital Fund Supplementary Grant for 1939	375	0	0						
Hospital Sunday Fund	290	0	0						
							2,265	0	0
								7,013	0 7
II. RECEIPTS ON ACCOUNT OF SERVICES RENDERED.									
1. Contributions on Account of Services to Patients—									
(a) From Patients and their Societies—									
Patients	3,592	7	7						
Contributory Schemes—									
Hospital Saturday Fund	149	10	6						
Hospital Saving Association	4,323	17	5						
Approved Societies.. .. .	116	5	9						
							8,182	1	3
(b) From Public Authorities—									
Government Emergency Hospital Scheme—Contributions towards cost of Casualty Service	6,752	8	5						
London County Council	1,500	0	0						
Croydon Borough Council.. .. .	2	0	3						
Deptford Borough Council	9	15	6						
Kent County Council	813	16	1						
Lewisham Borough Council	1,096	2	11						
Surrey County Council	2	11	9						
Woolwich Borough Council	90	5	6						
Ministry of Pensions	1	10	0						
							10,268	10	5
								18,450	11 8
<i>Carried forward</i>								£25,463	12 3

Year to the 31st December, 1940. (See also *Legacies Account, page 11*).

EXPENDITURE.

ORDINARY.	£	s.	d.	£	s.	d.
I. PROVISIONS				2,518	19	1
II. SURGERY AND DISPENSARY.						
1. Drugs, Chemicals, Disinfectants, etc.	718	18	2			
2. Dressings, Bandages, etc.	277	11	7			
3. Instruments and Appliances	954	13	1			
4. Wines and Spirits	1	11	6			
5. Salaries and Wages of Dispensing Staff	456	11	2			
6. Sundries	45	5	5			
				2,454	10	11
III. DOMESTIC.						
1. Renewal and Repair of Furniture, Bedding, Crockery, etc.	519	5	4			
2. Laundry	940	18	9			
3. Cleaning and Chandlery	96	5	3			
4. Water	65	18	8			
5. Fuel and Lighting	1,680	14	1			
6. Uniform	106	15	4			
7. Sundries	17	7	3			
				3,427	4	8
IV. SALARIES AND WAGES.						
1. Medical	1,292	14	6			
2. Nursing	3,081	12	1			
3. Other Officers and Employees	6,180	5	7			
4. Pensions	—			10,554	12	2
V. MISCELLANEOUS.						
1. Printing, Stationery, Postages, Telephones, etc. ..	286	17	3			
2. Advertisements	53	9	9			
3. Insurance of Buildings, Equipment, Stores, etc. ..	122	17	6			
4. Garden	340	8	11			
5. Sundries	61	18	7			
				865	12	0
<i>Carried forward</i>				£19,820	18	10

INCOME AND EXPENDITURE ACCOUNT

INCOME—continued.

	£	s.	d.	£	s.	d.	£	s.	d.
Brought forward							25,463	12	3
 III. INVESTED PROPERTY.									
Interest, Dividends, etc.				647	11	9			
Rents				58	6	4			
				<hr/>			705	18	1
Total Income							£26,169	10	4

We have examined the Income and Expenditure Account with the books and of our knowledge and belief such Account has been compiled in accordance with the

16th April, 1941.

for the Year to the 31st December, 1940.

EXPENDITURE—continued.

	£	s.	d.	£	s.	d.
<i>Brought forward</i>				19,820	18	10
VI. ADMINISTRATION.						
1. Salaries	958	4	2			
2. Pensions	—					
3. Printing, Stationery, Postages, Telephones, etc. ..	120	16	1			
4. Advertisements	—					
5. Law Charges	56	18	1			
6. Auditor's Fee	42	0	0			
7. Sundries	46	16	0			
	<hr/>			1,224	14	4
VII. ESTABLISHMENT.						
Renewals and Repairs to Buildings and Plant				370	10	11
VIII. FINANCE.						
1. Interest	252	0	7			
2. Appeals	428	18	0			
3. Rent	—					
4. Rates and Taxes.. .. .	440	19	8			
	<hr/>			1,121	18	3
Ordinary Expenditure				22,538	2	4
Total Expenditure				22,538	2	4
Balance being excess of Income over Expenditure for the year				3,631	8	0
				<hr/>		
				£26,169	10	4

vouchers, and certify the same to be correct and in accordance therewith. To the best Regulations of the Revised Uniform System of Hospital Accounts.

J. L. HARPER, LAMAISSON & Co., *Chartered Accountants*,
33, Mark Lane, London, E.C.3.

31st December, 1940.

ASSETS.

	£	s.	d.	£	s.	d.	£	s.	d.	£	s.	d.
1. CASH AT BANK AND IN HAND—												
(a) Endowment Fund ..				1,000	0	0						
Ditto, on Deposit at P.O. Savings Bank ..				432	8	9						
							1,432	8	9			
(b) Special Funds—Samaritan Fund							267	6	2			
(c) Building and Equipment Fund												
(d) General Fund	302	12	3									
Income Tax Suspense A/c	18	4	11									
				320	17	2						
Superannuation Fund ..				479	11	11						
							800	9	1			
										2,500	4	0
2. STOCK OF UNISSUED STORES ON HAND AS CERTIFIED BY THE SECRETARY										2,502	17	2
3. INTERNAL LOAN—Loan from Endowment Fund to General Fund										3,839	4	11
4. SUNDRY DEBTORS—General Fund										2,941	5	5
5. INVESTMENTS—												
(a) Hospital Endowments							15,217	15	10			
Ditto, held by Charity Commissioners for repayment of Loan							886	6	8			
										16,104	2	6
6. *LAND, BUILDINGS AND EQUIPMENT—												
Balance as at 31st December, 1939							102,462	4	8			
Additions during the year on Account of A.R.P. Protective Work							1,402	0	0			
										103,864	4	8
*These figures do not include payments in respect of Land, Buildings and Equipment made direct from the Funds of the Nursing Sisters of the Community of St. John the Divine.										£131,751	18	8

of our knowledge and belief has been compiled in accordance with the regulations of the Revised Uniform treatment of Free Legacies, dated December, 1940. We have obtained all the information and explanations view of the state of the Hospital's affairs, according to the best of our information and the explanations given us

J. L. HARPER, LAMAISSON & Co., Chartered Accountants,
33, Mark Lane, London, E.C.3.

ENDOWED BEDS.

A sum of £1,000 is sufficient to name and endow a bed in perpetuity, or £500 endows a cot.

This is the best way of ensuring a regular income to this Hospital.

We appeal to local residents and traders to become regular annual subscribers of moderate amounts.