

**Specification of Francis Taylor : apparatus for receiving, drying, and deodorizing human excrement.**

**Contributors**

Taylor, Francis.

**Publication/Creation**

London : Great Seal Patent Office, 1861 (London : George E. Eyre and William Spottiswoode)

**Persistent URL**

<https://wellcomecollection.org/works/wmtmjnah>

**License and attribution**

This work has been identified as being free of known restrictions under copyright law, including all related and neighbouring rights and is being made available under the Creative Commons, Public Domain Mark.

You can copy, modify, distribute and perform the work, even for commercial purposes, without asking permission.



Wellcome Collection  
183 Euston Road  
London NW1 2BE UK  
T +44 (0)20 7611 8722  
E [library@wellcomecollection.org](mailto:library@wellcomecollection.org)  
<https://wellcomecollection.org>



A.D. 1861, 9th APRIL. N° 876.

SPECIFICATION

OF

FRANCIS TAYLOR.

APPARATUS FOR RECEIVING, DRYING, AND  
DEODORIZING HUMAN EXCREMENT.

LONDON:

PRINTED BY GEORGE E. EYRE AND WILLIAM SPOTTISWOODE,  
PRINTERS TO THE QUEEN'S MOST EXCELLENT MAJESTY:

PUBLISHED AT THE GREAT SEAL PATENT OFFICE,  
25, SOUTHAMPTON BUILDINGS, HOLBORN.

Price 6d.

1861.

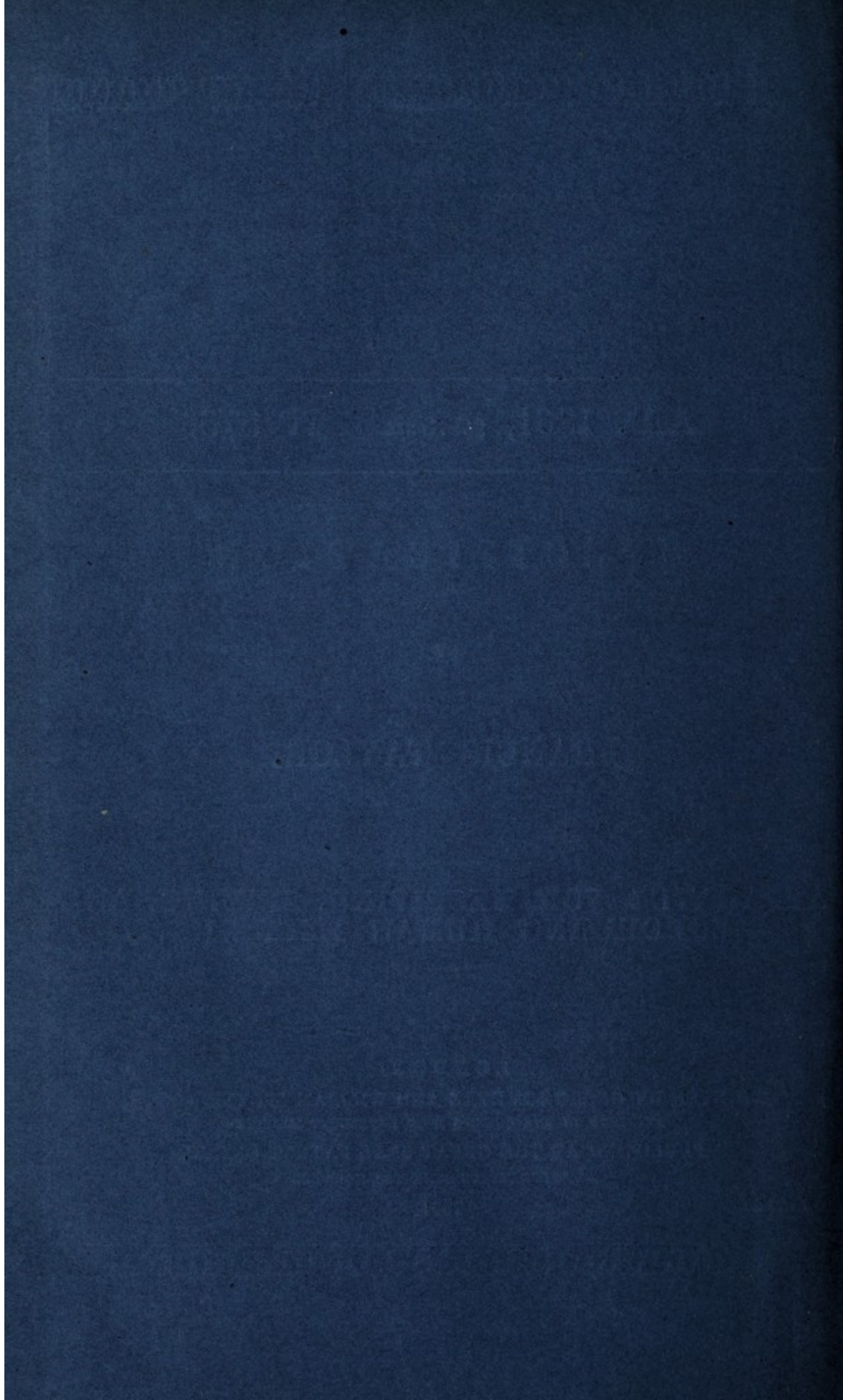



A.D. 1861, 9th APRIL. N° 876.

**Apparatus for Receiving, Drying, and Deodorizing  
Human Excrement.**

**LETTERS PATENT** to Francis Taylor, of Romsey, in the County of Southampton, for the Invention of "IMPROVEMENTS IN APPARATUS FOR RECEIVING, DRYING, AND DEODORIZING HUMAN EXCREMENT."

Sealed the 26th September 1861, and dated the 9th April 1861.

**PROVISIONAL SPECIFICATION** left by the said Francis Taylor at the Office of the Commissioners of Patents, with his Petition, on the 9th April 1861.

I, FRANCIS TAYLOR, of Romsey, in the County of Southampton, do hereby  
5 declare the nature of the Invention for "IMPROVEMENTS IN APPARATUS FOR RECEIVING, DRYING, AND DEODORISING HUMAN EXCREMENT," to be as follows:—

Upon a floor so constructed that the liquid excrement may run to one place either to be wasted in a sewer or retained in a tank or moveable vessel for purposes of irrigation, I propose to place a large turntable to revolve upon a  
10 centre pivot, so arranged with numerous small notches at the outer edge or otherwise as to admit of its being turned a short distance after each time of use. These notches are to be caught by a spring connected with the heel of the door of the privy, or otherwise acted on so that each time the door is opened the turntable shall be moved one notch; the seat of the privy to be  
15 placed over the outer part of the turntable, so that the solid excrement shall be safely dropped on to it, the urine running off to the water floor below. By

*Taylor's Impts. in Receiving, Drying, and Deodorizing Human Excrement.*

the action of the spring on the door, the table being moved one notch, the deposit of excrement is passed on slightly, and the next deposit is made in a fresh place. A thorough draught of air is to be allowed between the turntable and the floor of the privy. The floor of the privy must be sufficiently high above the turntable to allow of a considerable accumulation of excrement to be made smell-tight. By this process the excrement is dried by natural means, just as guano is dried, becomes hard and inoffensive, retaining all its fertilising properties, not having the opportunity of fermenting and decomposing. The paper which is used in the privy is collected, and after soaking in water and washing off the small quantity of excrement it is soiled with, is to be scalded and made up again into paper. In large establishments where the quantity of excrement deposited on the turntable is too great for the natural drying process to be carried on, artificial heat may be introduced, either by a furnace and flue for the purpose, or by allowing some of the heat and soot from a house flue, conveniently placed, to enter under the privy floor and over the excrement on the turntable; or an ash-house may be constructed over the outer edge of the turntable opposite to that over which the seat of the privy is, so that coal and wood ashes may be sifted daily, and falling through a hopper may be deposited on the excrement, and absorbing its moisture may dry and deodorise it, and add to the bulk and value of the resulting manure. For perfect deodorization, a funnel of coal tar may be placed under the seat of the privy, out of the way of any accident, to drop occasionally a drop of tar upon the recently deposited excrement, and so completely to deodorise it.

**SPECIFICATION** in pursuance of the conditions of the Letters Patent, filed by the said Francis Taylor in the Great Seal Patent Office on the 4th October 1861.

**TO ALL TO WHOM THESE PRESENTS SHALL COME, I, FRANCIS TAYLOR,** of Romsey, in the County of Southampton, send greeting.

**WHEREAS** Her most Excellent Majesty Queen Victoria, by Her Letters Patent, bearing date the Ninth day of April, in the year of our Lord One thousand eight hundred and sixty-one, in the twenty-fourth year of Her reign, did, for Herself, Her heirs and successors, give and grant unto me, the said Francis Taylor, Her special licence that I, the said Francis Taylor, my executors, administrators, and assigns, or such others as I, the said Francis Taylor, my executors, administrators, and assigns, should at any time agree with, and no others, from time to time and at all times thereafter

*Taylor's Impts. in Receiving, Drying, and Deodorizing Human Excrement.*

during the term therein expressed, should and lawfully might make, use, exercise, and vend, within the United Kingdom of Great Britain and Ireland, the Channel Islands, and Isle of Man, an Invention for "IMPROVEMENTS IN APPARATUS FOR RECEIVING, DRYING, AND DEODORIZING HUMAN EXCREMENT,"  
5 upon the condition (amongst others) that I, the said Francis Taylor, my executors or administrators, by an instrument in writing under my, or their, or one of their hands and seals, should particularly describe and ascertain the nature of the said Invention, and in what manner the same was to be performed, and cause the same to be filed in the Great Seal Patent Office  
10 within six calendar months next and immediately after the date of the said Letters Patent.

NOW KNOW YE, that I, the said Francis Taylor, do hereby declare the nature of the said Invention, and in what manner the same is to be performed, to be particularly described and ascertained in and by the following statement  
15 thereof, that is to say:—

Upon a floor so constructed that the liquid excrement may run to one place either to be wasted in a sewer or retained in a tank or moveable vessel for purposes of irrigation, I propose to place a large turntable to revolve upon a centre pivot so arranged with numerous small notches at the outer edge or  
20 otherwise, as to admit of its being turned a short distance after each time of use. These notches are to be caught by a spring connected with the heel of the door of the privy or otherwise acted on, so that each time the door is opened the turntable shall be moved one notch; the seat of the privy to be placed over the outer part of the turntable, so that the solid excrement shall be safely  
25 dropped on to it, the urine running off to the water floor below. By the action of the spring on the door, the table being moved one notch, the deposit of excrement is passed on slightly, and the next deposit is made in a fresh place. A thorough draught of air is to be allowed between the turntable and the floor of the privy. The floor of the privy must be sufficiently high above  
30 the turntable to allow of a considerable accumulation of excrement, and be made smell-tight. By this process the excrement is dried by natural means, just as guano is dried, becomes hard and inoffensive, retaining all its fertilizing properties, not having the opportunity of fermenting and decomposing. The paper which is used in the privy is collected, and after soaking in water and  
35 washing off the small quantity of excrement it is soiled with, is to be scalded and made up again into paper. In large establishments where the quantity of excrement deposited on the turntable is too great for the natural drying process to be carried on, artificial heat may be introduced, either by a furnace and flue for the purpose, or by allowing some of the heat and soot from a

*Taylor's Impts. in Receiving, Drying, and Deodorizing Human Excrement.*

house flue conveniently placed to enter under the privy floor and over the excrement on the turntable; or an ash-house may be constructed over the outer edge of the turntable, opposite to that over which the seat of the privy is, so that coal and wood ashes may be sifted daily, and falling through a hopper may be deposited on the excrement, and absorbing its moisture may dry and deodorize it, and add to the bulk and value of the resulting manure. For perfect deodorisation a funnel of coal tar may be placed under the seat of the privy out of the way of any accident, to drop occasionally a drop of tar upon the recently deposited excrement, and so completely to deodorise it.

Having thus stated the nature of my Invention, I will proceed more fully to describe the manner of performing the same.

## DESCRIPTION OF THE DRAWING.

Figure 1 shews a vertical section of part of a closet or privy, and Figure 2 shews a plan of a turntable or platform below the floor of the privy or closet. It will be seen that the space under the floor of the privy or closet is open to the atmosphere, so that the outer atmosphere may circulate freely therein, and dry the excrements from time to time deposited on the turntable or platform, and this drying may be quickened by making use of fire heat, as above mentioned, and provision may, when desired, be made for employing tar to aid in deodorizing the excrements.

*a* is the seat of the privy; *b* is the floor; *c* is the door, from the lower part of which descends a cranked iron, which when the door is opened gives motion to a driver *d*, which acting on the teeth of the ratchet *e* fixed to the turntable *f* gives motion to such turntable each time that the door is opened. The turntable is mounted on an axis *g*, as is shewn. The bottom *h* of the space below the floor of the privy or closet is inclined in order that the urine may descend into a proper tank or receiver or to a proper drain.

In witness whereof, I, the said Francis Taylor, have hereunto set my hand and seal, this Twenty-fifth day of September, in the year of our Lord One thousand eight hundred and sixty-one.

FRANCIS TAYLOR. (L.S.)

LONDON:

Printed by GEORGE EDWARD EYRE and WILLIAM SPOTTISWOODE,  
Printers to the Queen's most Excellent Majesty. 1861.

73

FIG. 1.

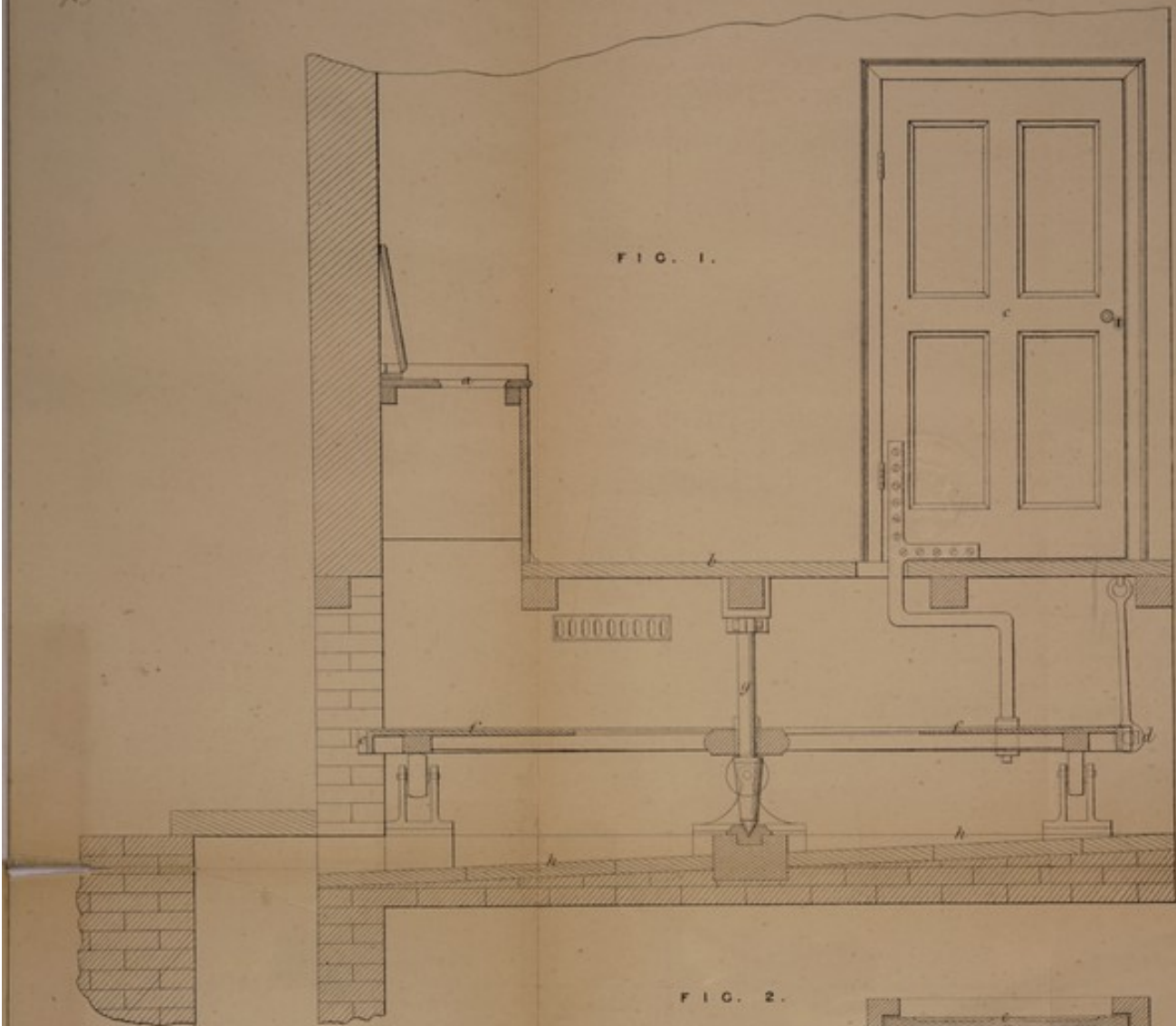
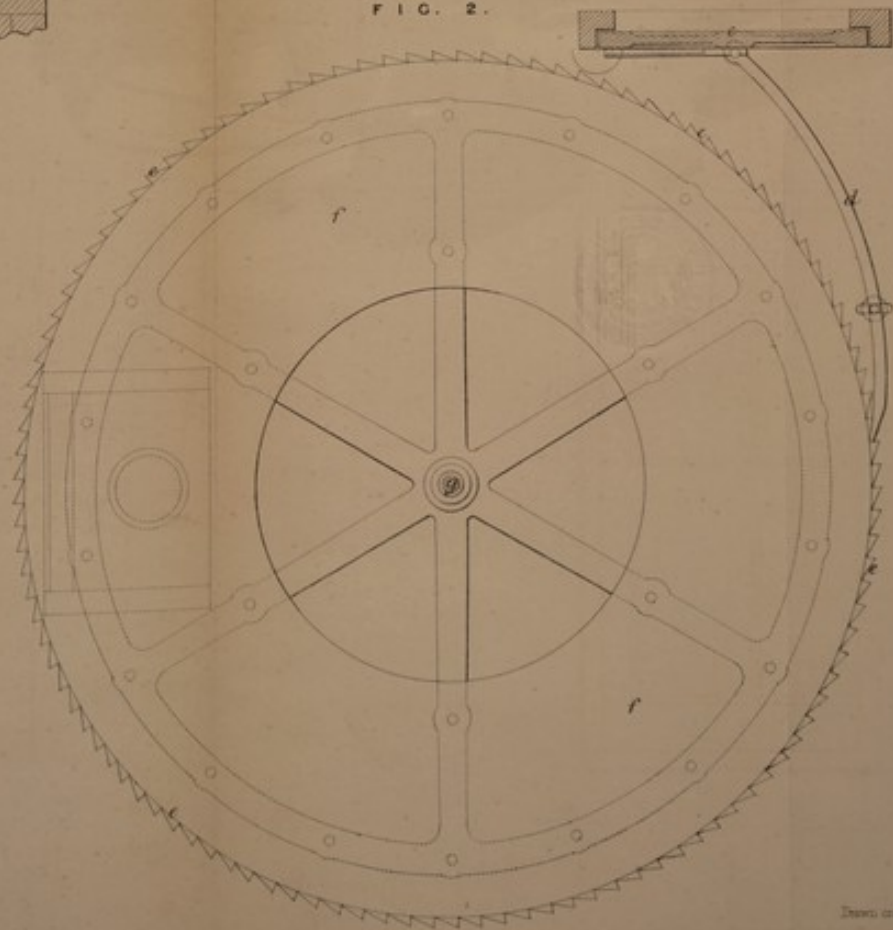

FIG. 2.



The filed drawing is not colored

Drawn on Stone by Malby & Sons.



