

Statistical tables, &c.; &c., for the year 1852 / Saint Luke's Hospital for Lunatics.

Contributors

Saint Luke's Hospital for Lunatics (London, England)

Publication/Creation

[Place of publication not identified] : [s.l.], [1853?]

Persistent URL

<https://wellcomecollection.org/works/hknuveyw>

License and attribution

This work has been identified as being free of known restrictions under copyright law, including all related and neighbouring rights and is being made available under the Creative Commons, Public Domain Mark.

You can copy, modify, distribute and perform the work, even for commercial purposes, without asking permission.



Wellcome Collection
183 Euston Road
London NW1 2BE UK
T +44 (0)20 7611 8722
E library@wellcomecollection.org
<https://wellcomecollection.org>

St. Luke's Hospital for Lunatics.

STATISTICAL TABLES,

&c., &c.,

FOR THE YEAR

1852.



STATISTICAL TABLES
1890-1891



Digitized by the Internet Archive
in 2018 with funding from
Wellcome Library

STATISTICAL TABLES

For the year 1852.

N^o. I.

STATEMENT of the Number of PATIENTS ADMITTED and DISCHARGED from 1st January to 31st December, 1852.

(I.) PATIENTS DEEMED CURABLE.

	Males.	Females.	Total.
In the Hospital on 1st January, 1852.	38	51	89
Admitted during the year	62	123	185
	100	174	274
Discharged—Unfit	4	6	10
—By desire of Friends	3	6	9
Remaining in the Hospital	26	63	89
	33	75	108
Treatment completed	67	99	166

STATEMENT shewing the per centage.

<i>Males.</i>		<i>Females.</i>	
Cured.. 39	equal to 58.20 per cent...	Cured.. 66	equal to 66.66 per cent.
Uncured 23	„ 34.32 „ ..	Uncured 23	„ 23.23 „
Died .. 5	„ 7.46 „ ..	Died .. 10	„ 10.10 „
<u>67</u>		<u>99</u>	

Males and Females together.

Cured..	105	equal to	63.25 per cent.
Uncured	46	„	27.71 „
Died ..	15	„	9.03 „
	<u>166</u>		

TABLES FOR 1852—*continued.*

Admissions and Discharges—continued.

(II.) PATIENTS DEEMED INCURABLE.

			<i>Males.</i>	<i>Females.</i>	<i>Total.</i>
In the Hospital on 1st January, 1852			48	47	95
Admitted during the year			10	6	16
			58	53	111
	<i>Males</i>	<i>Fem.</i>			
Discharged by desire of Friends	2	1			
————— Friends not complying with Rules	2	1			
————— On trial	2	—			
Died	3	3			
			9	5	14
Remaining in the Hospital			49	48	97

(III.) SYNOPSIS OF THE TWO CLASSES.

	<i>Curable.</i>	<i>Incurable</i>	<i>Total.</i>
On the Books on 1st January, 1852.	89	95	184
Admitted in 1852.	185	16	201
	274	111	385
Discharged in 1852.	185	14	199
Remaining in the Hospital	89	97	186
	<i>Males.</i>	<i>Females.</i>	<i>Total.</i>
Average Weekly number of Patients in the Hospital ..	84	113	197
	<i>Males.</i>	<i>Females.</i>	<i>Total.</i>
Average number of Patients attending Divine Service within the Hospital	32	43	75

TABLES FOR 1852—*continued.*

Admissions and Discharges—continued.

(IV.) DISCHARGES ACCORDING TO THE RETURNS REQUIRED
BY 8 AND 9 VICT., C. 100.

	<i>Males.</i>	<i>Females.</i>	<i>Males.</i>	<i>Females.</i>	<i>Total.</i>
Recovered	41	66			
Less returned within 2 months ..	2	—			
			39	66	105
Relieved			4	2	6
Not improved.			32	35	67
Died			8	13	21
Total			83	116	199

TABLES FOR 1852—*continued.*N^o. II.MONTHLY ADMISSIONS, CURES, *and* DEATHS of
CURABLE PATIENTS *during* 1852.

MONTH	ADMITTED.			CURED.			DIED.		
	<i>Males.</i>	<i>Females.</i>	<i>Total.</i>	<i>Males.</i>	<i>Females.</i>	<i>Total.</i>	<i>Males.</i>	<i>Females.</i>	<i>Total.</i>
January ..	5	13	18	1	2	3	2	2	4
February ..	4	13	17	3	9	12	—	1	1
March ..	6	8	14	2	6	8	1	—	1
April	4	17	21	6	6	12	1	3	4
May	7	13	20	2	8	10	—	2	2
June	5	6	11	4	2	6	—	—	—
July	8	11	19	5	4	9	—	1	1
August. ..	4	7	11	2	8	10	—	1	1
September..	3	6	9	2	4	6	1	—	1
October. ..	6	8	14	5	7	12	—	—	—
November ..	3	7	10	4	4	8	—	—	—
December ..	7	14	21	3	6	9	—	—	—
Total ..	62	123	185	39	66	105	5	10	15

Patients discharged and re-admitted within two months not included in the above.

TABLES FOR 1852—*continued.*N^o. III.PERIOD of RESIDENCE *in the Hospital of* PATIENTS
DISCHARGED CURED *in* 1852.

	<i>Males.</i>	<i>Females.</i>	<i>Total.</i>
4 Weeks	1	—	1
5 "	—	2	2
6 "	2	3	5
7 "	3	4	7
2 Months and upwards	7	17	24
3 " " "	7	11	18
4 " " "	3	7	10
5 " " "	4	11	15
6 " " "	4	3	7
7 " " "	3	1	4
9 " " "	1	5	6
10 " " "	—	1	1
11 " " "	3	1	4
15 " " "	1	—	1
Total	39	66	105

N^o. IV.DOMESTIC CONDITION of CURABLE PATIENTS
admitted during 1852.

	<i>Males.</i>	<i>Females.</i>	<i>Total.</i>
Married	27	63	90
Single	34	50	84
Widowed.	1	10	11
Total	62	123	185

TABLES FOR 1852—*continued.*N^o. V.HEREDITARY PREDISPOSITION *of* CURABLE
PATIENTS *admitted during* 1852.

	<i>Males.</i>	<i>Females.</i>	<i>Total.</i>
Hereditary	10	29	39
Not Hereditary	41	85	126
Not ascertained	11	9	20
Total	62	123	185

N^o. VI.AGES *of* CURABLE PATIENTS *admitted during* 1852.

	<i>Males.</i>	<i>Females.</i>	<i>Total.</i>
From 12 to 15 Years	—	—	—
" 16 to 20 "	4	13	17
" 21 to 25 "	13	13	26
" 26 to 30 "	4	21	25
" 31 to 35 "	15	12	27
" 36 to 40 "	7	13	20
" 41 to 45 "	8	12	20
" 46 to 50 "	4	13	17
" 51 to 55 "	1	10	11
" 56 to 60 "	5	6	11
" 61 to 65 "	—	6	6
" 66 to 70 "	1	4	5
Total	62	123	185

TABLES FOR 1852—*continued.*N^o. VII.DURATION of EXISTING ATTACKS of CURABLE
PATIENTS at the time of admission in 1852.

	<i>Males.</i>	<i>Females.</i>	<i>Total.</i>
Under 1 Week	1	—	1
1 Week	9	13	22
2 Weeks	6	21	27
3 "	3	16	19
4 "	11	15	26
5 "	—	6	6
6 "	5	6	11
7 "	—	1	1
2 Months	9	11	20
3 "	8	8	16
4 "	2	4	6
5 "	—	6	6
6 "	5	9	14
7 "	1	1	2
8 "	1	4	5
9 "	1	1	2
10 "	—	1	1
Total	62	123	185

N^o. VIII.NUMBER of ATTACKS of CURABLE PATIENTS
admitted during 1852.

	<i>Males.</i>	<i>Females.</i>	<i>Total.</i>
First	43	90	133
Second	13	23	36
Third	3	8	11
Fourth	2	—	2
Fifth	—	—	—
Sixth	—	2	2
Seventh	1	—	1
Total	62	123	185

TABLES FOR 1852—*continued.*N^o. IX.RESIDENCE *of* CURABLE PATIENTS
prior to admission in 1852.

	<i>Males.</i>	<i>Females.</i>	<i>Total.</i>
Metropolis	32	54	86
Provinces	30	69	99
Total	62	123	185

N^o. X.RELIGIOUS PERSUASION *of* CURABLE PATIENTS
admitted during 1852.

	<i>Males.</i>	<i>Females.</i>	<i>Total.</i>
Baptist.. .. .	4	6	10
Calvinist.	—	1	1
Church of England	45	89	134
Church of Scotland	—	3	3
Independent	6	13	19
Jewish.. .. .	1	1	2
Mormonite	2	—	2
Roman Catholic	1	—	1
Wesleyan Methodist	3	10	13
Total	62	123	185

TABLES FOR 1852—continued.

N^o. XI.

OCCUPATION of CURABLE PATIENTS admitted during 1852.

MALES.		FEMALES.	
Artist	1	Char-Woman	1
Attendants at Lunatic Asylum ...	2	Confectioner's Assistant	1
Baker	1	Cook	1
Butcher	1	Dress-Makers	10
Carpenters	2	Gloveress	1
Carrier	1	Governesses	2
Chymist	1	House-Keepers	5
Clerks	3	Lace Maker	1
Clothier	1	Lodginghouse-Keepers	2
Coach-BUILDER	1	Milliners	2
Coachman	1	Needlewomen	4
Compositor	1	School-Mistresses	4
Cork-Cutter	1	Servants	26
Drapers	2	Shopkeeper	1
Engineer	1	Silk-Filler	1
Farmers	3	Silk-Winders	2
Fishmonger	1	Tambour-Worker	1
Footman	1	Wives of the following, viz.,—	
Gardener	1	Bakers	2
Grocer	1	Carpenter	1
Grooms	2	Clerk	1
Innkeeper	1	Cordwainer	1
Labourers	2	Dairyman	1
Law-Stationer	1	Farmers	3
Lodging-house-KEEPER	1	Gardeners	3
Mechanical-Draughtsman	1	Grocer	1
Messenger	1	Hair-Dresser	1
Painter	1	Joiner	1
Paper-Hanger	1	Labourers	8
Pianoforte-Maker	1	Letter-Carrier	1
Police-Constable	1	News-Vendor	1
Post-Boy	1	Policeman	1
Printer	1	Porter	1
Rope-Maker	1	Publicans	2
Sawyer	1	Revenue-Officer	1
Schoolmaster	1	Shepherd	1
Sculptor	1	Shop-Keepers	3
Shipwright... ..	1	Soldier	1
Shoe-Makers	4	Tailors	2
Spectacle-Frame-Maker	1	Widow of Grocer	1
Solicitor	1	" Hair-Dresser	1
Tailors	2	" Yeoman	1
Valet	1	Not Stated... ..	18
Watch-Maker	1		
Wire-Drawers	2		
Son of Farmer	1		
Not stated	2		
	62		123

Males 62
 Females 123
 Total 185

TABLES FOR 1852—*continued.*

No. XII.

NUMBER of DEATHS of CURABLE and INCURABLE PATIENTS during the year 1852, shewing the assigned causes thereof.

	<i>Males.</i>	<i>Females.</i>	<i>Total.</i>
Abdominal Disease	1	—	1
Asphyxia Suffocationis	1	1	2
Asthma (Spasmodic)	1	—	1
Disease of the Heart	1	—	1
Dropsy	—	1	1
Epilepsy	1	—	1
Exhaustion	1	2	3
Hernia	—	1	1
Jaundice	1	—	1
Mortification of the Legs	—	1	1
Natural Decay	1	—	1
Phthisis	—	2	2
Scrofula	—	2	2
Typhoid Fever	—	3	3
Total	8	13	21

TABLE
OF THE
RELATIVE WEIGHTS
OF
PATIENTS ON THEIR ADMISSION AND DISCHARGE:

*Referring to those Patients discharged "Cured" during
the Year 1852.*

TABLE of the relative WEIGHTS of Patients on their admission and discharge.

NAME.	Age.	Sex.	Form of Malady.	Period of Residence.	Weight on Admission.		Weight on Discharge.		Increase.	Decrease.
				weeks.	st.	lbs.	st.	lbs.		
J. W.	33	Male	Mania	45	12	2	13	4	16	...
C. B. ...	22	Female	Melancholia	38	6	11	9	0	31	...
T. S. ...	42	Male	Melancholia	45	10	2	10	10	8	...
W. M....	21	Male	Mania	60	8	6	10	6	28	...
M. P ...	37	Female	Melancholia	27	8	2	10	0	26	...
W.F.W.	44	Male	Melancholia	24	6	10	7	7	11	...
C. A. W.	16	Female	Mania	27	7	0	7	10	10	...
G. T. ...	26	Male	Melancholia	27	10	2	11	7	19	...
R. H. ...	50	Male	Melancholia	23	12	6	12	4	...	2
D. M. ...	23	Male	Melancholia	28	8	6	8	10	4	...
A. G. ...	60	Female	Mania	17	7	0	8	4	18	...
S. M. ...	25	Female	Mania	21	6	4	7	10	20	...
E. H. ...	34	Female	Mania	14	8	5	10	0	23	...
J. H. ...	51	Male	Melancholia	11	13	11	13	0	...	11
S. H. ...	52	Female	Melancholia	11	7	6	8	3	11	...
J. T. M.	18	Male	Mania	30	9	4	10	9	19	...
L. E. ...	24	Female	Mania	11	6	11	8	9	26	...
L. B. ...	38	Female	Melancholia	21	8	9	9	5	10	...
E. W....	26	Female	Mania	37	6	3	8	3	28	...
M. A. P.	17	Female	Mania	8	6	12	7	2	4	...
M. R. ...	57	Female	Mania	22	6	4	7	9	19	...
L. L. ...	34	Male	Melancholia	15	11	7	12	5	12	...
S. S. ...	44	Female	Melancholia	43	7	6	8	4	12	...
E. S. ...	35	Female	Mania	31	7	3	7	6	3	...
M. F. ...	27	Female	Melancholia	16	9	2	9	7	5	...
H. W....	44	Female	Melancholia	7	11	4	11	4
M. W....	27	Female	Mania	22	9	7	10	0	7	...
L. P. ...	48	Female	Mania	6	7	12	8	3	5	...
B. M. ...	20	Male	Mania	46	8	4	9	7	17	...
R. J. ...	26	Male	Melancholia	33	10	7	10	11	4	...
E. F. ...	34	Female	Melancholia	15	5	7	7	0	21	...
S. V. ...	40	Female	Melancholia	7	5	6	6	4	12	...
H. A. ...	41	Female	Melancholia	10	7	11	8	12	15	...

TABLE of WEIGHTS—*continued.*

NAME.	Age.	Sex.	Form of Malady.	Period of Residence.	Weight on Admission		Weight on Discharge.		Increase.	Decrease.
				weeks.	st.	lbs.	st.	lbs.		
J. L. B.	17	Female	Mania	20	6	1	6	4	3	...
J. L. ...	42	Male	Melancholia	15	10	7	11	5	12	...
A. S. ...	32	Female	Mania	18	8	0	8	7	7	...
J. B. ...	24	Female	Mania	38	8	0	9	9	23	...
M. O. ...	28	Female	Melancholia	9	7	4	8	7	17	...
A. J. ...	24	Female	Mania	10	8	4	9	4	14	...
A. S. ...	31	Female	Melancholia	10	8	3	8	5	2	...
G. W. ...	57	Male	Melancholia	12	9	11	10	8	11	...
F. P. ...	61	Female	Melancholia	5	6	5	7	13	22	...
E. S. ...	26	Female	Mania	17	9	11	10	5	8	...
A. W. ...	22	Male	Melancholia	17	10	2	10	9	7	...
J. S. ...	40	Male	Mania	15	8	3	9	0	11	...
C. C. ...	45	Female	Melancholia	43	7	10	7	11	1	...
A. D. ...	30	Female	Mania	22	8	11	9	2	5	...
C. W. ...	27	Female	Melancholia	38	6	7	7	0	7	...
S. A. A.	19	Female	Mania	23	9	2	9	8	6	...
S. G. ...	25	Female	Mania	12	8	0	8	4	4	...
E. D. ...	53	Female	Mania	7	7	7	8	0	7	...
G. T. ...	44	Male	Melancholia	31	10	4	10	11	7	...
E. L. ...	31	Female	Mania	6	10	7	11	0	7	...
J. M. ...	34	Male	Mania	7	12	11	12	12	1	...
N. S. ...	22	Male	Melancholia	7	9	0	9	2	2	...
E. H. ...	28	Female	Mania	38	10	0	10	0
T. V. ...	39	Male	Mania	22	12	7	13	5	12	...
J. W. ...	24	Male	Mania	27	7	8	7	10	2	...
A. B. ...	20	Female	Mania	21	6	6	7	12	20	...
T. C. ...	31	Male	Mania	8	16	3	15	11	...	6
L. T. ...	16	Female	Melancholia	23	6	11	8	0	17	...
W. C.	Male	Mania	12	10	4	10	2	...	2
E. Mc. L.	37	Female	Mania	8	7	11	8	7	10	...
M. A. D.	46	Female	Melancholia	7	7	6	7	7	1	...
J. W. ...	31	Male	Mania	11	10	4	10	9	5	...
M. A. P.	39	Female	Mania	13	5	7	6	12	19	...

TABLE of WEIGHTS—*continued.*

NAME.	Age.	Sex.	Form of Malady.	Period of Residence.	Weight on Admission.		Weight on Discharge.		Increase.	Decrease.
				weeks.	st.	lbs.	st.	lbs.	lbs.	lbs.
J.E.H.P	38	Male	Mania	6	11	2	11	13	11	...
J. L. ...	42	Male	Melancholia	20	11	7	11	8	1	...
E. P. ...	48	Female	Mania	10	10	2	12	0	26	..
H. P. ...	40	Male	Melancholia	20	10	10	12	1	19	...
C. C. ...	44	Female	Melancholia	27	6	0	6	13	13	...
S. B. ...	66	Female	Melancholia	15	8	9	8	2	...	7
E. D. ...	19	Female	Melancholia	15	8	0	9	2	16	...
J. A. C.	22	Female	Melancholia	11	7	7	8	11	18	...
F. C. ...	34	Male	Mania	27	9	0	9	7	7	...
J. B. ...	32	Male	Melancholia	23	9	9	10	1	6	...
T. R. ...	45	Male	Melancholia	8	8	11	9	0	3	...
M. A. D.	37	Female	Mania	13	7	7	8	11	18	...
F. H. ...	28	Male	Catalepsy	11	8	2	9	10	22	...
G. B. ...	16	Male	Mania	16	5	3	6	11	22	...
M. A. C.	29	Female	Melancholia	8	7	2	7	10	8	...
R. G. ...	22	Female	Mania	13	7	2	9	2	28	...
E. G. ...	29	Female	Mania	11	7	8	9	2	22	...
A. G. ...	61	Female	Mania	14	8	0	8	2	2	...
E. A. S.	26	Female	Monomania	14	7	7	8	1	8	...
M. A. B.	60	Female	Mania	16	7	4	7	3	...	1
L. B. ...	19	Female	Mania	19	6	0	6	12	12	...
T. J. L.	58	Male	Melancholia	13	9	5	10	11	20	...
W. K....	38	Male	Melancholia	13	10	0	11	4	18	...
J. W. ...	58	Male	Melancholia	21	11	5	11	5
H. C. ...	28	Female	Mania	18	6	8	8	4	24	...
M. A. W.	37	Female	Mania	5	7	4	7	7	3	...
E. S. ...	26	Female	Melancholia	5	8	7	8	9	2	...
G. P. ...	19	Male	Mania	7	9	9	11	7	26	...
M. S. ...	25	Female	Mania	9	6	6	7	13	21	...
J. H. ...	50	Male	Mania	6	10	4	10	4
W. M....	51	Male	Mania	7	8	2	8	12	10	...

TABLE
OF THE
POST MORTEM APPEARANCES
OF
Patients who died during 1852.

TABLE OF POST-MORTEM APPEARANCES.

Name.	Age.	Sex.	Mental Malady.	Duration of Malady.	Concomitant Bodily Affections.	Mode of Death.	Date of Post-Mortem Examination.	General External Appearances.	Scalp.	Cranium.	Weight of Brain.	C E R E B R A L .		Thorax.	Abdomen.
												Membranes.	Substance.		
E. T.	32	Fem.	Puerperal Mania. — Not hereditary	Six Months	Dropsy and Diarrhoea.	Syncope from exhaustion.	26 hours. — Jan.	Fair, delicate, anemic. Great emaciation.	Very thin and bloodless: rather adherent.	Small; oval; much compressed laterally. Bones dense, of moderate thickness	lb. oz. 2 7½ avoirdupois.	Dura Mater normal. Pacchionian bodies few and small. Arachnoid transparent. Pia Mater rather anemic. One ounce and a half of serum escaped.	Entire brain appeared shrunken, and the spaces between the convolutions increased. Grey lamina shallow, pale. White matter rather soft. Puncta tolerably numerous. Choroid bloodless.	Flat. Left mamma with a small scirrhus tumor. Both pleurae filled with serum. Lungs compressed but healthy. Heart small: mitral valve thickened. Aortic valves opaque. Weight of heart 8½ oz.	Much distended by straw coloured serum. Great omentum contracted, forming only a brown fatty band, adherent to the transverse colon. Pancreas enlarged; of a brownish yellow colour. Spleen enlarged, indurated mesenteric glands enlarged, diseased. Liver small, rather soft, kidneys with cysts on surface, and in an advanced state of fatty degeneration. One ovary with a small cyst. Weight of liver 2 lbs., of kidney 5 oz.
M. A. A.	55	Fem	Acute Mania. — Mother insane.	Seven Months	Phthisis.	Syncope with convulsions from exhaustion.	30 hours. — Feb.	Stature tall, thin. Body much emaciated.	Very thin and bloodless.	Prominent posteriorly; narrow transversely. Bones dense.	2 13	Dura Mater adherent. Arachnoid slightly opaque. Pia Mater venously congested. Considerable sub-arachnoid effusion. Pacchionian bodies few and large.	Grey lamina, not pale. White substance very firm, tough. Puncta tolerably numerous. Choroid with cysts, not bloodless. Velum in-terpositum vascular. Lateral ventricles large.	Cavities in apices of both lungs, with surrounding consolidation and masses of softened tubercle. Some slight old pleuritic adhesions below: apex lungs inseparably adherent. Heart fatty in front.	Stomach occupying an almost vertical position: elongated; transverse colon pushed downwards towards pelvis. Viscera healthy.

Name.	Age.	Sex.	Mental Malady.	Duration of Malady.	Concomitant Bodily Affections.	Mode of Death.	Date of Post Mortem Examination.	General External Appearance.	Scalp.	Cranium.	Weight of Brain.	C E R E B R A L.		Thorax.	Abdomen.
												Membranes.	Substance.		
H. C.	38	Male	Mania remittent. — Hereditary.	Seven Months	Jaundice for three weeks.	Coma after convulsions.	34 hours. — March.	Stature small, slight. General yellow colour of surface. Rather wasted.	Thick; stained yellow; and congested.	Symmetrical. Oval. Bones dense; tinged yellow.	lb. 3 0½	Dura Mater rather adherent, stained yellow. Veins and sinuses congested, with dark, fluid blood. Arachnoid not opaque. Pia Mater vascular. No effusion. Pacchionian bodies few.	Bleeding points numerous. Grey matter; its outer lamina well coloured; the inner pale, and wider. Choroid with some cysts.	Adhesions at apex of each lung, and some dense tubercular deposits. Heart healthy.	Intestines & omentum yellow. Liver pale, ash-coloured; hard; small, quite concealed under the ribs; presenting on section numerous very sinuous yellow lines with intermediate reddish spaces. Gall-bladder almost empty. Liver of a leaden hue; congested, but not enlarged. Kidneys much congested. Intestines healthy.
W. M.	57	Male	Chronic mania	Sixteen Years.	Cerebral tumour.	Coma from an Epileptic fit.	46 hours. — June.	Well made; not wasted. Features livid, swollen. Decomposing rapidly.	Thick, congested; very easily separable	Rather flattened laterally. Bones normal.	3 4	Dura Mater rather adherent. Sinuses and veins congested. Adherent very slightly by a few small vessels to the right side of the falx was a large tumour,—a fibrous sac, 8 inches by 2½, internally smooth and shining; externally smooth. At parts solid, at others with cross-bands, and either with colourless lymph or coagulated blood.	The right hemisphere was evidently compressed by the tumor lying upon it. Grey lamina well coloured; white matter soft, with numerous bleeding puncta.	Lungs not much congested. Pericardium thickened at several spots, and at one adherent to heart. Patches of deposit in first portion of aorta.	Viscera healthy.
S. S.	39	Fem.	Acute Mania.	Ten Days	—	Syncope from Exhaustion. Convulsions.	13 hours. — Oct.	—	Thin.	Right parietal bone with a deep depression nearly penetrating it. Bones thin.	—	Dura Mater and arachnoid normal. Pia Mater congested; effusion into its meshes.	With a reddish hue throughout, deeper behind. Bleeding puncta numerous. Consistence firm.	Pleuritic adhesions on left side. Viscera otherwise healthy.	Viscera healthy.

TABLE OF POST-MORTEM APPEARANCES—continued.

Name.	Age.	Sex.	Mental Malady.	Duration of Malady.	Concomitant Bodily Affections.	Mode of Death.	Date of Post Mortem Examination.	General External Appearances.	Scalp.	Cranium.	Weight of Brain.	C E R E B R A I .		Thorax.	Abdomen.
												Membranes.	Substance.		
H. H.	44	Male.	Mania. — Not hereditary.	Six Months	Pulmonary Emphysema	Coma after convulsions.	47 hours. — Dec.	—	Natural.	Rather thick.		Dura and Pia Mater congested. Several patches of effused blood on arachnoid between the posterior lobes.	Increased vascularity of brain and medulla oblongata. Lateral ventricles, each with one ounce of serum; choroid with cysts; congested.	Lungs adherent; emphysematous. Effusion in right pleura.	Viscera healthy.
M. G.	51	Fem.	Chronic mania. — Dementia	Twelve Years.	Phthisis.	Syncope from exhaustion.	18 hours. — Jan.	Ema- ciated; œdema of Feet.	Very thin — Bloodless	Bones thin. Parietal especially so at their centres.		Apparently normal. Much fluid in the cranial cavity about the brain.	Convolutions appeared flattened. Cortical substance pale. White matter with large gaping puncta. Two or three small extravasations of blood, of the size of pins' heads in the cerebellum.	Right lung studied with tubercles with several small vomice; firmly adherent. Left lung adherent in places, but healthy.	Liver pale. Kidneys with a marbled appearance.
J. S.	48	Male	Melan- cholia. — Not hereditary	Four Months	Gangrene of Lungs. — Pleurisy: sup- pression of urine.	Coma.	44 hours. — Jan.	Wasted.		Bones thin; deeply grooved by vessels.		Dura Mater firmly adherent: its vessels congested. Arachnoid slightly opaque. Pia Mater slightly opaque, and venously congested, especially posteriorly.	Consistence firm. Lateral ventricles, each containing one ounce of serum. Bleeding puncta numerous on section.	Left pleura containing upwards of a pint of opaque whey-like fluid, and its surface coated with recently effused lymph. Left lung hepatized in a large portion of its upper lobe, at the lower and back part of which was a gangrenous portion of the size of half-a crown. Right lung healthy.	Lining membrane of stomach reddened. Gall-bladder much distended with bile. Kidneys slightly granular.

Name.	Age.	Sex.	Mental Malady.	Duration of Malady.	Concomitant Bodily Affections.	Mode of Death.	Date of Post Mortem Examination.	General External Appearances.	Scalp.	Cranium.	Weight of Brain.	C E R E B R A L .		Thorax.	Abdomen.
												Membranes.	Substance.		
J. B.	52	Fem.	Mania. — Sister insane.	Nine Months	Dysen- tery. — Gall- stones.	Syncope — Exhaus- tion.	13 hours. — Feb.	Body rather emacia- ted and jaundiced	—	Bones varying much in thickness at differ- ent parts.		Dura Mater firmly adherent; its vessels distended. Pacchio- nian bodies numerous and large. Arachnoid opaque.	Much serum in- filtrated in brain. Cortical substance pale. Bleeding points numerous. Lateral ventricles distended with fluid.	Viscera normal.	Gall - bladder filled with small calculi. Kidneys slightly marbled. Mucous membrane of intestines much injected; with a patch of lymph at commencement of the colon. Viscera healthy.
J. G...g.	35	Male	Mania.	Eleven Years.	Phthi- sis.	Syncope — Exhaus- tion.	20 hours. — Oct.	Much emacia- ted.	—	—		Sinuses and veins of Dura Mater rather full.	Much infiltration of serum in and about brain. About three ounces escaped during the examination. Numerous puncta on section.	Right lung con- solidated with tubercle, and with several vomicae. Left lung with tubercles posterior- ly. Pericardium holding 2 ounces of serum.	Liver pale and mottled. Kidneys slightly marbled. Two 3-feet of small intestine much contracted. A fibrous tumour of uterus, of the size of a small orange.
E. H.	43	Fem.	Mania.	Three Months	Phthi- sis.	Syncope	36 hours. — Nov.	Great emacia- tion.	—	—		No morbid change detected.	No morbid change detected.	Firm adhesions of both pleurae. Both lungs with tubercular conso- lidation, and vom- icae. Heart healthy	Intestinal mu- cous membrane in- jected and dis- coloured in several places. Viscera other- wise healthy.
E. R.	56	Fem.	Acute mania. — Not here- ditary.	Six Weeks.	Bron- chitis. — Diarr- hœa.	Apnoea.	12 hours. — March.	Great emacia- tion.	—	—		Highly vascular: veins distended. Ar- achnoid slightly o- paque. Pacchionian bodies numerous.	Much injected: bleeding puncta nu- merous. Much bloody serum escaped.	Slight pleuritic adhesions on right side, more exten- sive ones on left. Bronchial tubes filled with mucus. Heart normal.	

TABLE OF POST-MORTEM APPEARANCES—continued.

Name.	Age.	Sex.	Mental Malady.	Duration of Malady.	Concomitant Bodily Affections.	Mode of Death.	Date of Post Mortem Examination.	General External Appearances	Scalp.	Cranium.	Weight of Brain.	C E R E B R A L .		Thorax.	Abdomen.
												Membranes.	Substance.		
G. R.	53	Male	Mania. — Father insane.	Seven Months	Hydrothorax.	Apnoea	16 hours. — Aug.	—	Con- gested.	—	—	—	Cortical substance pale Bleeding puncta numerous on section.	Numerous adhesions of both lungs. Five-sixths of a pint of serum effused in pleura. Left lung compressed to about one-tenth its normal size, and condensed; right lung compressed to about one-fifth. Heart of increased volume and thickness.	Liver enlarged; rather soft, with a nutmeg-like appearance. Kidneys slightly marbled. Mucous membrane of intestines generally greatly injected; other viscera healthy.
E. H. N.	42	Fem.	Mania. — Sister insane.	Two Months	Tumor in Brain.	Coma. — Death sudden.	13 hours. — Sept.	—	—	—	—	—	Convulsions flattened. Bleeding puncta few. In the right cerebral hemisphere was a tumor, of a fatty nature, about the size of a small pullet's egg; the grey matter softened around it. There had been for some time, drowsiness, drooping of left eyelid, and loss of memory.	Viscera healthy.	Viscera healthy.
J. M.	26	Fem	Melan- cholia. — Not here- ditary.	Nine Months	Prolonged refusal of food.	Syncope — exhaustion.	24 hours. — Sept.	Extreme emaciation.	—	—	—	—	Injected. An increased quantity of fluid in ventricles.	Numerous adhesions of pleura. Lungs healthy. Left ventricle hypertrophied.	Several old adhesions of peritoneal coat of liver. Liver enlarged; venously congested; of a dark mahogany colour. Gall-bladder enormously distended.

Name.	Age.	Sex.	Mental Malady.	Duration of Malady.	Concomitant Bodily Affections.	Mode of Death.	Date of Post Mortem Examination.	General External Appearance.	Scalp.	Cranium.	Weight of Brain.	C E R E B R A L .		Thorax.	Abdomen.
												Membranes.	Substance		
J. B...d.	50	Male	Monomania	Thirteen Years.	Pneumonia.	Apucæ.	20 hours. — Oct.	Face and neck livid.	Thick; spongy; congested	—	—	Injected. Puncta very numerous.	General hepatisation of left lung. Numerous adhesions of both pleuræ.	Patches of congestion in stomach and intestines.	
E. R...k.	—	Fem.	Mania. — Uncle insane.	Eight Months	Bronchitis. Pericarditis?	Syncope	36 hours. — Oct.	Emaciation; oedema of legs.	—	—	—	Nothing abnormal observed.	Extensive and old adhesions of right pleura. Pleuræ congested. Extensive bronchitis. Pericardium with 4 oz. of serum.	Liver large, rather congested. Many calculi in gall-bladder: the contained fluid very pale, not yellow. About a pint of serum in peritoneum.	
M. B.	34	Fem.	Mania. — Grandfather and Uncle insane.	Ten Months	Exhaustion from continued excitement.	Syncope	48 hours. — Dec.	Great emaciation.	—	—	—	Grey lamina purplish on surface, but becoming red by the action of the air. Ventricles distended. Puncta numerous on section.	Not examined.	Not examined.	
B. B.	15	Fem.	Mania. — Not here-ditary.	Seven Weeks.	Loss of power over extremities.	Coma after convulsions.	28 hours. — March.	Emaciation. Decomposition proceeding.	—	—	—	Injected. Puncta very numerous. Ventricles empty.	Some congestion of right lung; probably post mortem	Mucous membrane of intestines injected; other viscera healthy.	

TABLE OF POST-MORTEM APPEARANCES—continued.

Name.	Age.	Sex.	Mental Malady.	Duration of Malady.	Concomitant Bodily Affections.	Mode of Death.	Date of Post Mortem Examination.	General External Appearance.	Scalp.	Cranium.	Weight of Brain.	C E R E B R A L.		Thorax.	Abdomen.
												Membranes.	Substance.		
S. T.	74	Fem.	Dementia after mania.	Thirty six Years.	Pleuritis and Pneumonia.	Syncope	33 hours. — April.	Great emaciation.	Adherent	—		Effusion of fluid beneath Dura Mater. Several ounces escaped. Arachnoid slightly opaque.	Surface of convolutions flattened. Substance infiltrated with serum, which also filled the ventricles.	Old adhesions of apex of right lung. 3 pints fluid in right pleura. Upper part of lung hepatized, grey. Two white patches on heart.	A nutmeg condition of liver. Kidneys slightly motled. Mucous membrane of stomach of a leaden colour. Stomach and portions of intestines much contracted.
H. S.	42	Fem.	Chronic mania.	Twenty one Years.	Phthisis.	Syncope	27 hours. — April.	Great emaciation.	—	Thick, but unevenly so.		Dura Mater firmly adherent. Considerable serous effusion. Pia Mater congested. Pacchionian bodies large; numerous.	Cortical substance rather pale. Bleeding puncta few.	Apices of lungs adherent. Both lungs studded with tubercles: several vomicae in upper part of right lung.	Liver of a nutmeg colour. Kidneys natural. Mesentery with numerous scattered tubercles.
J. W...ts.	66	Male	Dementia — Not hereditary.	Six Months	Pleuritis. Refusal of food.	Syncope	36 hours. — Oct.	Much emaciation. Edema of lower extremities.	—	Of unequal thickness Two rough exostoses on Os Frontis, to which the Dura Mater adhered strongly.		Dura Mater congested; readily separable generally. Arachnoid opaque, rather thickened. Some effusion in meshes of Pia Mater.	Surface of convolutions rather flattened, and pale. Numerous puncta, emitting purplish venous blood.	Numerous old adhesions of pleurae on right side. 3 pints of serum in cavity of pleura.	Spleen much softened, breaking down with slightest force. Other viscera healthy.

Name.	Age.	Sex.	Mental Malady.	Duration of Malady.	Concomitant Bodily Affections.	Mode of Death.	Date of Post Mortem Examination.	General External Appearances	Scalp.	Cranium.	Weight of Brain.	C E R E B R A L .		Thorax.	Abdomen.
												Membranes.	Substance.		
A. P.	62	Fem.	Melancholia. — Not here-ditary.	Eight Months	Softening of heart.	Syncope	20 hours. — Oct.	—	—	Thin.		Cortical substance pale. Numerous puncta on section; much injection.	Numerous old adhesions of both pleurae. Heart enlarged, and so soft that the finger could be easily thrust through its walls. There had been palpitation and asthma for years.	General vascularity of lining membrane of intestines	
S. A.	66	Fem.	Monomania.	Twelve Months	Constipation; latterly tympa-nitis.	—	43 hours. — Nov.	Two old and small scrofulous tu-mors in neck. Abdomen distended dis-coloured	—	Of very unequal thickness		Cortical substance pale. Numerous bleeding puncta on section. Cerebellum much injected.	Numerous pleuritic adhesions on both sides. On left side some effusion. Lungs healthy. Heart flabby.	Stomach con-tracted. Intestines above colon dis-tended with gas. Colon itself con-tracted for several inches to size of tobacco-pipe, and below this distend-ed. Rectum con-tracted. Kidneys marbled.	
T. D. G.	48	Male	Mania.	Two Months	Apo-plexy? Twenty hours dura-tion.	Coma.	22 hours. — Aug.	Bruise of left eye and tem-ple from fall in fit.	—	—		Congested with much sub-arachnoid effusion: a con-siderable quantity of fluid at base of brain on right side.	Not examined.	Not examined.	
M. D.	53	Fem.	Chronic mania.	Twenty Three Years.	Apo-plexy Twenty Seven hours dura-tion.	Coma.	30 hours. — March	In good condition	—	—		Arachnoid rather opaque.	Viscera healthy.	Viscera healthy.	

TABLE OF POST-MORTEM APPEARANCES—cont. inued.

Name.	Age.	Sex.	Mental Malady.	Duration of Malady.	Concomitant Bodily Affections.	Mode of Death.	Date of Post Mortem Examination.	General External Appearance.	Scalp.	Cranium.	Weight of Brain.	C E R E B R A L .		Thorax.	Abdomen.
												Membranes.	Substance.		
J. W.	66	Male	Mania. Recurrent.	Second attack. Twenty Two Years. — First attack Six Months	Phthisis. Pleurisy. Diarrhoea. Subject to epileptic fits.	Syncope	12 hours. — April.	Much emaciated. — Edema of ancles.	—	Thick-ness unequal.	—	Much sub-arachnoid effusion.	Numerous bleeding puncta on section. Ventricles distended.	Large quantity of fluid in both pleurae: in right lung firmly adherent, studded with tubercles.	Tabercular deposit in mesentery. Ulcers of ileum and colon. Kidneys mottled.
C. W.	47	Fem.	Melancholia. — Not hereditary.	Five Weeks.	Refusal of food. Exhaustion. Delirium. Retention of urine	Coma? — Exhaustion.	18 hours. — Nov.	Emaciation. Lividity of surface.	—	—	—	Membranes much injected. Their minute vascular branches all distended.	Consistence firm. Bleeding points very numerous. Increased fluid in ventricles. Cerebellum injected.	Lungs healthy. Right ventricle of heart dilated.	Gall - bladder much distended. Lining of intestinal membrane much injected throughout. Mucous membrane of bladder inflamed, covered by a layer of lymph (albumen) about 6 ounces of bloody urine in bladder.
S. O.	64	Male	Mania. — Not hereditary.	Three Months	Cardiac disease.	Syncope	26 hours. — Nov.	Edema of legs.	—	—	—	Congested. Serous effusion in meshes of Pia Mater.	Injected.	Lungs healthy. Heart soft, flabby, with much fat; its walls easily perforated by the finger.	Gall-bladder filled with small gall-stones. Other viscera healthy.

Name.	Age.	Sex.	Mental Malady.	Duration of Malady.	Concomitant Bodily Affections.	Mode of Death.	Date of Post Mortem Examination.	General External Appearance.	Scalp.	Cranium.	Weight of Brain.	C E R E B R A L L.		Thorax.	Abdomen.
												Membranes.	Substance.		
S. N. M.	3	Fem.	Mania.	Twelve Years.	Apo-plexy, 64 hours duration. — Had two fits previously.	Coma with convulsions.	21 hours. — July.	—	Con-gested.	Frontal bone very narrow.		Dura Mater very firmly adherent: its sinuses and veins distended. Sub-arachnoid serous effusion.	Soft: much congested. Ventricles distended. A clot of blood almost fluid, and of a chocolate colour on upper part of the left hemisphere	Not examined.	Not examined.
S. N.	37	Fem.	Mania. — Not hereditary.	Three Weeks.	Cere-bral Tu-mors and hæmorrhage. Frac-ture of Skull.	Coma.	12 hours. — Aug.	Emacia-ted. — Chest con-tracted.	A wound an inch long, ex-posing bone, at back part of head.	Fracture extending from occipital. Spine on left side nearly to the pe-trous bone, and about 3 inches long; bi-furcate below. Cranium very thin at the seat of fracture.		Dura Mater con-gested: also pia mater. A thin layer of blood $1\frac{1}{2}$ inch by $\frac{3}{4}$ inch on upper and front part of anterior lobe of right side. Also superficial effu-sion of blood over the middle lobe at the base of the brain be-neath the pia mater.	A hard, round, car-tilaginous body, of the size of a small pea, in the corpus striatum, and another such in the thalamus, of left side. Brain broken down and soft-ened at the seat of effusion at its base. Lateral ventricles with double their normal fluid.	Slight adhesion of left lung to dia-phragm; and also of upper lobe of right to the ribs. Viscera otherwise healthy.	Viscera healthy.

TABLE OF POST-MORTEM APPEARANCES—continued.

Name.	Age.	Sex.	Mental Malady.	Duration of Malady.	Concomitant Bodily Affections	Mode of Death.	Date of Post Mortem Examination.	General External Appearance.	Scalp.	Cranium.	Weight of Brain.	C E R E B R A L .		Thorax.	Abdomen.
												Membranes.	Substance.		
C. T.	56	Fem.	Mania.	Eight Months	Tumor attached to Dura Mater. Congenital malformation of kidney.	Syncope — Death was sudden.	10 hours. — Jan.	Emaciated, Petechiæ on legs.	—	—	—	An opaque space on the vertex of left hemisphere at the site of the tumor. Fluid in ventricles increased.	Left lung adherent throughout; its middle lobe consolidated, but not recently so. Left ventricle of heart hypertrophied with diminished cavity. Mitral valve thickened at apex. Ventricles empty. Aorta roughened internally.	Viscera healthy. Right kidney reversed, so that its pelvis was turned outwards, and its convexity inwards towards the spine. It had two renal arteries, and three ureters; the latter subsequently uniting in one.	
M. A. L.	29	Fem.	Mania. — Not hereditary.	Ten Weeks.	Phthisis. — Liver disease.	Syncope Exhaustion	12 hours. — Jan.	Much emaciation.	—	Very thin.	—	Apparently healthy	Lungs thrust upwards by enlarged liver; generally adherent, studded with tubercles, and with several large vomice. Heart healthy.	Liver extremely enlarged; of a nutmeg appearance and colour. Lower third of ilium injected and discoloured. Kidneys healthy.	
E. H...s.	61	Fem.	Mania. — Not hereditary.	Two Months	Fatty Liver and congestion of Lungs.	Syncope	48 hours. — Jan.	Much emaciation.	—	Thin.	—	Apparently healthy but the contained serum increased in quantity.	Upper lobe of right, and lower lobe of left lung adherent. Lower lobes of both lungs congested, approaching hepatization, and in parts actually condensed. Heart healthy.	Liver much enlarged; of a pale, greyish colour, and in a state of fatty degeneration. Other viscera healthy.	

Name.	Age.	Sex.	Mental Malady.	Duration of Malady.	Concomitant Bodily Affections.	Mode of Death.	Date of Post Mortem Examination.	General External Appearance.	Scalp.	Cranium.	Weight of Brain.	C E R E B R A L .		Thorax.	Abdomen.
												Membranes.	Substance.		
E. O.	52	Fem.	Melancholia. Not hereditary.	Three Months	Valvular disease of heart.	Syncope	42 hours. — March	Much emaciation.	—	Very thick.		Increased in vascularity; otherwise apparently healthy.	Lungs much congested. Tubercles in apex of left lung. Hypertrophy of left ventricle, and thickening of its valves.	Viscera normal.	
J. P.	53	Male	Mania.	One Month. — Fourth attack.	Refusal of food, and exhaustion.	Syncope	19 hours. — March	Emaciation.	—	Unusually thick.		Injected; with an increased quantity of serum.	Viscera healthy.	Viscera healthy.	
E. C.	50	Fem.	Melancholia. Not hereditary.	Five Months	Gangrene of lungs.	Syncope	30 hours. — May.	Great emaciation.	—	Thick. From inner table of frontal bone about 20 osseous projections indenting the brain substance		Firm and apparently healthy.	Large patches of ulceration at apices of both lungs. Lower lobe of right lung gangrenous. Aortic valves thickened. Much coagulated; fibrine in ventricles.	Viscera healthy.	
E. F. R.	22	Fem.	Mania. Grandfather imbecile 2 years before death.	Seventeen Months	Phthisis. — Cerebellar softening.	Apnoea.	24 hours. — Dec.	Emaciation.	Con- gested.	—		Cortical substance of a deep red colour; consistence of cerebrum firm; but that of cerebellum softened, pulpy and reddened.	Lungs adherent throughout; studded with tubercles and with cavities in their apices.	—	

TABLE OF POST-MORTEM APPEARANCES—continued.

Name.	Age.	Sex.	Mental Malady.	Duration of Malady.	Concomitant Bodily Affections.	Mode of Death.	Date of Post-Mortem Examinations.	General External Appearance.	Scalp.	Cranium.	Weight of Brain.	C E R E B R A L .		Thorax.	Abdomen.
												Membranes.	Substance.		
L. S.	74	Fem.	Chronic mania.	Thirty Years.	Engorgement of lungs. Bright's disease.	Apnoea.	20 hours. — May.	Rather wasted.	—	Well formed; rather thin.	Apparently nearly normal.	Apparently normal, except the cerebellum, which seemed softer than usual	Pleuritic (old) adhesions, and effusion. Lungs engorged, and some patches of extravasated blood. Some few small vomice at apices. Valves of heart healthy.	Liver much congested. Kidneys in a state of granular degeneration. Other viscera healthy.	
M. S.	45	Fem.	Melancholia.	Four Months	Phthisis.	Syncope — Exhaustion.	30 hours. — May.	Great emaciation.	—	Very thin well formed.	Some opacity of Arachnoid; much effusion in meshes of Pia Mater.	Normal.	Lungs thickly studded with tubercles. Two large cavities at apex of right lung. Heart very small, but quite normal.	Viscera healthy.	
N. C.	32	Male	Mania. — Not here-ditary.	Seven Months	Fracture of sternum. Pneumonia.	Coma. — Delirium.	22 hours. — Sept.	Emaciation.	A small abscess on occiput.	—	Some opacity of membranes; their veins turgid. Sub-arachnoid effusion.	Numerous bleeding points on section. Lateral ventricles, with 5 ounces of serum. Pons Varolii vascular.	Fracture of sternum & disarticulation of 3rd and 4th ribs, with suppuration at the spot. Some fluid in both pleura: right one inflamed, and adherent, upper lobe of both lungs hepatized.	Viscera healthy.	

Name.	Age.	Sex.	Mental Malady.	Duration of Malady.	Concomitant Bodily Affections.	Mode of Death.	Date of Post Mortem Examination.	General External Appearances	Scalp.	Cranium.	Weight of Brain.	C E R E B R A L .		Thorax.	Abdomen.
												Membranes.	Substance.		
W. F.	44	Male	Acute mania. Not hereditary.	Three Months	Erysipelas of arm. Paralysis of Insane.	Syncope	11 hours. Oct.	Much emaciated.	—	—	—	Infiltrated with serum. Cortical substance pale. Consistence of white matter, natural; with very numerous bleeding points. Ventricles with twice the normal amount of fluid. Optic Thalami, Pons Varolii and upper part of spinal cord, particularly at origin of 8th and 9th nerves increased in vascularity.	Lungs healthy. Right pleura with a few adhesions. Heart healthy, except in there being a small mass of earthy deposit on one aortic valve. Blood very fluid.	Gall - bladder much distended. Mucous membrane of transverse colon injected. Left kidney increased in size, in first stage of Bright's disease, marbled and flabby, and with six small capsular cysts. The right kidney smaller, whiter, more marbled, and with two cysts.	
H. D.	48	Fem.	Mania second attack. Not hereditary.	Eight Months	Bronchitis.	Apnoea.	36 hours. Dec.	—	—	—	—	Congestion of membranes.	Injected.	Old adhesions of right pleura. General inflammation and choking up of the bronchi. Hypertrophy of left ventricle.	Viscera healthy.
G. P. M'D	47	Male	Chronic Mania.	Twenty three Years.	Bronchitis. Subject to Asthma	Apnoea.	31 hours. March.	—	—	—	—	No abnormal appearances noticed.	No abnormal appearances noticed.	Heart large, flabby. Both lungs inseparably adherent to throax. Chronic inflammation of Bronchi.	Viscera healthy.
A. B.	50	Male	General Paralysis: advanced stage.	—	—	Syncope	24 hours. March.	Emaciated.	—	Rather thin.	—	Dura Mater normal. Pia mater congested, peeling off readily, much thickened. Arachnoid generally opaque and thickened.	Anæmic. Grey lamina shallow, its outline indistinct; no secondary laminae visible. Puncta tolerably numerous. Choroid with cysts.	—	—

TABLE OF POST-MORTEM APPEARANCES—continued.

Name.	Age.	Sex.	Mental Malady.	Duration of Malady.	Concomitant Bodily Affections.	Mode of Death.	Date of Post Mortem Examination.	General External Appearances	Scalp.	Cranium.	Weight of Brain.	C E R E B R A L .		Spinal Cord.
												Membranes.	Substance.	
W. H.	50	Male	Acute Melancholia, then Dementia.	—	Incomplete paraplegia; several convulsive fits. Acquired curvature of spine.	Convulsions. Coma	30 hours. — Nov.	Much emaciated; complexion sallow; body well made; rather delicate.	Rather adherent.	Oval; but rather narrow.	<i>lb. oz.</i> 2 12½ Avoirdupois.	No congestion of membranes. Velum interpositum thickened; commencing earthy deposit in cerebral arteries.	An increase of serum in substance; not of vascularity, consistence normal. Grey matter somewhat pale; cysts in choroid.	No abnormal change discoverable. Upper part stained with blood, probably accidental.
A. G.	36	Male	Melancholia. — Not hereditary.	Nine Months	Attempted strangulation by hanging; breathing reing stored, but not conscious; lived 9 hours.	Coma	43 hours. — May.	Stature small, thin, complexion dusky. Decomposition advancing rapidly.	Edematous; congested.	Asymmetrical; flattened posteriorly on left side; and hollow on each side; summit flattened. Bones soft.	3 5½	Dura Mater adherent. Longitudinal sinus with little blood, but veins opening into it much distended. Lateral and straight sinuses gorged. Arteries of brain distended with dark, venous blood. Pia Mater congested; with several patches of effused bloody serum. Arachnoid very slightly opaque.	Grey lamina pallid. Its secondary divisions distinct; white matter soft; bleeding, puncta numerous. Lateral ventricles nearly empty. Choroid slightly congested, and having some small cysts. 3-4 oz. of blood escaped during examination, and there were clots in sinuses.	

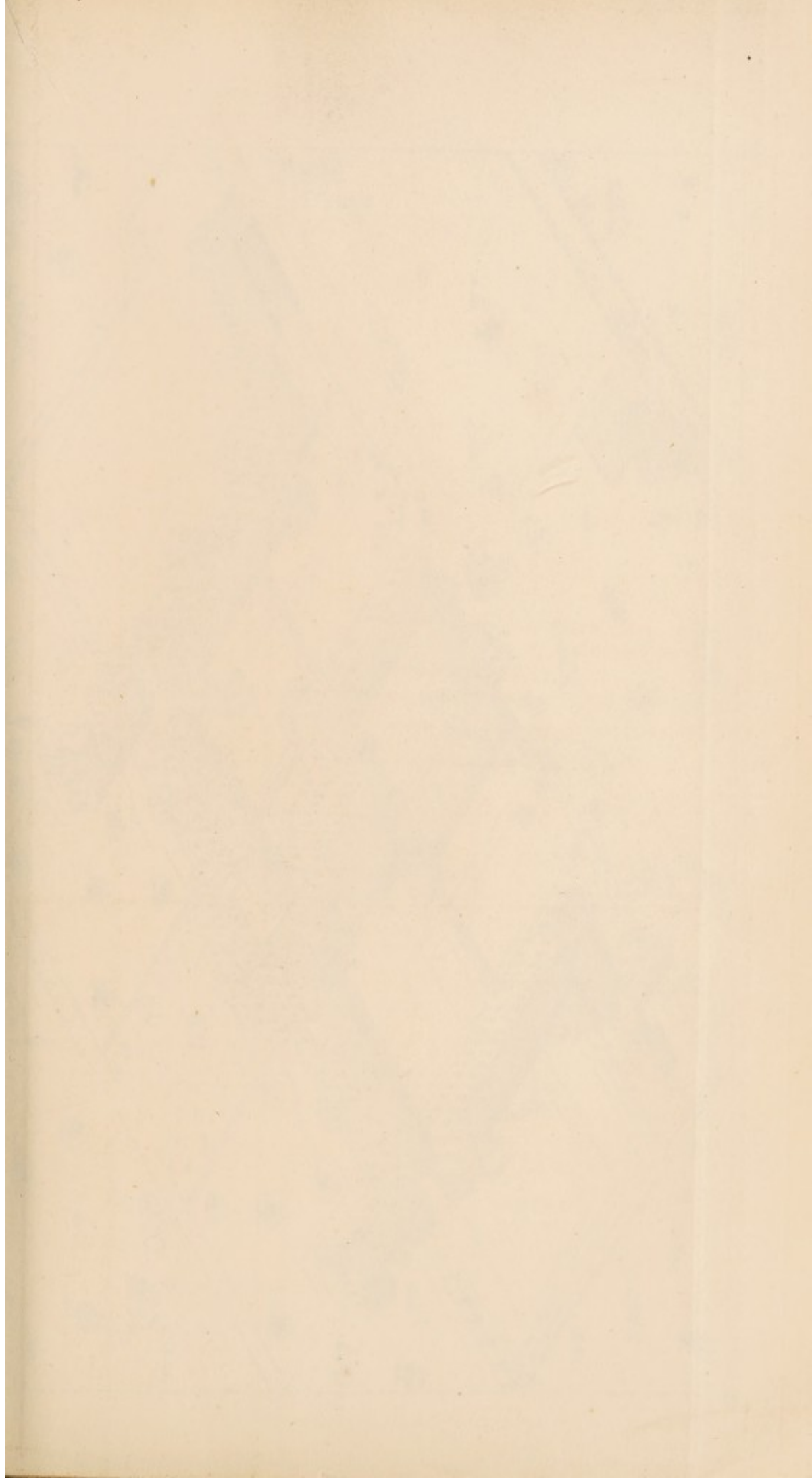

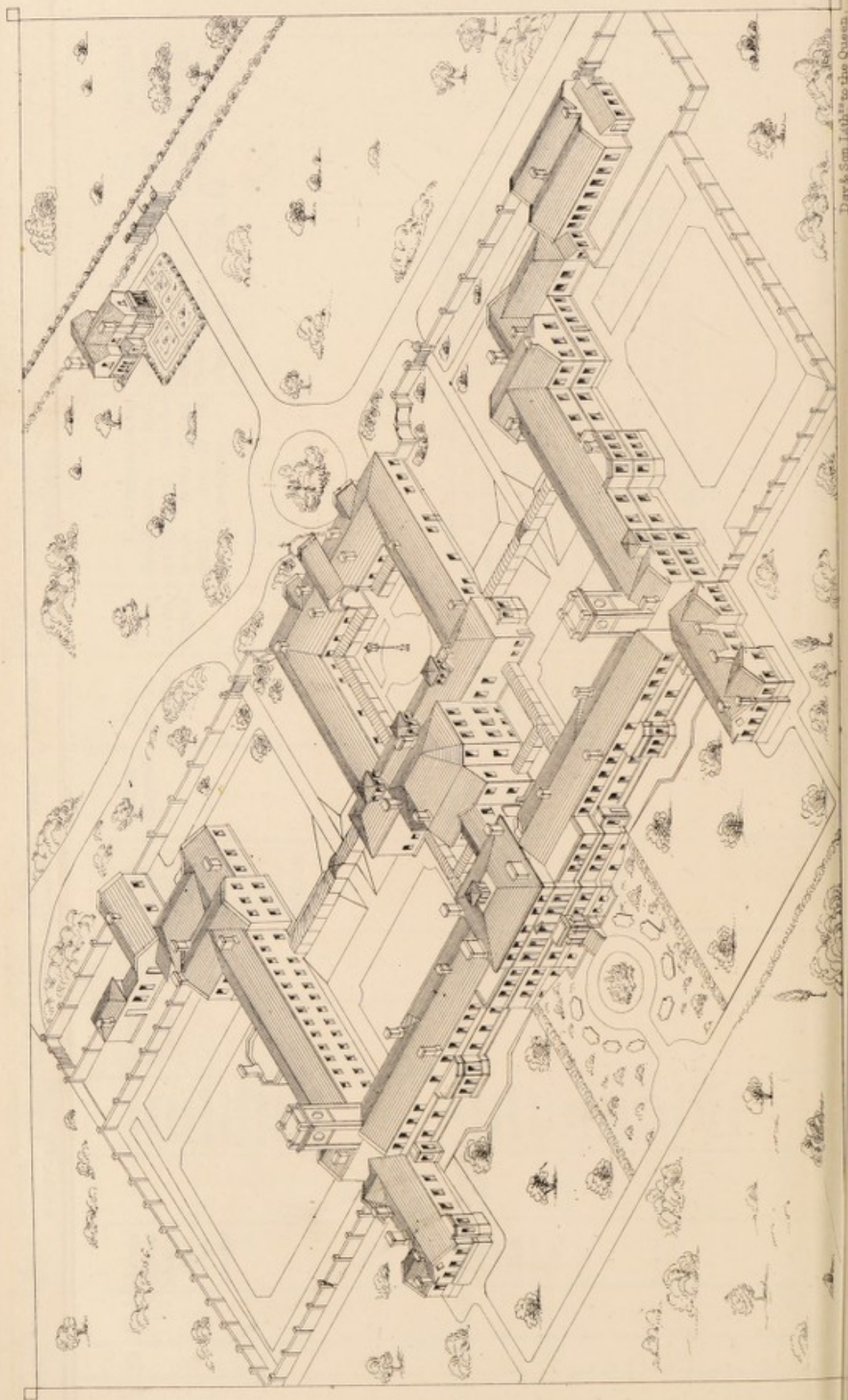

Day & Son, Litho^{rs} to the Queen.

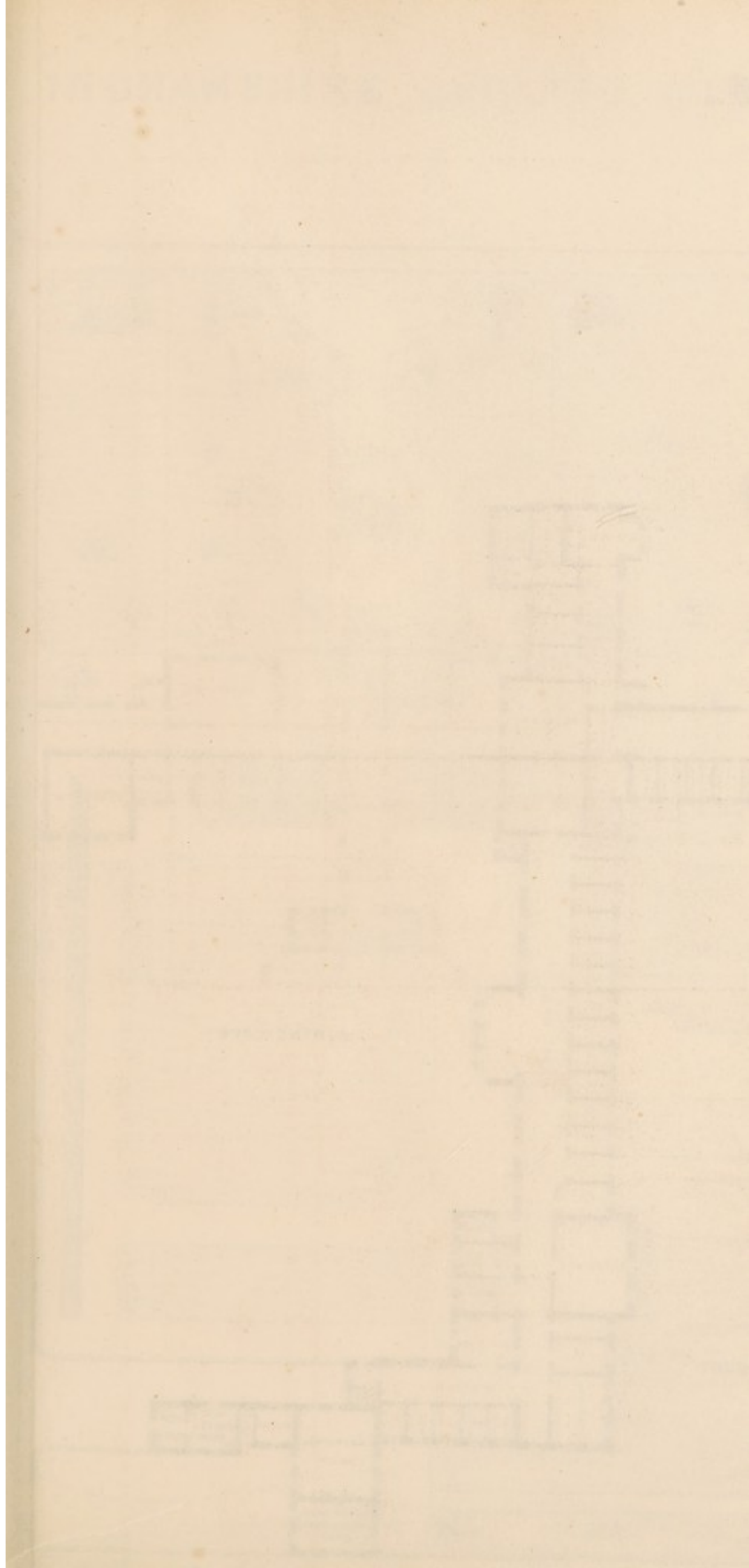

BUCKINGHAMSHIRE LUNATIC ASYLUM.

- A. ATTENDANTS ROOM
- B. BATH ROOM & LAVATORY
- C. WATER CLOSET
- 7.2.24 &c. SINGLE DORMITORIES

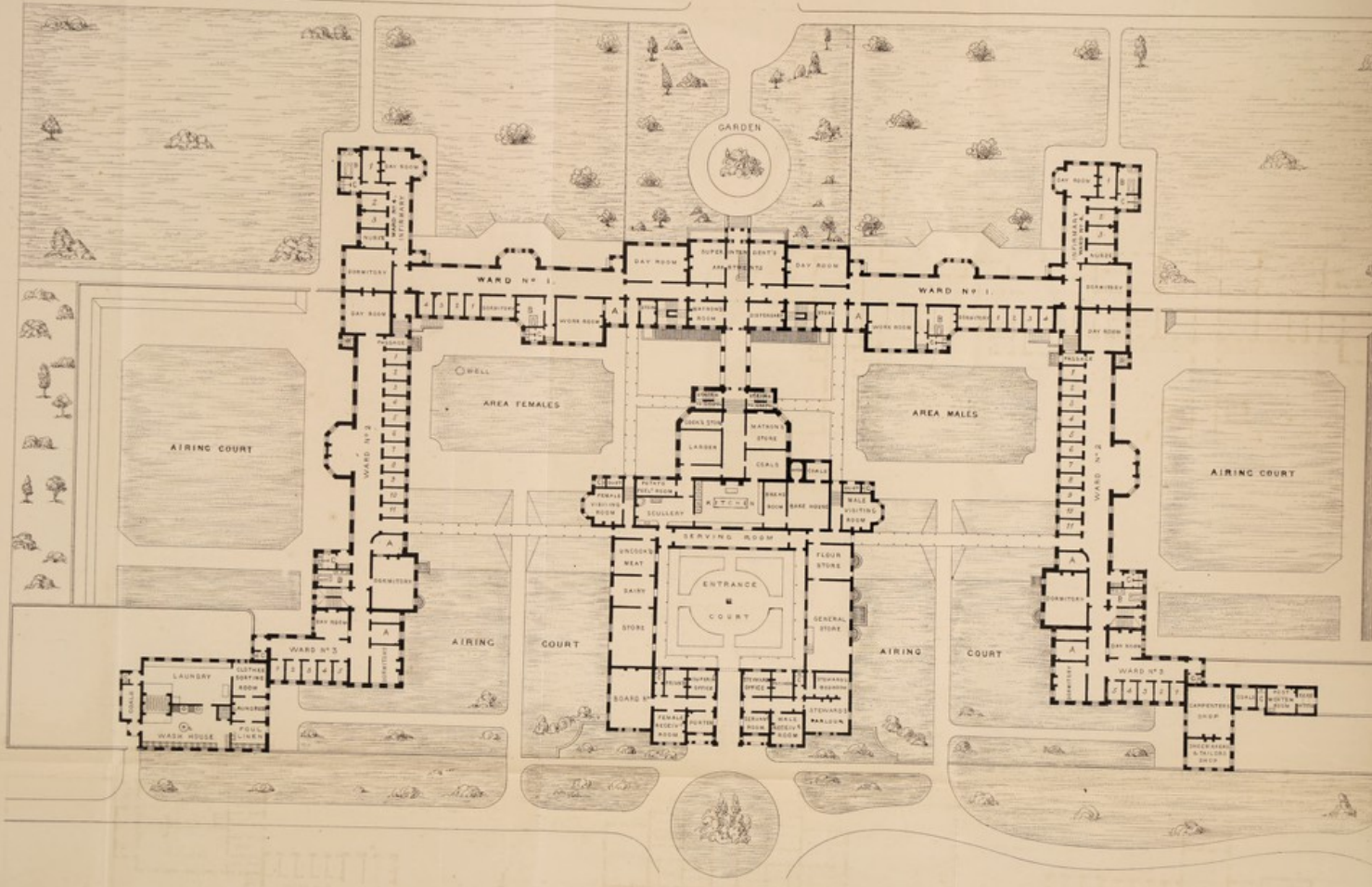

GROUND PLAN.

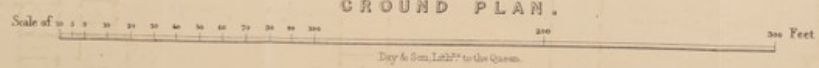

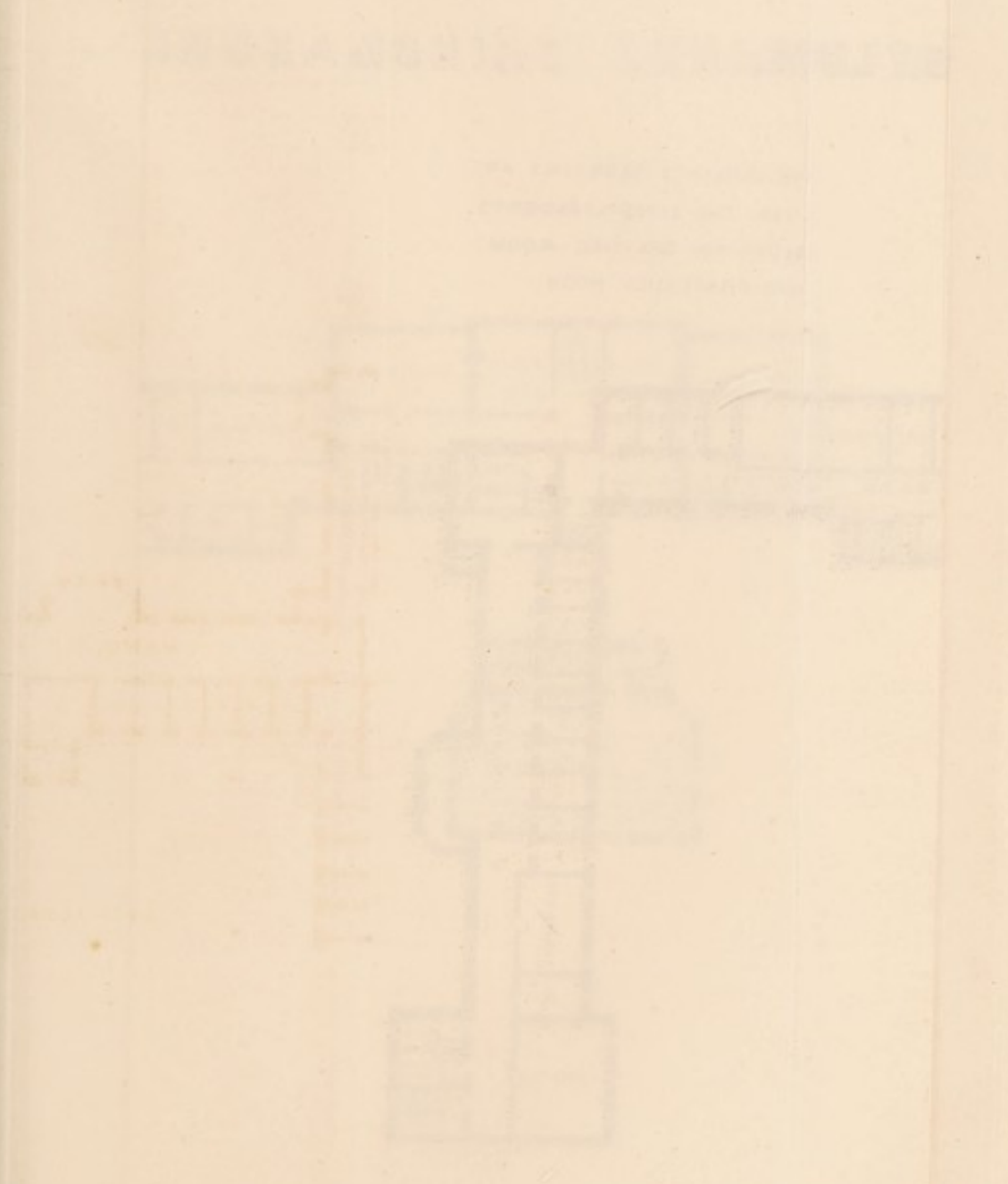

BUCKINGHAMSHIRE LUNATIC ASYLUM.

- A ATTENDANT'S ROOM
- B BATH ROOM & LAVATORY
- C WATER CLOSET
- 1, 2, 3, 4, 5 SINGLE DORMITORIES.

THE SERVANTS' BEDROOMS ARE
OVER THE SUPERINTENDENTS,
BEDROOMS, DRESSING ROOM,
AND CHAPLAIN'S ROOM

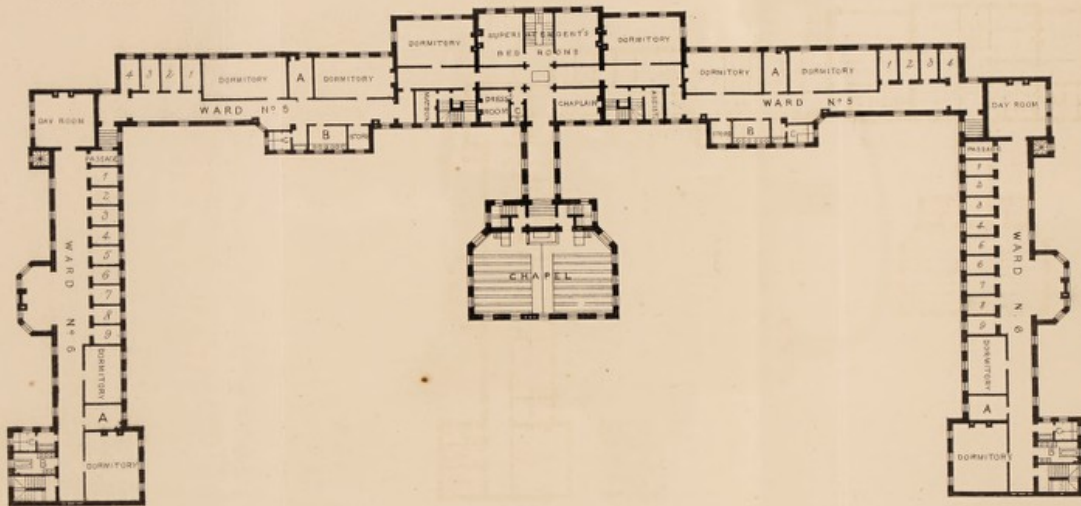

FIRST FLOOR PLAN

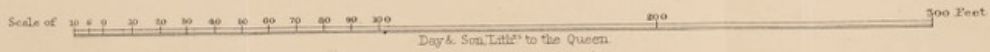

Faint, illegible text at the top left of the page.

Faint, illegible text at the top center of the page.



