

Dannatt, John

Publication/Creation

1906-1906

Persistent URL

<https://wellcomecollection.org/works/bahn6sj7>

License and attribution

You have permission to make copies of this work under a Creative Commons, Attribution, Non-commercial license.

Non-commercial use includes private study, academic research, teaching, and other activities that are not primarily intended for, or directed towards, commercial advantage or private monetary compensation. See the Legal Code for further information.

Image source should be attributed as specified in the full catalogue record. If no source is given the image should be attributed to Wellcome Collection.



Wellcome Collection
183 Euston Road
London NW1 2BE UK
T +44 (0)20 7611 8722
E library@wellcomecollection.org
<https://wellcomecollection.org>

1
Westfield Road.

(401)
Barton-on-Humber.

W. Hull. June 17th

Dear Miss Vigor.

For the past few weeks
the letters from my brother have
been so desponding, I am greatly
troubled. He thinks he is going
the wrong way, & can never be
better. Will you kindly tell me
how he really is, it is so difficult
for me to judge from his letters.

Has S^r Pierce returned? I don't
think it would be wise for Mr
Sammatt to return home yet.

If desirable I might come
over again soon to see him -
Are any further arrangements
made?

Hoping for better news,
with kind regards.

Yours sincerely,

Mary J. Farnie -

Is he too much alone?

Westfield Road.

Barton-on-Humber.

N^o Hull. April 24th 1906.

D^r Pierce.

Dear Sir.

My brother Mr. Dammatt says it is a very long time since he saw any body he knows, I also feel the separation very long -

I should like to know how you think he is progressing, and propose going to Newby, N^o Scarborough on about the 12th May to be near him for a few days if thought advisable.

Yours Sincerely.

Mary J. Farnie -

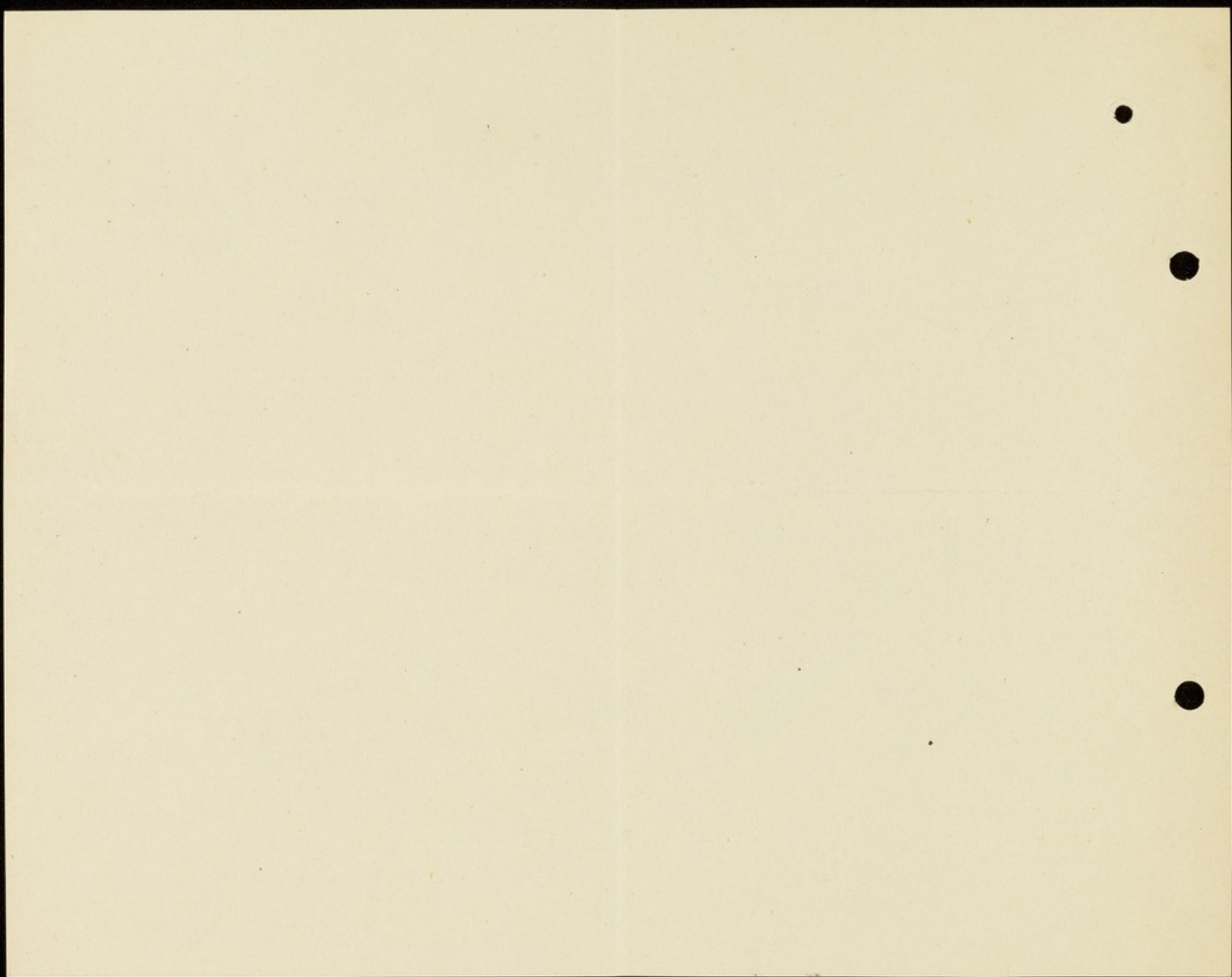

act 18 - up to nine mrs. - corn merchant.
 Sister at 60 married & patient has gone downhill
 Has been taking Veronal gr ix. for months -
 Abundant - very thin - No end. suicidal -

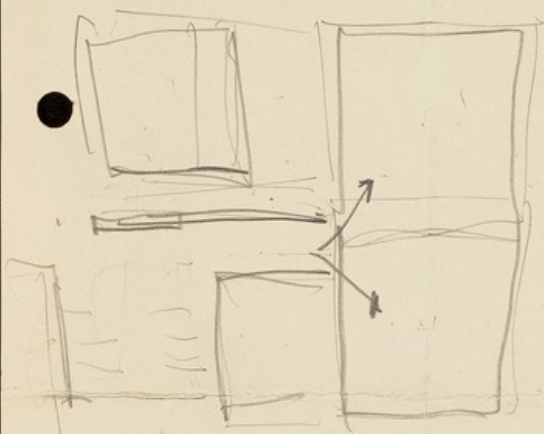

174

Barton on Hunter
 Feb 27/06

Dear Sir,

I was sorry to
 have to write in such a
 hurry. I hope Mr Dammatt
 has now arrived. I gave
 him a supply of the
 medicine he has been taking
 His night Powder is Veronal gr ix
 He has also a Cascara (M &)
 and Milk Vanilla Mixture
 Also a M Sodii Calcium &
 a gr 10 Pepsin Pill

Of course I should be glad
 to wean him of the Veronal
 and other medicines
 but I suppose it might be

Will wait a few days.

About a month ago I detected a thickening which might be in wall of stomach or transverse colon; I think the former. It has not increased during the month and I hope there is no Carcinoma. His sister will explain that if he should get worse they would ~~then~~ wish the Certification to take place at Scarborough instead of sending him home

Yours very truly

W Pierce Thos. S. Morley

Barton in Hunter

Feb 23 / 66

Dear Sir,

My patient is very gloomy about the prospect of his recovery & his trouble may increase as the result. I was half inclined to suggest you should have him a day or two at the Retreat to decide which would suit him best but it occurs to me the best thing would be

for him to go to Scarborough
very shortly before your
weekly visit. I think
it might be well for
his sister & her husband
to spend a night either
at the Hall or in
Scarbro' when they
bring him,

Kindly say
when he should come
& I will try to get him

Yours truly

Thos. S. Mowley

P.S. I was under
the impression the
fuss at York & were
2 guineas & upwards.
Mr. Darnall is not
really well off, as he
is helping me to
support an invalid
(who is nephew to both
of us) & his family.



V.B. 129

N.B.—The Secretary is instructed to obtain the necessary signatures to the accompanying form of guarantee before the care of any patient is undertaken by the Retreat.

YORK RETREAT HOSPITAL FOR THE INSANE.

In consideration of the Directors of the York Retreat Hospital for the Insane agreeing to receive John Dannatt of Harrogate, Btton m
Wetherby as a patient in the said Hospital, I HEREBY UNDERTAKE AND AGREE with Richard Thompson of Dunstable, The Grange, York the Treasurer of the said Hospital, to pay or cause to be paid, to the said Richard Thompson as such Treasurer, or to the Treasurer for the time being of the said Hospital, all such Sum or Sums of Money as shall from time to time be or become due and payable for the Lodging, Maintenance, and care of the said patient in the said Hospital, or whilst under the charge of the Authorities of the said Hospital, and all such Sum or Sums of Money as shall be paid or disbursed by or on behalf of the said Institution for any articles of Wearing Apparel, or other necessities, or extras supplied to, or provided for the said Patient, or the repairing or mending and washing of the articles of Wearing Apparel of the said Patient, so long as the said Patient shall continue in the said Hospital, or be under the charge of the Authorities of the said Hospital, and also to pay or cause to be paid the expenses in respect of the Funeral of the said Patient, in case the said Patient shall die in the said Hospital, or whilst under the charge of the Authorities of the said Hospital. AND I FURTHER AGREE to pay Interest at the rate of five per cent. per annum on any accounts due from me as above, which shall not have been discharged within Twenty-eight days from the receipt of such account from the Treasurer, Secretary, or Clerk of the said Hospital. AND I ALSO UNDERTAKE AND AGREE, at my own expense, to remove the said Patient from the said Hospital within Fourteen days after receiving Notice in writing from the Treasurer, Secretary or Clerk for the time being of the said Hospital, requiring such removal.

WITNESS my hand the 19th day of March 1906

Mr Name Mary J. Carnie
Residence Westfield Road
Occupation Barton-on-Humber

SIGNED by the said Mary J. Carnie
in the presence of

Witness's Signature	} <u>Dr. S. Morley</u>
Address, and	
Profession.	
	<u>Burgess - Barton on Humber</u>
	<u>Doctor of Medicine</u>

N.B.—The charge for Board, Lodging and Medical care is payable quarterly, in advance. Disbursements by the Institution on behalf of patients, and other exceptional expenses, are charged in the following quarter's account. A residence of less than a month is charged as a month.

In the event of the death, removal, or discharge of a patient before the expiry of the quarter covered by the last payment, the surplus amount is returned by the Retreat.

