

**InTouch Hereford & Worcester Ltd : 14 Pierpoint Street, Worcester WR1  
1TA : HIV & AIDS Support Organisation.**

**Contributors**

InTouch Hereford & Worcester

**Publication/Creation**

[between 1990 and 1999?]

**Persistent URL**

<https://wellcomecollection.org/works/fke3t5tq>

**License and attribution**

Conditions of use: it is possible this item is protected by copyright and/or related rights. You are free to use this item in any way that is permitted by the copyright and related rights legislation that applies to your use. For other uses you need to obtain permission from the rights-holder(s).

**wellcome  
collection**

Wellcome Collection  
183 Euston Road  
London NW1 2BE UK  
T +44 (0)20 7611 8722  
E [library@wellcomecollection.org](mailto:library@wellcomecollection.org)  
<https://wellcomecollection.org>

# **INTOUCH**

Hereford & Worcester Ltd

14 Pierpoint Street  
Worcester WR1 1TA



**HIV & AIDS  
SUPPORT ORGANISATION**

## **HIV & AIDS**

## **Support**

## **Organisation**

**TEL: 01905 612002/611656**

**FAX: 01905 611163**

**Email:**

**[intouchhw@breathemail.net](mailto:intouchhw@breathemail.net)**

Reg Charity No: 1053506

# InTouch Hereford & Worcester Ltd

## Who Are We?

We are a support organisation for people living with or affected by HIV, or who are worried that they might have contracted HIV. We cover the counties of Herefordshire and Worcestershire.

Our aim is to provide support and friendship to all, regardless of age, gender, creed, nationality, sexuality or source of infection, and to end isolation and loneliness.

We will discuss any issue or matter of concern to you, and speak to other agencies or groups on your behalf. This maintains your confidentiality whilst allowing you to access services to which you are entitled.

We will not disclose your status without your written permission.

## Services Offered

- ◆ Someone to talk to
- ◆ Pre and post test discussion and referrals
- ◆ Up to date information and leaflets
- ◆ Quarterly newsletter
- ◆ Housing/Rehousing issues
- ◆ Debt counselling
- ◆ Information and advice on safer sex
- ◆ Help with writing letters or completing forms
- ◆ Quarterly talks with guest speakers
- ◆ HIV representative for health services
- ◆ Networking with other organisations
- ◆ Befriending and counselling
- ◆ Video loan
- ◆ Fast tan sunbed
- ◆ Lifts to and from hospital or office

*Is there another service you need? Give us a call – we'll help if we can.*

We have a separate, comfortable room for private discussion.

Our telephone helpline is available from 9.00 am to 4.30 pm Monday to Friday. We will endeavour to help you with any problems you might have, or you can just call in for coffee and a chat.

If you prefer, we will visit you at home or meet you in a place of your choice.

If you have legal problems we will help you contact a solicitor, and find out whether you are entitled to Legal Aid.

We are also happy to host meetings, and can provide tea and coffee and a minute-taking service (subject to availability of an administrator).

Membership of InTouch is available to anyone living with or affected by HIV or AIDS. Any member of the family, or partner or friend of anyone who is HIV positive can contact us in confidence for support and advice.

Everyone's privacy and confidentiality will be respected.

InTouch is open  
Monday to Friday  
from 9.00 am to 4.30 pm

*We recognise that people's needs don't  
conform to office hours, so here are  
some other numbers which you may  
find useful:*

The Foundation	01905 611602
THT Birmingham	0121 694 6440
THT Helpline	0207 242 1010
The Samaritans	0345 909090 (24 hrs)
Positive Support	0121 382 2179
Positive Line	0800 616212
Mainliners	0207 582 5226
National AIDS Helpline	0800 567123 (24 hrs)
Positively Women	0207 713 0222
Friend W Midlands	0121 622 7351
Reach Wolv'mpton	01902 425702
Dudley HIV & AIDS Support Grp	01384 444300
Body Positive	0207 287 8010
Sexual Health	01905 684745/6
GUM Clinic	01905 760154

# We Are Here

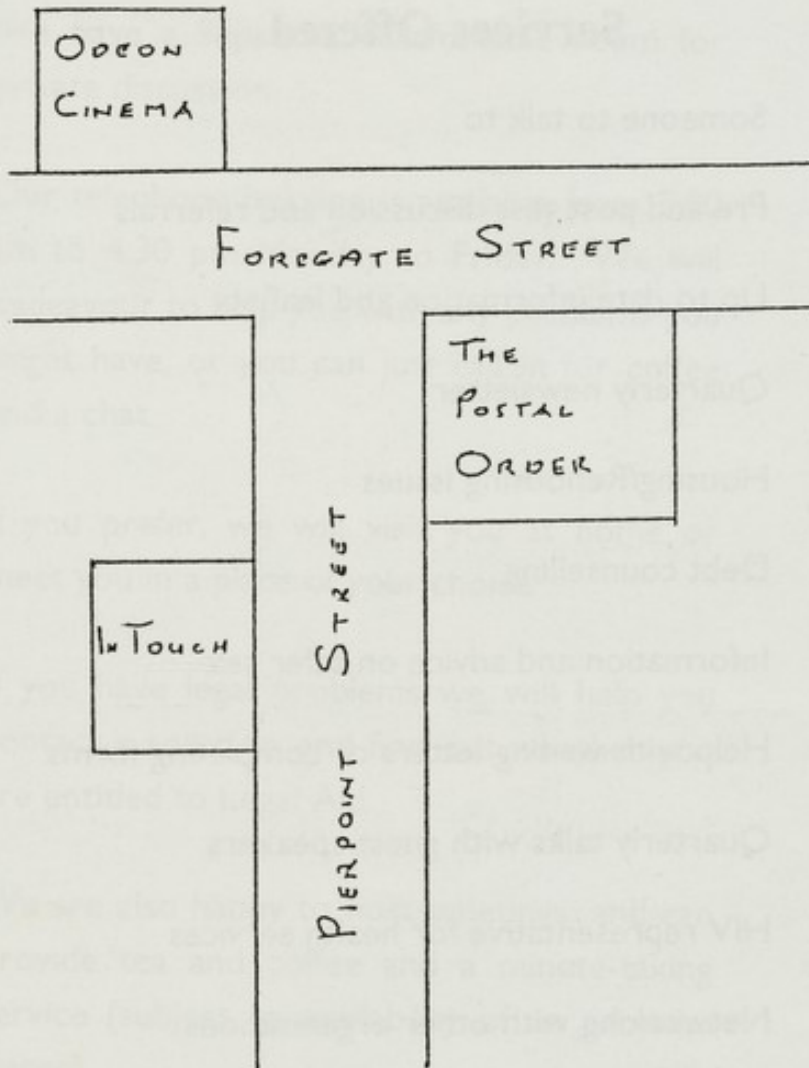

INTOUCH

14 Pierpoint Street

Worcester

WRI ITA

**Call us, or visit. Don't be alone!**