

**54 Wigmore Street**

**Publication/Creation**

1911

**Persistent URL**

<https://wellcomecollection.org/works/qqra7v28>

**License and attribution**

You have permission to make copies of this work under a Creative Commons, Attribution, Non-commercial license.

Non-commercial use includes private study, academic research, teaching, and other activities that are not primarily intended for, or directed towards, commercial advantage or private monetary compensation. See the Legal Code for further information.

Image source should be attributed as specified in the full catalogue record. If no source is given the image should be attributed to Wellcome Collection.



Wellcome Collection  
183 Euston Road  
London NW1 2BE UK  
T +44 (0)20 7611 8722  
E [library@wellcomecollection.org](mailto:library@wellcomecollection.org)  
<https://wellcomecollection.org>

Telephone No 5143 GERRARD.

Metropolitan Borough of St Marylebone.



JAMES WILSON.  
TOWN CLERK.

ED

*Town Hall,  
Marylebone Lane,  
Oxford Street, W.*

14th March, 1911.

Dear Sir,

I am desired by the Works Committee to inform you that they see no objection to your amended application to erect projecting sign at 54, Wigmore Street, in accordance with the altered plan submitted.

Yours faithfully,

*J. Wilson*  
Town Clerk.

Messrs Burroughs, Wellcome & Co.  
Snow Hill Buildings, E.C.

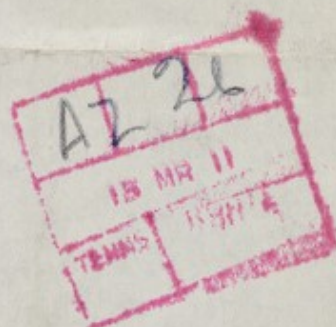

TEL. 5143 GERRARD.



J. PAGET WADDINGTON,  
M. INST. C.E.  
ENGINEER & SURVEYOR.

EGB/AFH

*EGB*

## Borough of St. Marylebone.

ENGINEER & SURVEYOR'S DEPARTMENT.

*The Town Hall, Marylebone, W.*

7th. March 1911

Dear Sirs,

No. 54, Wigmore Street.  
-----

I have to acknowledge the receipt of your letter of the 3rd. instant, accompanied by further plan of proposed projecting sign at above, and in reply to inform you that the amended application shall be submitted to the Works Committee of the Council in due course.

Yours faithfully,

*J. Paget Waddington*

Borough Engineer & Surveyor.

*EGB*

Messrs Burroughs Welcome & Co.,  
Snow Hill Buildings, E.C.





duplicate

Enclosure

G.A.R.

3rd March 1911

Dear Sir,

Re 54 Wigmore Street, W.  
=====

With reference to our application, accompanied by drawings, for permission to erect a projecting sign at the above, we understand that the objection of the Works Committee is owing to the size of the sign in question.

We enclose herewith revised drawing of sign reduced in size, and shall be glad to hear whether or not this will meet the objection raised.

Yours faithfully,

BURROUGHS WELLCOME & CO.,

per

The Borough Engineer and Surveyor,  
Town Hall,  
Marylebone,  
London, W.

WW

DRG NO 36

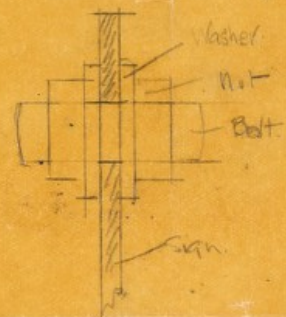
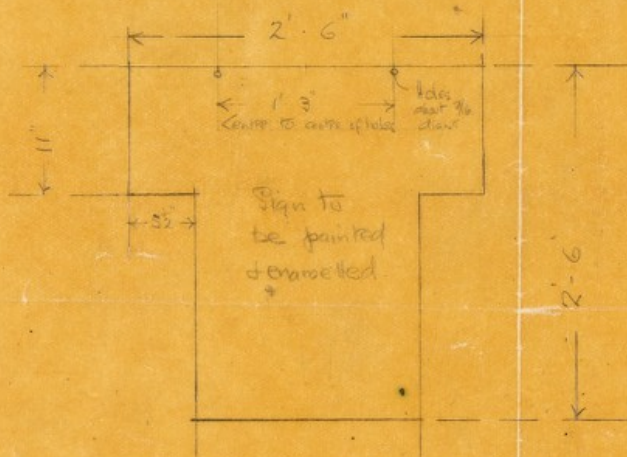

Sketch of Present Fittings

Sketch of New Sign to be fixed to present bolt & fittings

Scale 1" = 1 Foot



JRG 1037

HANGING SIGN 54 WIGMORE ST W.



54  
02-21/1