

Summary of Alterations and Additions to Retreat Premises 1893 - 1895

Publication/Creation

c 1895

Persistent URL

<https://wellcomecollection.org/works/fygyaz3y>

License and attribution

You have permission to make copies of this work under a Creative Commons, Attribution, Non-commercial license.

Non-commercial use includes private study, academic research, teaching, and other activities that are not primarily intended for, or directed towards, commercial advantage or private monetary compensation. See the Legal Code for further information.

Image source should be attributed as specified in the full catalogue record. If no source is given the image should be attributed to Wellcome Collection.



Wellcome Collection
183 Euston Road
London NW1 2BE UK
T +44 (0)20 7611 8722
E library@wellcomecollection.org
<https://wellcomecollection.org>



Engine House

Engine House Extensive additions to the engine-house, including a new engine for the laundry work, a Worthington pump, additions to the electric lighting plant and the covering of all steam pipes with a non-conducting covering. It is expected that these improvements will result in a considerable economy of coal. The engine-house itself has been considerably enlarged and improved.

Report
1893.

The Building - enlarged to nearly twice the original size -
the space occupied by the path between dynamo & pump house roofed in with Kellewell roofing -
The stone steps moved to west end of engine house
The path supported by iron columns & the inside wall of old ~~old~~ house taken out.

Floor tiled. An alternative dynamo bed set in ~~place~~.

Work done by J. Rawling - Cost

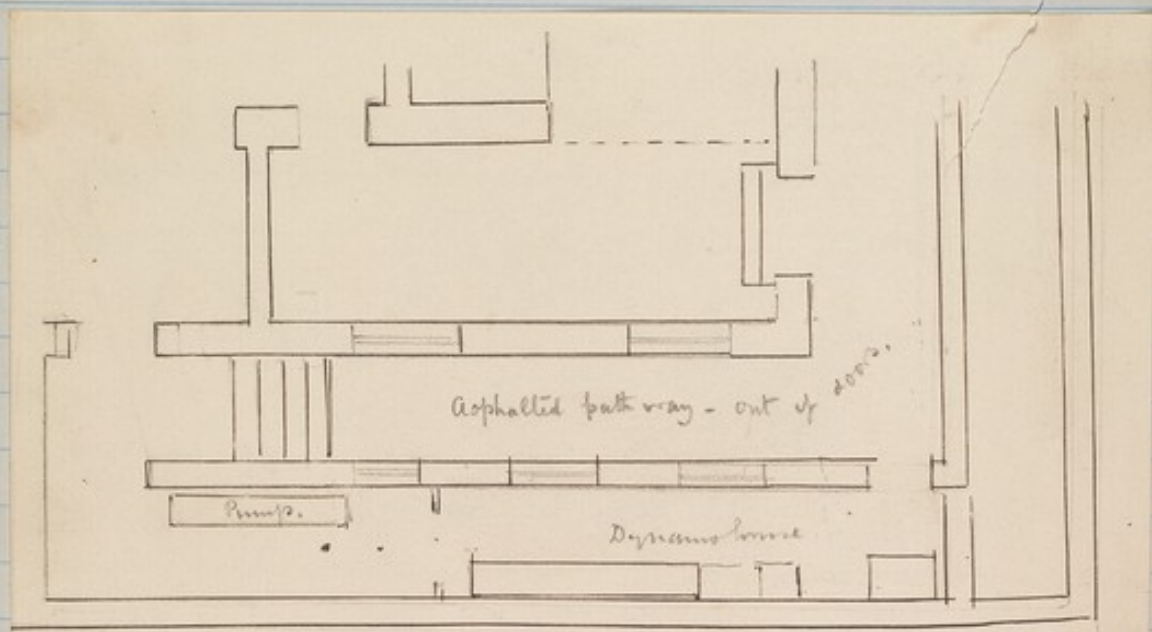

Plan of engine house before alterations —
1892

The Engine - Imdall & Co. Vulcan Ironworks - Hull.

Vertical engine 8 x 12 - Cost £65.

for specifications see Letter Book Feb 4. 1893 p. 346.

Further specifications see p. 371 of same Letter Bk

- (1) Shortening of main steam pipes.
- (2) Steam to be supplied to the kitchen - silent nozzles.
- (3) repair & overhauling of the present steam pump. (not done)
- (4) Rearrangement of Laundry & Mangling room shafting.
- (5) fixing 3" steam pipe from boiler of present horizontal pumping engine to
- (6) Alterations ^{for driving} ~~to~~ of West Villa fan.

Workington pump. Imdall & Co

Connection with rain water tank & Supply boiler

use either new pump or the old one in case of fire & use either rain or town water with the old engine.

Covering steam pipes Stanley 20 Trinity St. Hull.
Cost £28. 15. 0

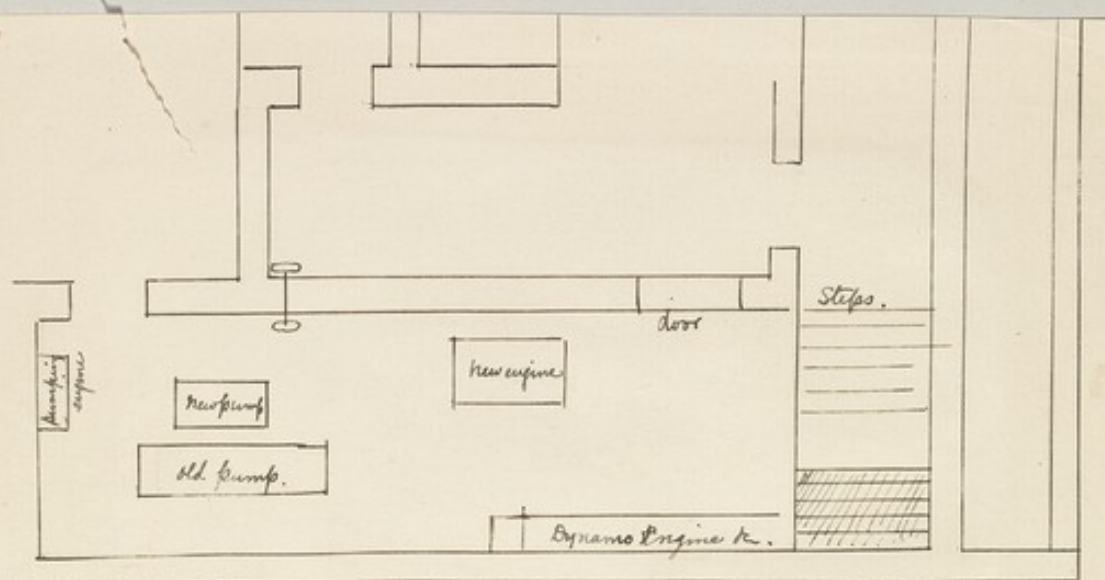

Plan of Engine Room after Alterations

Laundry.

Laundry.

Report
1893.

A new boiler for the laundry has been fitted, and arrangements made to facilitate the sorting of the clothes. The machine shafting has been altered to reduce the noise.

A new slow-combustion stove and boiler have been fitted for the hot water service on the male side of the institution.

- (1) a second boiling apparatus fitted
- (2) Shafting lengthened to drive West Villa gear
- (3) Shafting altered so that long shaft is driven by pulley lost by broken Cog wheels.
- (4) Shafting so arranged that it can at short notice be driven either by new vertical engine or by old pumping engine.

1894

Drying closet heated by steam pipes.

Hot water supply rearranged.
Sorting Cupboards fixed

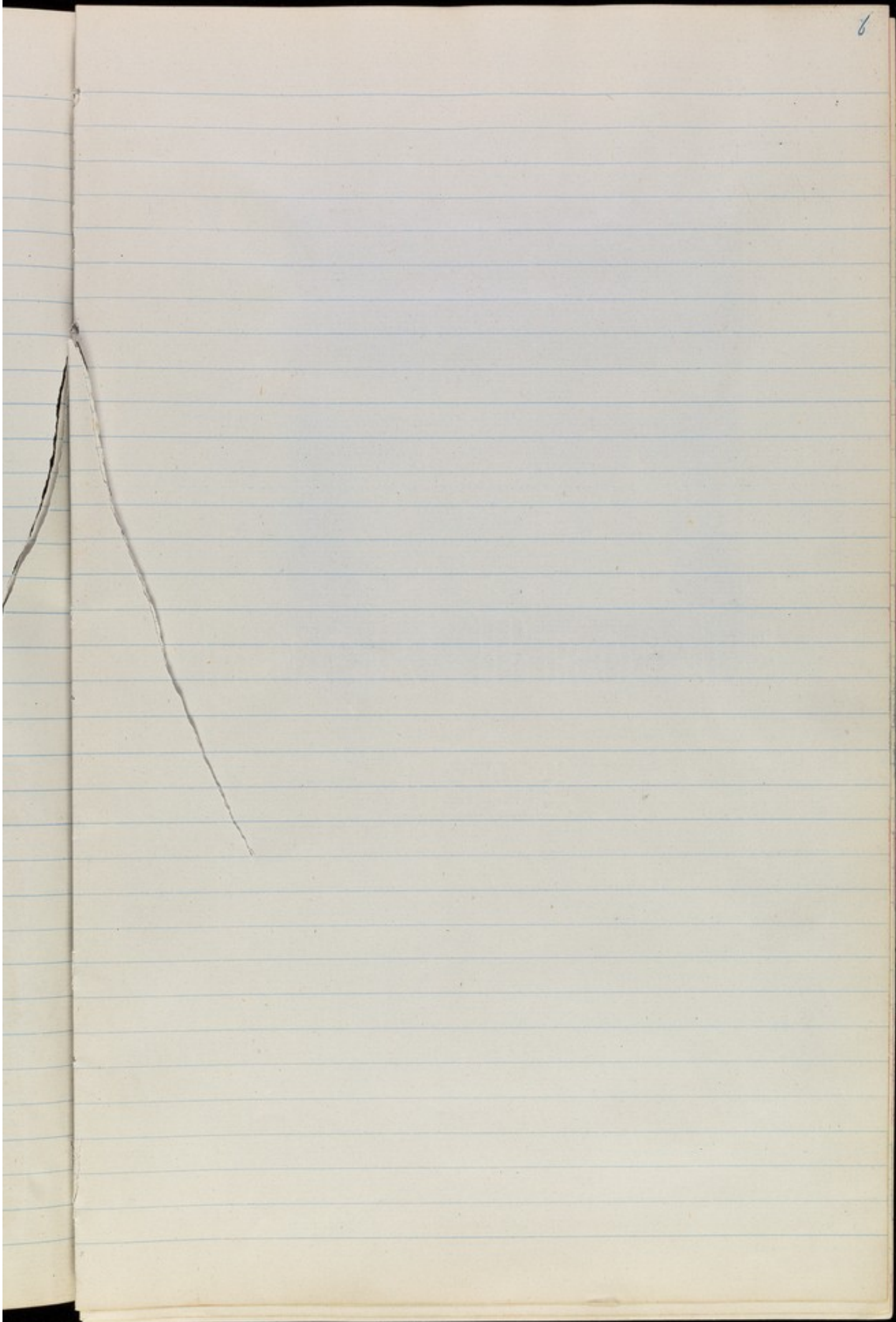

Drainage

Drainage.

Owing to stoppage of the main drain, a careful examination of a section of the drainage on the south side of the west-wing was required. To completely remedy the defects discovered, 150 ft. of this drain were taken up and replaced by new pipes 9 inches in diameter set in concrete. The average depth of this section was about 15 feet. Three new inspection chambers were also built.

Report
1893

Cost £350 - J. Rawling

Review of recent sanitary improvements.

It may be noted that the sanitary arrangements of the Retreat have been entirely re-modelled during the last ten years, on the most modern and improved principles. Within this period six six separate Lavatory Blocks have been erected, the cost of which has been together about £2380; and if to this be added the cost of the main drain that required renewal last year, the expense for sanitary improvements has reached the sum of £2700, exclusive of many minor alterations and the cost of building inspection chambers in various places on the premises. The increased comfort of the patients, apart from the important question of health, has fully justified this large outlay.

Report
1894

- (1) Main drain in Ladies Home garden relaid
- (2) Cast iron drain pipe put under Lodge passage
- (3) H.C. re-managed in Mrs's 3rd Gallery garden & inspection
Chamber built for main drain there
- (4) drain across front entrance Lodge relaid
- (5) new grease trap fixed in Kitchen yard

7
9

1-2

New Lavatory Block. + Centre Lavatory.

Improvements
completed.

New Lavatory
Block.

Report
1894

The important addition to the Fourth and Fifth Galleries of the Lavatory Block, alluded to in the last Report, is now complete. It consists of a three-storied building connected to the main buildings by a neck, through which access is gained from the galleries. Windows on the opposite sides of this neck ensure cross-ventilation. The basement of the block provides a much needed sitting-room for the laundry maids. On each floor there is a bath-room, a separate apartment with hand-basin, and two water-closets. The walls are of glazed brick, and where necessary the flooring is in mosaic. Hot and cold water is abundantly supplied from new tanks, and the apartments are heated with radiators. The additional convenience to the patients occupying this part of the house is very great; and the removal of the old internal water-closets has set at liberty space which has been utilized in providing much needed store-rooms.

Lavatory
in Lodge
Passage.

The Centre Lavatory mentioned in the last Report is now in use. It is constructed of glazed bricks with mosaic floor.

Est. 1892. 663.

New Laundry alterations
New Lavatory Block

Centre Lavatory

Rawling (Builder) 446. 18. 0	112. 1. 9
Bellamy (Woodwork) 239. 2. 1	38. 1. 8
Lindley (Plumber) 234. 5. 9	69. 8. 10
<u>£ 920. 5. 10</u>	<u>219. 12. 3</u>

For drains see plan attached Ordnance Survey
in tin case.

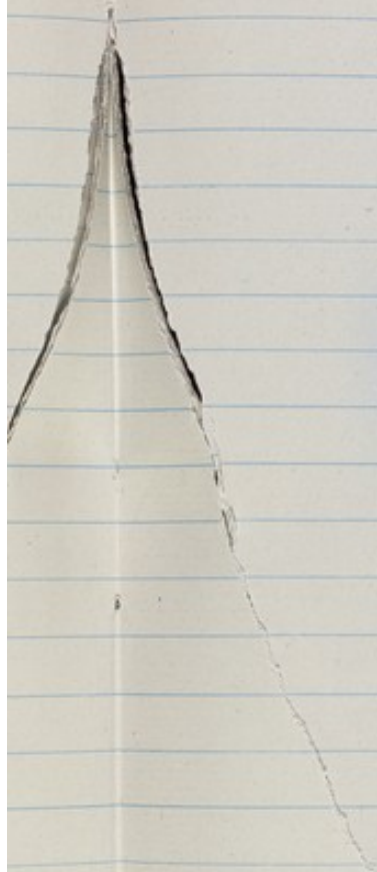

Ladies' Inner Garden. 1894.
J. Beckhouse & Son

- (1) Wall removed
- (2) New paths made
- (3) Levels & gradients altered, new turf.

Cost, as per estimate 62.15.10

Extra work - 10.11.7

Or gravel material 1.5.0

of stone

9.6.7

72.2.5

Hill Garden added to the Ladies' pleasure grounds
rustic steps & Summer houses - (Hughes material)
" seats in various places. Labour - £12

Estate Walk -

Estate Drive.

Report
1893.

The consideration of the Committee has already been given to the continuation of the existing drive round the southern and western boundary of the estate. This would result in opening out the beautiful meadows at the lower part of the grounds and greatly increase the space provided for the patients' exercise and enjoyment. I hope it may not be long before the whole of the meadow land enclosed in the old Retreat boundary may be available for pleasure grounds.

Garden and Grounds.

Report
1894

The Estate-drive alluded to in the last report, was commenced last winter, and the planting of a shrubbery along the west boundary has already become a pleasing feature in the lower meadows. The continuation of this drive, and also the development of the lower meadows in the interests of cricket and golf are now under consideration.

Grounds.

1895.

During the past year considerable improvements have been made in the grounds. The removal of hedges dividing the lower meadows, and the completion of the Estate Walk round the southern boundary has added materially to the usefulness of the grounds as well as to their appearance.

External Alterations.

1. Drying rails removed along meadow
2. Tool shed built at the top of the long meadow
3. Gardeners' earth closet built.
4. Fencing along part of the East Boundary.

Armstrong Addis & Co. Sunderland
 posts & rails 32. 5. 8
 Hughes - fixing 10. 15. 0
£ 43

5. Tennis Lawn lengthened

6. " Asphalted Court recovered.



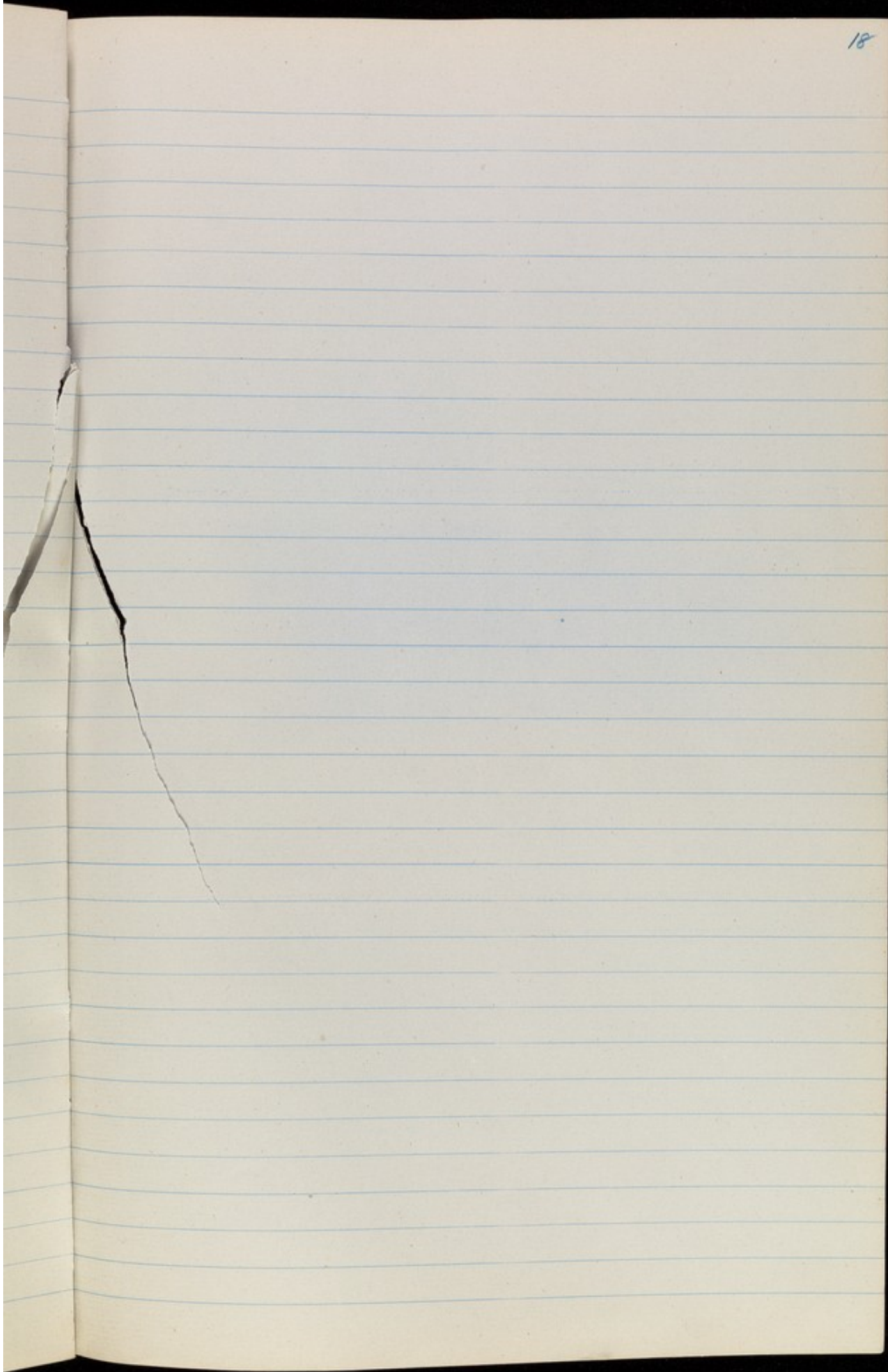

Gainsboro House Scarborough.

Alterations & redecoration 1894. J. J. Carr £68

Basement entirely redecorated
walls painted, grained wood, brushing ceiling

Hall & Stairs

papered, painted, ceiling washed, stair steps painted,
entrance screen painted.

Three rooms on Hall floor, painted, papered, wood varnished

1st Floor

1 Bedroom completely redecorated
1 " partly painted - ceiling washed

Top Floor

1 Bedroom painted & papered
3 " papered & washed

Extras - Bath enamelled - blacking hearths.

Kitchen range - Lathbury £8.15.0



Cricket Ground. 1895.

Report - Work done + cost of same to April 27th

A pitch of 30 yds sq with grade of 15 inches from N to S.
with parallel levels E + W.

grading to meet existing ground E. 10 yds.

W. 20 yds.

N 17 yds. by 40 yds = 680 sq yds.

S.E. Corner 19 yds by 21 yds

= 399 sq yds

That area taken up 5159 sq yds.

The whole has been carefully levelled + thoroughly
beaten with rammers - the turf raised + well
beaten + rolled

Ash + Willow trees stubbed up + cleared away +
ash tree prepared for sale.

Wedge room where not included in above levelled +
beaten down with great lead.

J. Dore

Labour

42. 6. 8

own Staff

5. 15. 0

Mrs Rawlings, horse cart + man

1. 16. 0

Roller

2. 0

50. 4. 8

TABLE MACHINE.

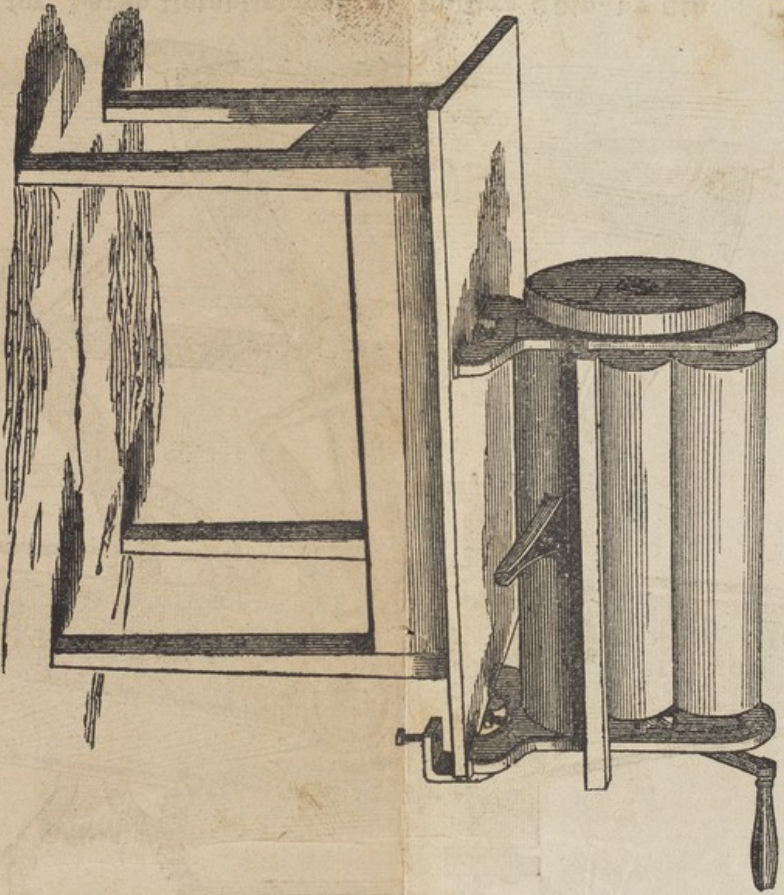

No. 5.

Rollers 2 1/2 in. Long by 5 in. Diameter £1 12 0

Delivered Carriage Free at the nearest Railway Station.

Imp

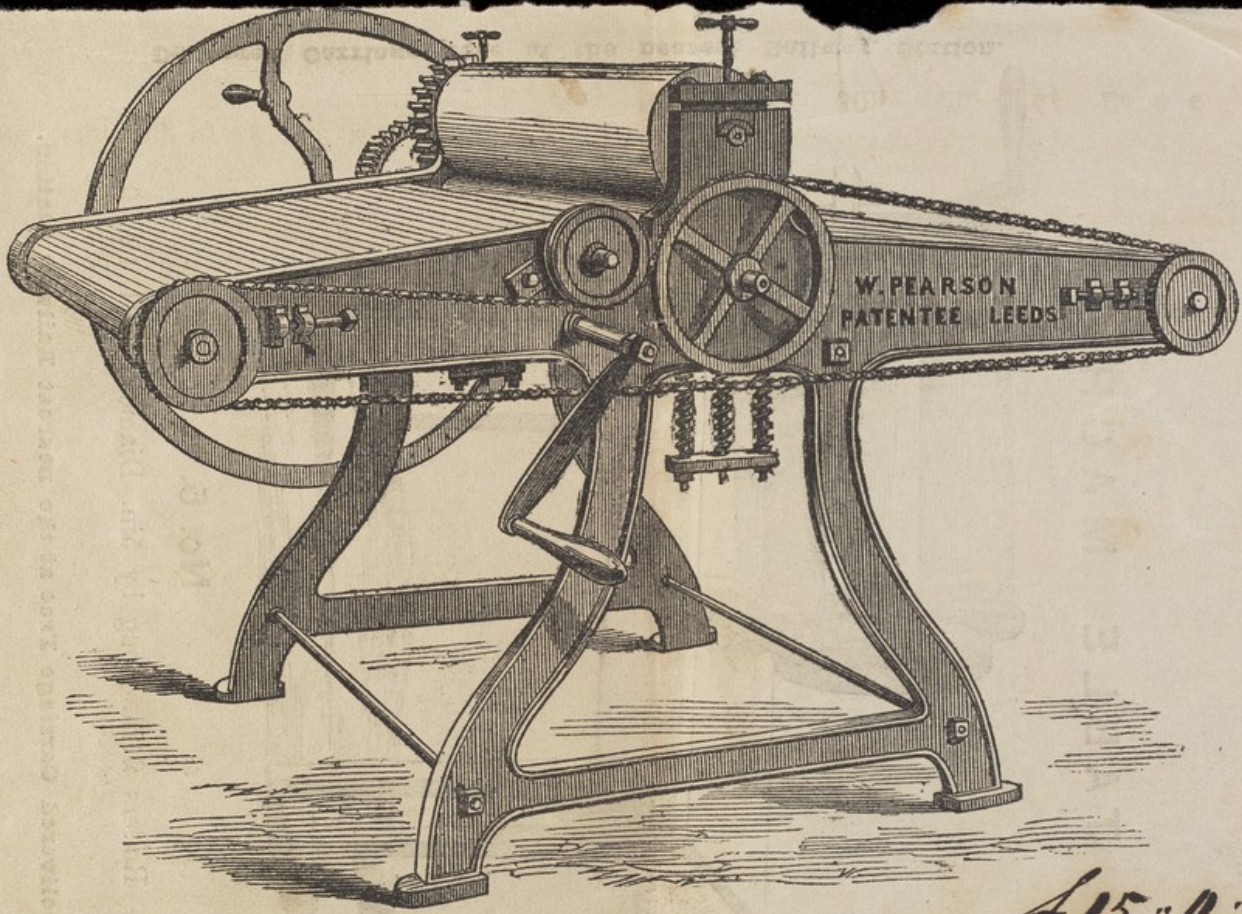

Improved Roller Mangle for Large Establishments; Rollers 36in. by 8in.
with Moveable Feeding and Receiving Tables

£15-0-11

Tracing for Engineers &
Cavalry & Marches.

respecting the loss of
a report to a future
conclusion
he is empowered to produce



Entrance Hall.

1894.

W. Bellerby.

- | | | |
|-----|--|----------|
| (1) | New windows - | 113-10-0 |
| | Window seats made: | |
| (2) | Mahogany handrail | 17-10-0 |
| (3) | Arches over doorways . 4 entrance stairs, & 1 near
Lodge passage | 58-19-6 |
| (4) | Casing & bell wires | 3-18-2 |
| 5. | New Ceiling & Cornice. | |

24

REPORT OF 1895.

Improvements

Main
Staircase
and
Entrance
Hall.

The improvements alluded to in my last report as being in progress have been completed. The small windows on the main staircase have been replaced by larger ones of plate glass, having seats below. The whole staircase has been re-decorated, the arches cased in wood, and a new ceiling and cornice constructed.

West Villa

1894 Alteration of windows (opening) W. Bellamy £6.5.3

Cupboards fixed.

v-1

Centre Sitting Rooms.

1894. N. Room. new ceiling & cornice
paper, paint, fireplace

S. Room. new plate glass windows -

Engineer's Basement

Jan 95 (1) B Doorways cut to form entrance to Bathroom from Basement
Corridor - Floor relaying

" (2) Relaying of floor

Rawling - £5

" (3) Boiler Smithy fire taken down & reset in Engineer's Shop.

Rawling - 7.10.0

Basement.

1895
Report.

Considerable increased accommodation for the storage of coal has been provided near the west basement, where also several of the workshops have been altered to allow one of them to be set apart as a painter's shop. Various improvements have been made in the engineers' shop—a screwing machine purchased, and a boiler re-fixed. These alterations have been made with the view of supplying hot water to the Laundry more efficiently and with greater economy.

Fourth Gallery.

Removing wall of sitting Room - turning arch to form alcove.

Rawling 32.7.6.

Third Gallery.

1. New Windows at ~~end~~^{N+E. side} of Corridor (1/2 plate) - Central window (N.)
to be projected 6 feet bay - basement to correspond.
- 1894 2. Dining Room & Sitting Room re-decorated.
- 1894 3. Main Gallery. - gratings over hot water pipes replaced by sheet iron plates, inlets for ventilation.
floor covered with linoleum
Hair Carpet in 1st & 3rd Galleries.

Stone cupboards fixed.

Report 1895.

The day-rooms in the Third Gallery have been re-decorated, and the heating arrangements for the rooms and corridor altered. It has been decided to extend the improvements in this part of the Retreat, and a small alcove has been built out of the corridor, and the windows have been taken out and replaced by new ones with larger panes. The sleeping rooms in this wing of the Retreat are also being entirely renovated, and the entire re-decoration of the Gallery is in progress.

1895-6. Over doors & frieze mouldings

Belle Vue.

1894 Ken Bathroom & bath -
hot water circulation -

Repairs of fence - effects of sale.

Coal House

June 9th Coal House converted into Meat Larder.

Slate shelves on brick piers. 2 Ventilators - cement

Concrete floor -

Rawling - 16.7.6.

Increased accommodation for coal in Kitchen yard.

Locks

Keys

It having been found very inconvenient to require a large number of different keys in order to enter the various departments of the Retreat which have been built at various times during the past hundred years, it has been decided to renew the locks over a large part of the Retreat premises (excluding the female side, and part of the male side). The new locks will be upon a uniform system, and access to all parts in case of fire or other emergency will be greatly facilitated.

Report
1895.

24

Greenhouses & Forcing Frames.

H. Richardson & Co. Darlington (Dec. 20, 1895.)

3 "Ridge lift" portable plant frames 17ft 6in x 8ft.	L. S. D.
Hot water Heating Apparatus - Jones' Terminal end	41.5.0
Saddle Boilers -	44.0.0

"We have estimated for a wrought welded Jones' patent terminal end Saddle boilers with water way brick flue tubes & with side flues also fitted with 4-4" sockets. The size of the boiler is 5ft long by 21" broad by 21" inside arch, the heating power of which according to the makers' list is 1300 ft actual, that is it will heat this quantity with ease & economy of fuel."

Sludge paper co.

17.2

