

**A guide map to the Museum of History and Technology / United States National Museum, Smithsonian institution.**

**Contributors**

Museum of History and Technology (U.S.)  
Smithsonian Institution.

**Publication/Creation**

Washington. D.C. : Museum of History and Technology, 1967.

**Persistent URL**

<https://wellcomecollection.org/works/zsa2tkn8>

**License and attribution**

Conditions of use: it is possible this item is protected by copyright and/or related rights. You are free to use this item in any way that is permitted by the copyright and related rights legislation that applies to your use. For other uses you need to obtain permission from the rights-holder(s).



Wellcome Collection  
183 Euston Road  
London NW1 2BE UK  
T +44 (0)20 7611 8722  
E [library@wellcomecollection.org](mailto:library@wellcomecollection.org)  
<https://wellcomecollection.org>

**A  
Guide  
Map  
to  
the**

# **Museum of History and Technology**



**UNITED STATES  
NATIONAL MUSEUM**

**SMITHSONIAN  
INSTITUTION**

# first floor

Civil Engineering (tunnels and bridges)  
 Electricity  
 Farm Machinery  
 Foucault Pendulum  
 Hand and Machine Tools  
 Health  
 Iron and Steel  
 Medical Sciences  
 Nuclear Energy  
 Petroleum  
 Physical Sciences  
 Power Machinery  
 Railroads  
 Textiles  
 Timekeeping, Typewriters, Phonographs, Locks  
 Vehicles  
 Watercraft

☒ Elevator  
 \* Rest Room

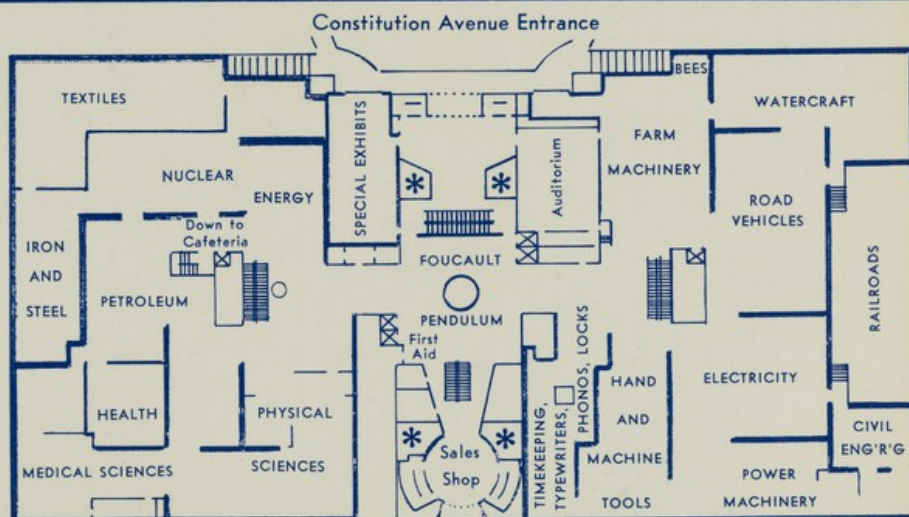

## second floor

*American Costume*  
*Everyday Life in the American Past*  
*First Ladies Gowns*  
*George Washington Statue*  
*Growth of the United States*  
*Historic Americans*  
*Life in the American Past*  
*Star-Spangled Banner*

☒ Elevator  
 \* Rest Room

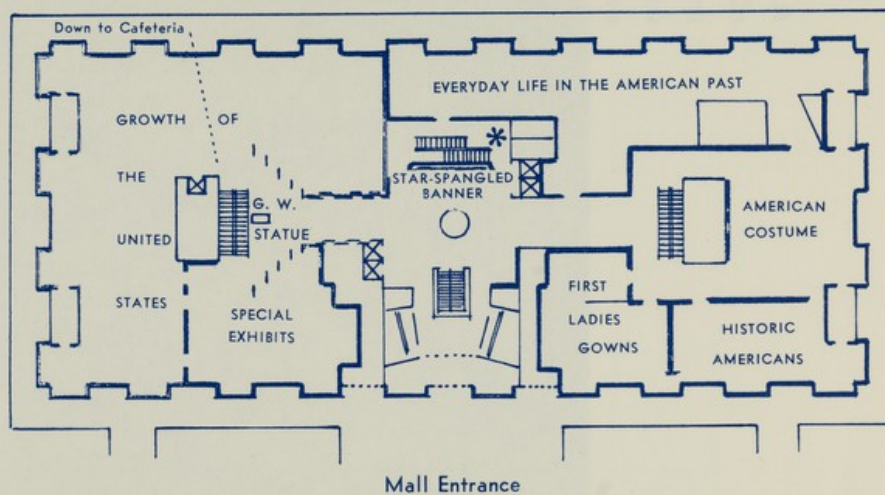

## third floor

*Armed Forces*  
*Ceramics*  
*Coins, Medals, Monetary History*  
*Continental Gunboat Philadelphia*  
*Glass*  
*Graphic Arts*  
*Musical Instruments*  
*Orders, Medals, Decorations*  
*Photography*  
*Stamps and Postal History*  
*Underwater Exploration*

 Elevator  
 Rest Room

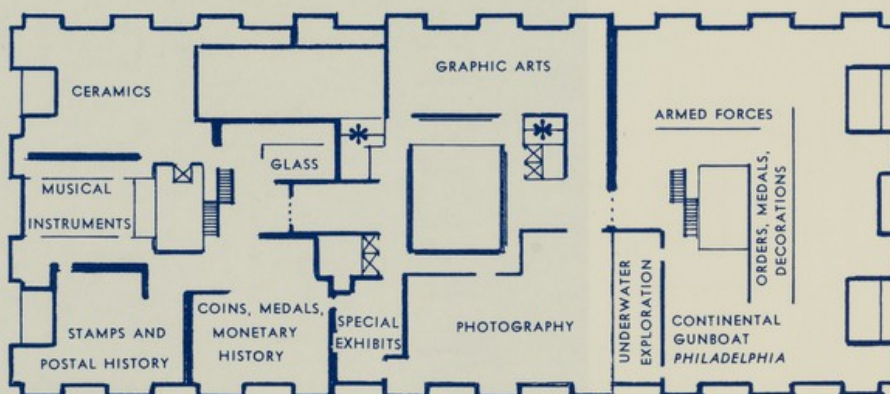

Telephones, information, checkrooms, and sales shops are located at each entrance.

GPO : 1967 O - 256-692



## THE SMITHSONIAN INSTITUTION

The Smithsonian Institution was founded in 1846 through the bequest of an English scientist, James Smithson (1765-1829), who left his fortune to the United States "to found at Washington, under the name of the Smithsonian Institution, an Establishment for the increase and diffusion of knowledge among men."

One of the oldest American scientific and cultural institutions, the Smithsonian is governed by a Board of Regents composed of the Vice President of the United States, the Chief Justice, three Senators, three Representatives, and six private citizens. The chief administrative officer is the Secretary of the Smithsonian Institution.

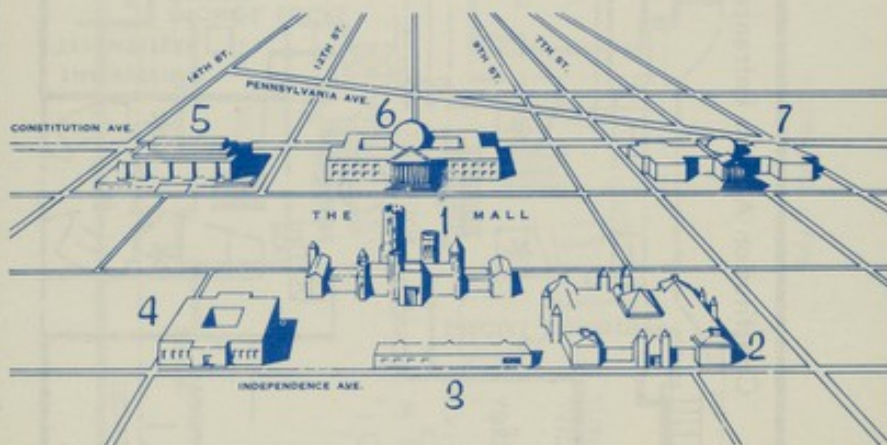

1. Original Smithsonian Building
- \*2. Arts and Industries Building (also houses National Air Museum exhibits)
- \*3. Air and Space Building
4. Freer Gallery of Art
- \*5. Museum of History and Technology
- \*6. Museum of Natural History (also houses National Collection of Fine Arts)
- \*7. National Gallery of Art

°Open until 10 p.m. April through August

The Smithsonian administers thirteen Government organizations.

United States National Museum  
Museum of Natural History  
Museum of History and Technology  
International Exchange Service  
Astrophysical Observatory  
National Zoological Park  
Radiation Biology Laboratory  
National Collection of Fine Arts  
Freer Gallery of Art  
National Gallery of Art°  
Canal Zone Biological Area  
National Air and Space Museum  
John F. Kennedy Center for the Performing Arts°  
National Portrait Gallery  
Science Information Exchange

°Under separate Boards of Trustees.

### MUSEUM HOURS

Museums open daily 9 a.m. to 4:30 p.m.  
Closed Christmas Day.

Telephones, information, checkrooms,  
and sales shops are located at each entrance.

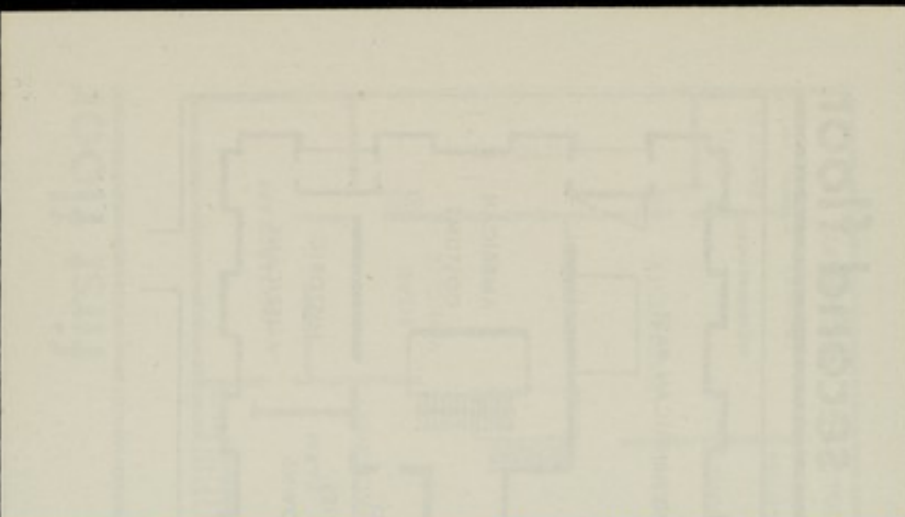

This building houses exhibits illustrating the cultural and technological development of our Nation from colonial times to the present. Significant treasures of our Nation's history—civil and military—as well as famous inventions and machines from practically every field of technology are on display. Permanent exhibits include such other subjects as stamps, coins, graphic arts, and some of the decorative arts.

The vast collections under the care of the Museum of History and Technology form one part of the United States National Museum. The other part is the Museum of Natural History, which displays collections in the field of anthropology, geology, and zoology.

The exhibits in the Museum of History and Technology are located on the first, second, and third floors. On the basement level are a cafeteria and snack counter. Lunch is served, September through March, 11 a.m. to 2 p.m., and lunch and dinner are served from April through August. The snack counter is open from 9 a.m. to 4 p.m., September through March, and until 9:30 p.m. during the rest of the year.

Join the Smithsonian through its  
Society of Associates

*The Society was founded in September 1965 to provide members with a greater knowledge of the Smithsonian and its far-reaching activities. The Society promotes general participation in the life of a great museum.*

*The Smithsonian receives substantial support from Congress for its public museum programs, but many of its activities, including the Society of Associates, are entirely dependent on contributions from individuals, foundations, and public-spirited corporations.*

*For additional information write to:  
The Executive Secretary, Smithsonian  
Society of Associates, Smithsonian In-  
stitution, Washington, D.C. 20560.*